

Volver, breath of new *light*.

design Studio 14
terzani.com

TERZANI
LA LUCE PENSATA



Product Name

Volver
small linear chandelier

Materials

brass chains | metal
structure plated as below



Finishes | Code

-  nickel
OL63S E7 C8
-  black nickel
OL63S E9 C8
-  bronze
OL63S F7 C8
-  gold plated
OL63S L6 C8

Body

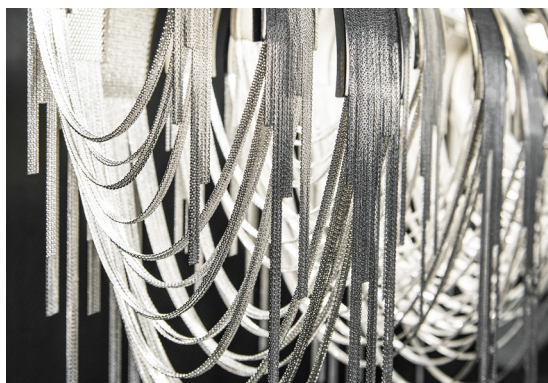
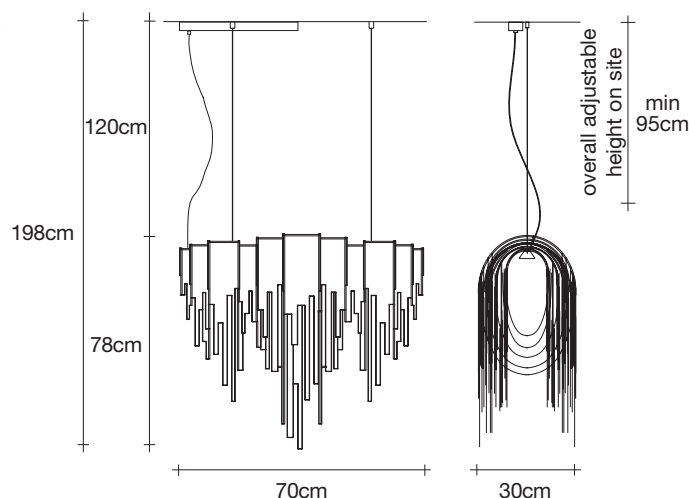

Light source

100-240V ~ 50/60Hz



Built in Replaceable LED Module
7 x 4,5W 4632 lm CRI 90 3000K
or optional 4200 lm 2700K

dimmmable options



0-10V
PWM
PUSH
DALI

Canopy

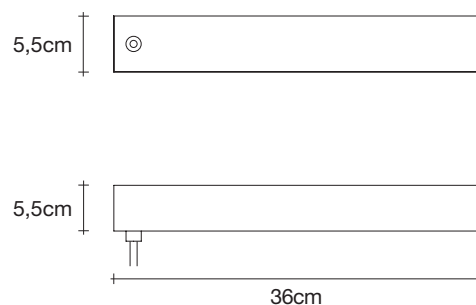

Canopy for DALI

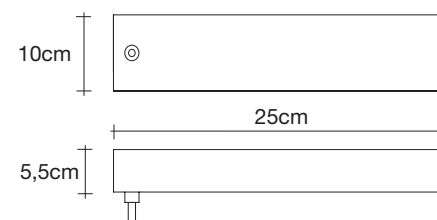

Designer Diego Bassetti and Architect Andrea Panzieri of Studio 14, protégés of Bruno Rainaldi, applied their multidisciplinary approach to create Terzani's first LED suspension light. This geometric design combines thin nickel chains with the latest in LED technology to create a light that is both elegant and modern. A breath of new light, Volver melds technology and art to achieve a new level of luxury.

Volver, breath of new *light*.

design Studio 14
terzani.com

TERZANI
LA LUCE PENSATA



Product Name
Volver
medium linear chandelier

Materials
brass chains | metal
structure plated as below



Finishes | Code

-  nickel
OL60S E7 C8
-  black nickel
OL60S E9 C8
-  bronze
OL60S F7 C8
-  gold plated
OL60S L6 C8

198cm

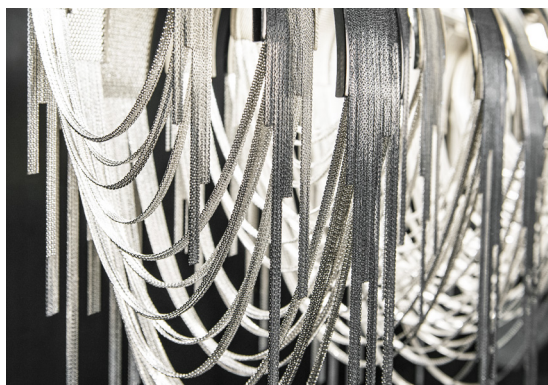
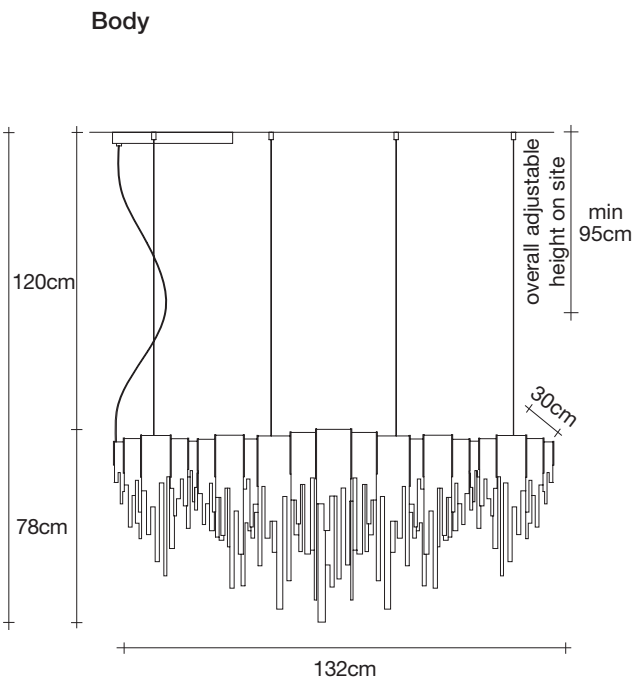

Light source
230-240V ~ 50/60Hz

 Built in Replaceable LED Module
10 x 4,5W 6617 lm CRI 90 3000K
or optional 6000 lm 2700K

dimming options

 0-10V
PUSH
DALI

Canopy

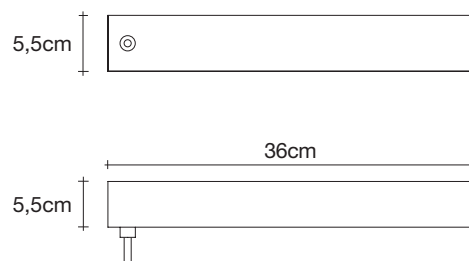

Canopy for DALI

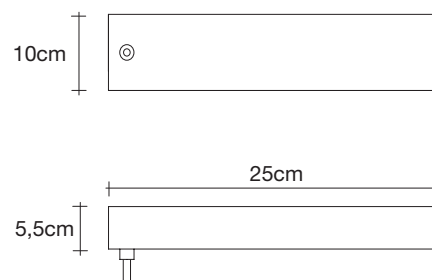

Designer Diego Bassetti and Architect Andrea Panzieri of Studio 14, protégés of Bruno Rainaldi, applied their multidisciplinary approach to create Terzani's first LED suspension light. This geometric design combines thin nickel chains with the latest in LED technology to create a light that is both elegant and modern. A breath of new light, Volver melds technology and art to achieve a new level of luxury.

Volver, breath of new *light*.

design Studio 14
terzani.com

TERZANI
LA LUCE PENSATA



Product Name

Volver
large linear chandelier

Materials

brass chains | metal
structure plated as below



Finishes | Code

-  nickel
OL62S E7 C8
-  black nickel
OL62S E9 C8
-  bronze
OL62S F7 C8
-  gold plated
OL62S L6 C8

Body

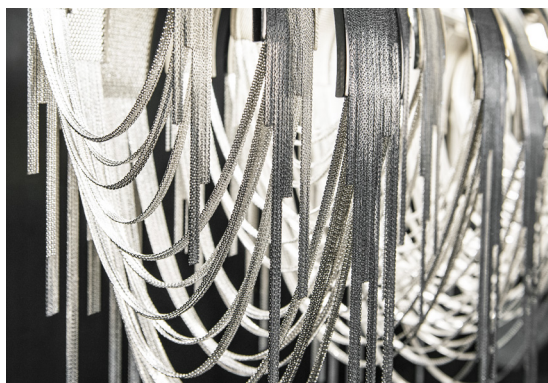
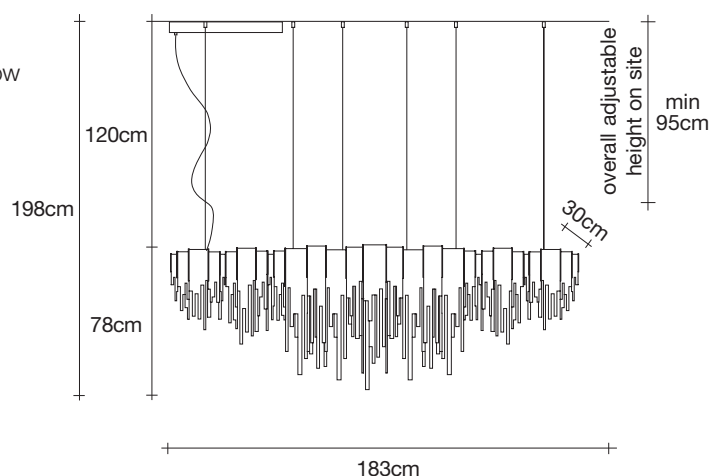

Light source

230-240V ~ 50/60Hz



Built in Replaceable LED Module
20 x 4,5W 13243 lm CRI 90 3000K
or optional 12000 lm 2700K

dimming options



0-10V
PUSH
DALI

Canopy

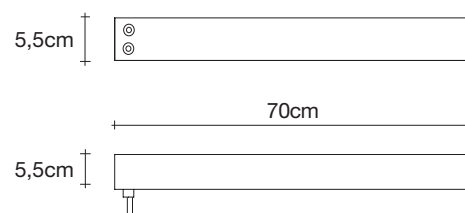

Canopy for DALI

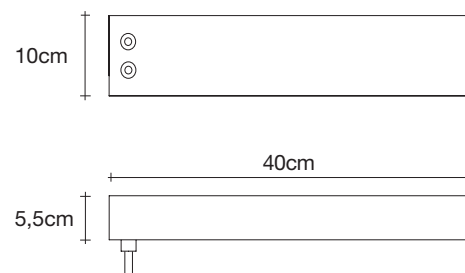

Designer Diego Bassetti and Architect Andrea Panzieri of Studio 14, protégés of Bruno Rainaldi, applied their multidisciplinary approach to create Terzani's first LED suspension light. This geometric design combines thin nickel chains with the latest in LED technology to create a light that is both elegant and modern. A breath of new light, Volver melds technology and art to achieve a new level of luxury.



kg 45



kg 95



199 x 55 x 99 cm

Volver, breath of new *light*.

design Studio 14
terzani.com

TERZANI
LA LUCE PENSATA



Product Name

Volver
round chandelier

Materials

brass chains | metal
structure plated as below



Finishes | Code

-  nickel
OL61S E7 C8
-  black nickel
OL61S E9 C8
-  bronze
OL61S F7 C8
-  gold plated
OL61S L6 C8

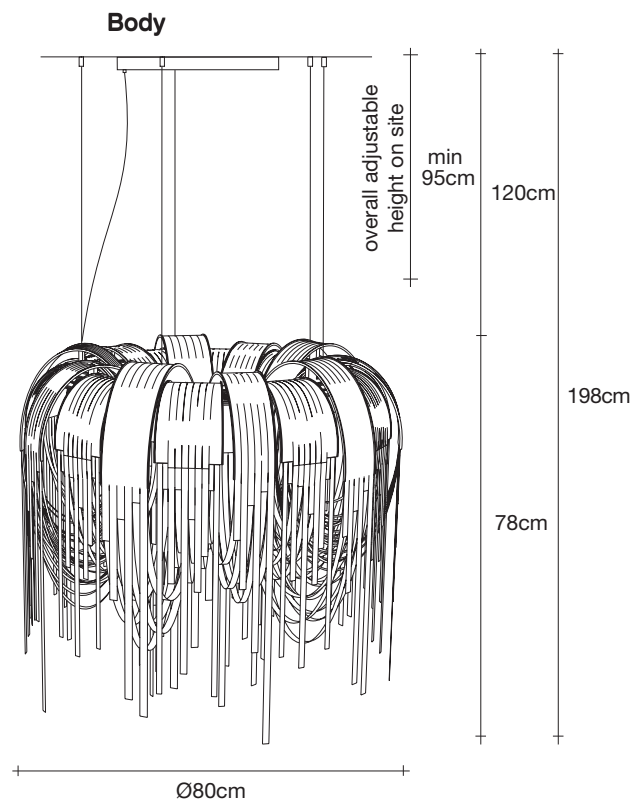

Light source

230-240V ~ 50/60Hz



Built in Replaceable LED Module
10 x 4,5W 6617 lm CRI 90 3000K
or optional 6000 lm 2700K

dimming options



0-10V
PUSH
DALI

Canopy

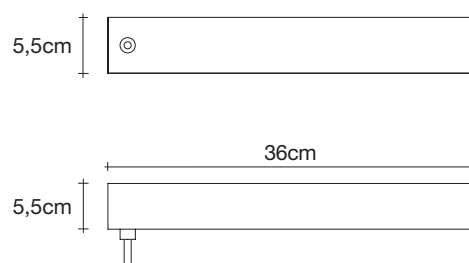

Canopy for DALI

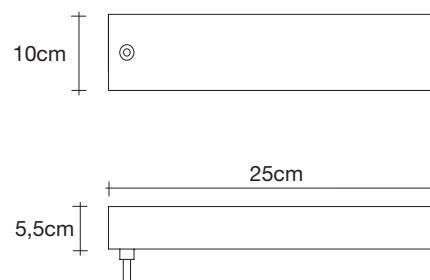

Designer Diego Bassetti and Architect Andrea Panzieri of Studio 14, protégés of Bruno Rainaldi, applied their multidisciplinary approach to create Terzani's first LED suspension light. This geometric design combines thin nickel chains with the latest in LED technology to create a light that is both elegant and modern. A breath of new light, Volver melds technology and art to achieve a new level of luxury.