

Mizu, flowing light.

design Nicolas Terzani
terzani.com

TERZANI
LA LUCE PENSATA



Name
Mizu
pendant light

Materials
crystal

CE ENEC CB

Finishes | Code

-  clear
OR01S H4 A9
-  champagne
OR01S E8 H1
-  cognac
OR01S E8 H4
-  silver dust
OR01S H4 F4
-  gold
OR01S E8 A4

Body

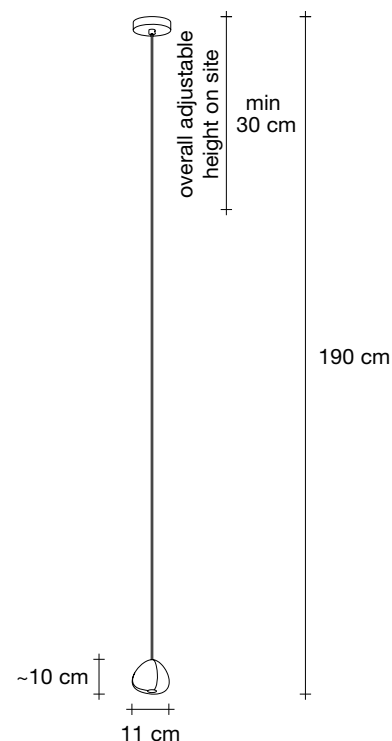

Light source options

230-240V ~ 50/60Hz

 HALOGEN
10W G4 12V

or

 LED
2W G4 12V
3W G4 12V

or

 Built in Replaceable LED Module
1,5W 146 lm 3000K
or optional 129 lm 2700K

dimming options

 not dimmable

 IGBT
TRIAC
DALI

Canopy | white or brushed nickel plated

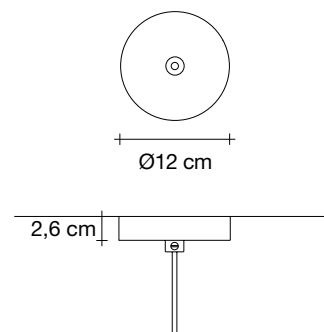

Canopy for DALI | white or brushed nickel plated *

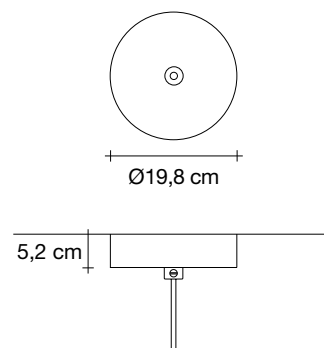

Inspired by the tranquil and mesmerizing light refractions created by water, Mizu is a customizable pendant light from Terzani. Like water droplets, no two Mizu are alike; each crystal shape is unique and meticulously handmade. Using only the clearest crystal, Mizu perfectly emulates water's refraction of light, casting amazing patterns around the room, reminiscent of flowing water. Available in clear, silver dust, gold, cognac, and champagne finish. Design Nicolas Terzani.