

Atlantis, a precious *wave*.

design Barlas Baylar
terzani.com

TERZANI
LA LUCE PENSATA



Name
Atlantis
large linear chandelier

Materials
brass chains | metal
structure plated as below



Finishes | Code

-  nickel plated
0A16SE7C8
-  black nickel plated
0A16SE9C8
-  brushed bronze
0A16SF7C8
-  gold plated
0A16SL6C8
-  champagne plated
0A16SN1C8
-  brushed champagne plated
0A16SN7C8

Body

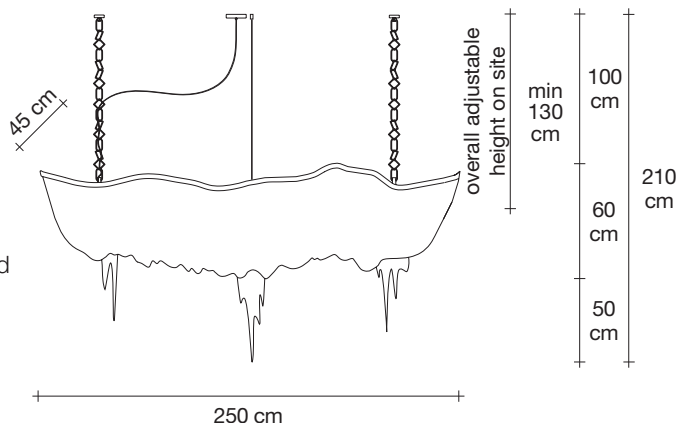

Light source
220-240V ~ 50/60Hz

 led
10 x 6W E14 dimmable

dimmable options

 all systems

Canopy

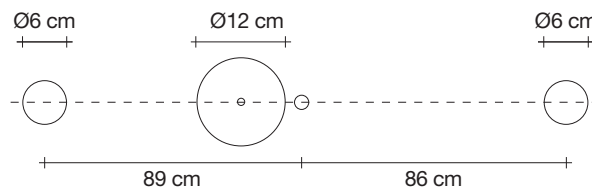

Seemingly alive, Atlantis' shimmering light creates a vibrant source of energy. Its mesmerizing, organic effect is created by hundreds of illuminated lengths of draped chains. Like water in the ocean, Atlantis's chains appear liquid, cascading over its gloss bands and falling down towards the abyss before turning back into itself. Atlantis is composed of almost three miles of chain, meticulously hand-crafted by master Italian artisans. Design Barlas Baylar.

