

**TERZANI**  
LA LUCE PENSATA

**Mizu** 26 round multi light pendant  
**0R26S-FT**

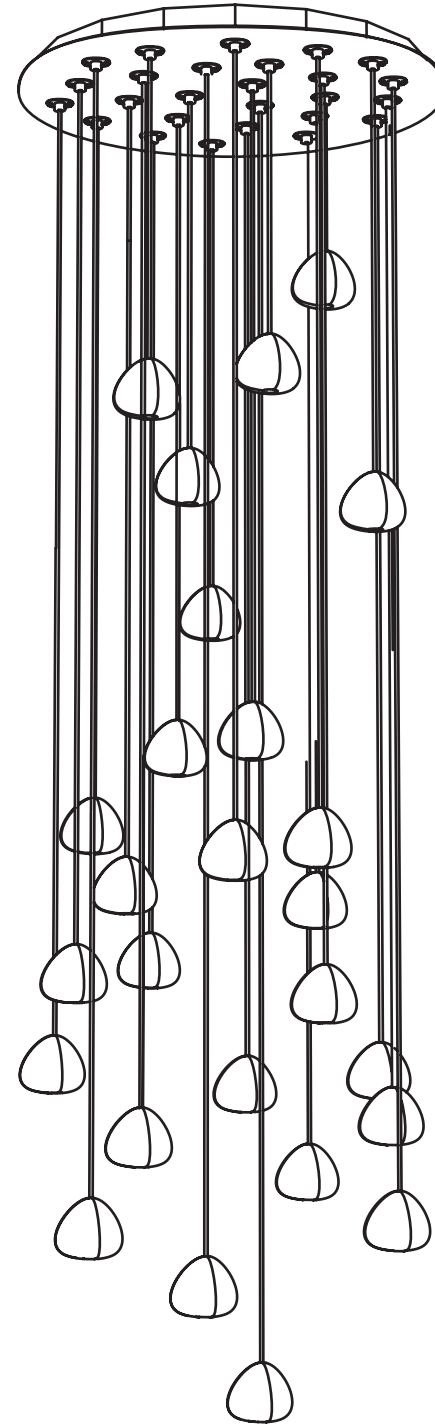

Design Nicolas Terzani

**TERZANI**  
LA LUCE PENSATA

**MIZU**

**CODE 0R26S -- FT**

**230-240V ~ 50/60Hz MAX 260W**

**26xMAX 10W G4 12V** 

**Halogen**

or

**26xMAX 2W G4 12Vac**   
**LED**

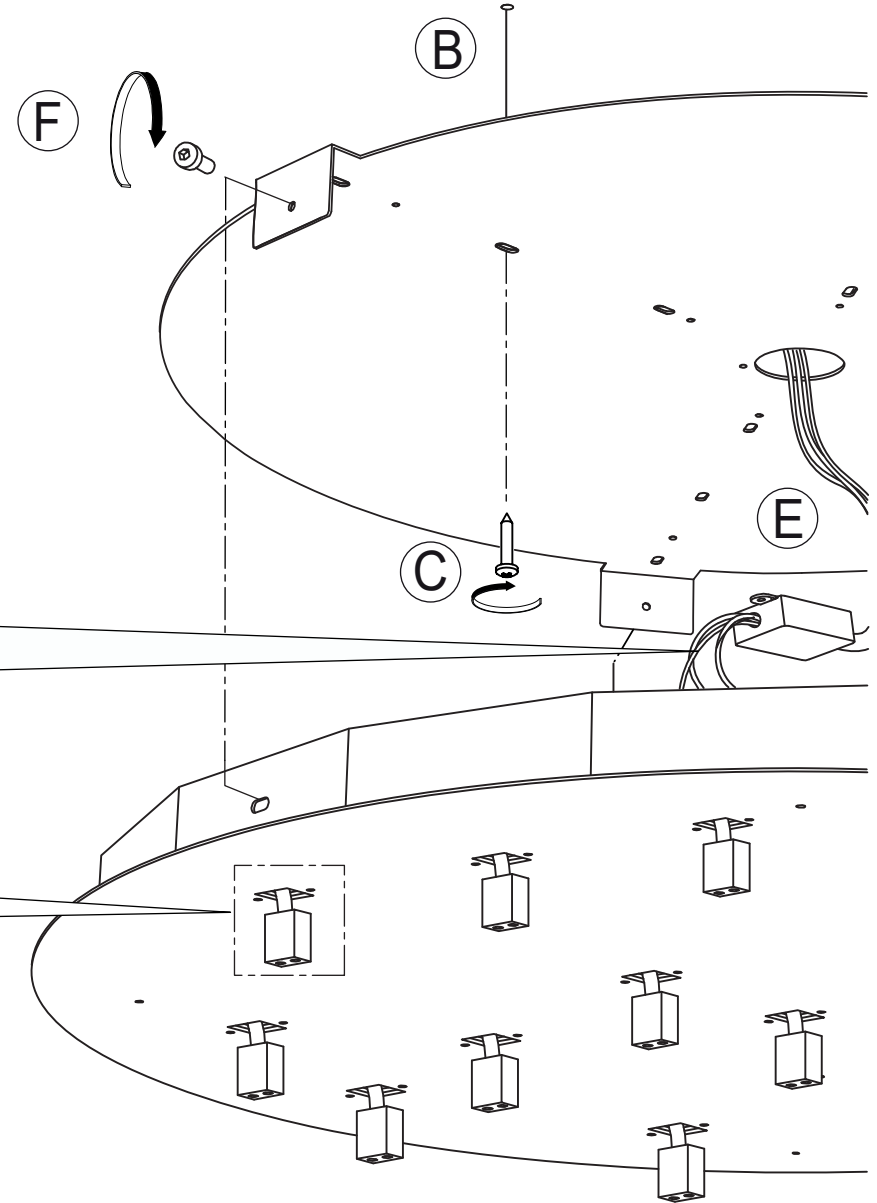
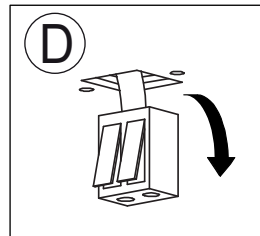
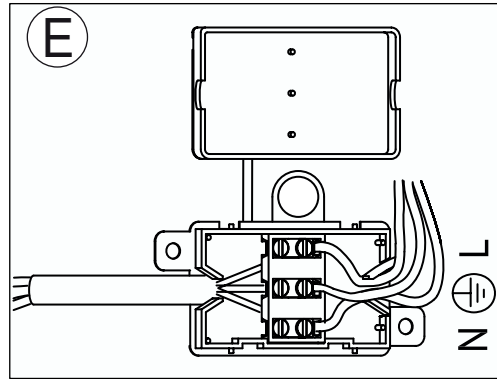
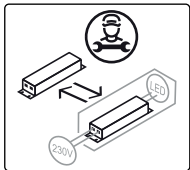

**CAUTION!**  
**IT** questo prodotto non è compatibile con le lampadine LED G4 12V a marchio Beghelli

**UK** this product is not compatible with Beghelli branded G4 12V LED bulbs

**FR** cet produit n'est pas compatible avec les ampoules LED G4 12V marquée Beghelli

**DE** Das Produkt ist nicht kompatibel mit LED G4 12V Leuchtmittel Beghelli

**RU** Это изделие не совместимо со светодиодными лампами LED Beghelli G4 12V

عربي  
هذا المنتج لا يتوافق مع مصابيح ليد LED G4 12V من نوع بيغيلي Beghelli

**TERZANI**  
LA LUCE PENSATA

**MIZU**

**CODE 0R26S -- FT**

**230-240V ~ 50/60Hz MAX 260W**

**26xMAX 10W G4 12V**  

**Halogen**

**or**

**26xMAX 2W G4 12Vac** 

**LED**

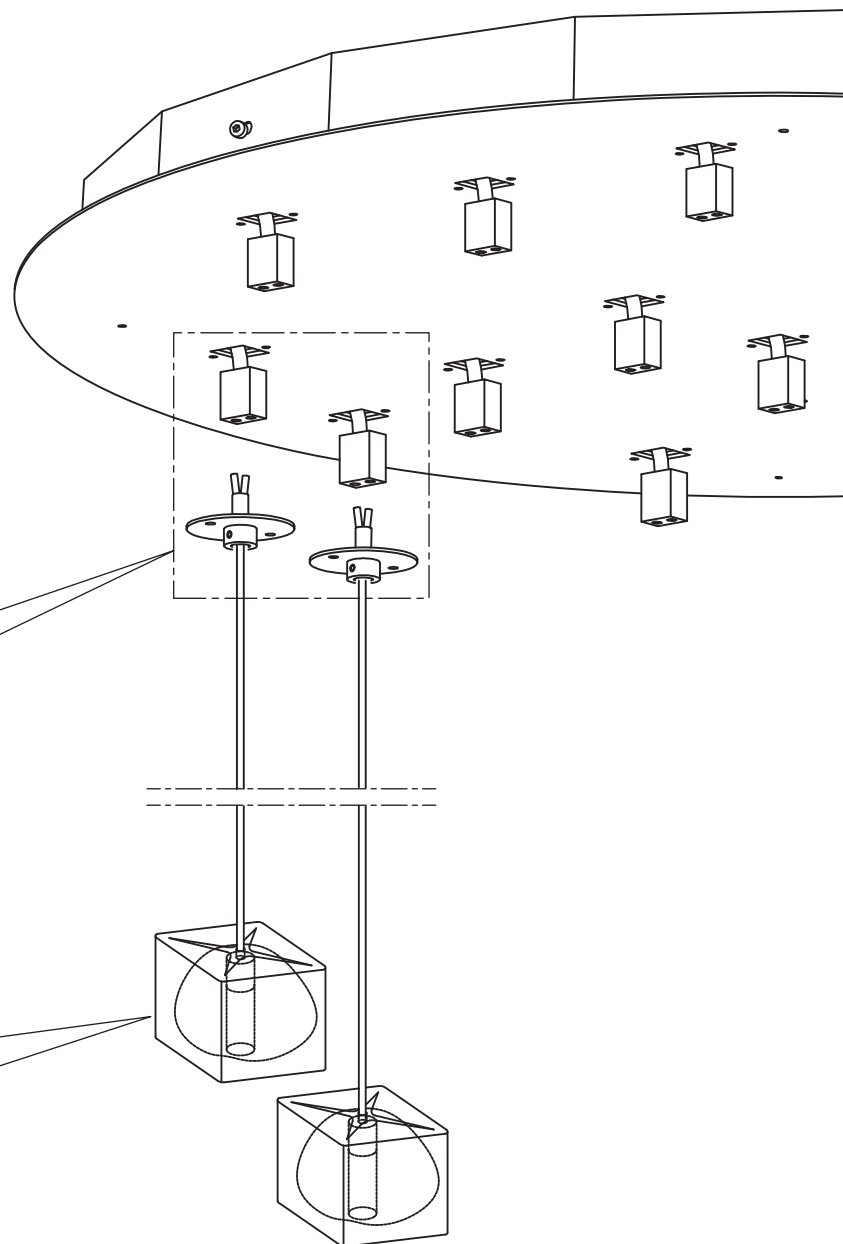
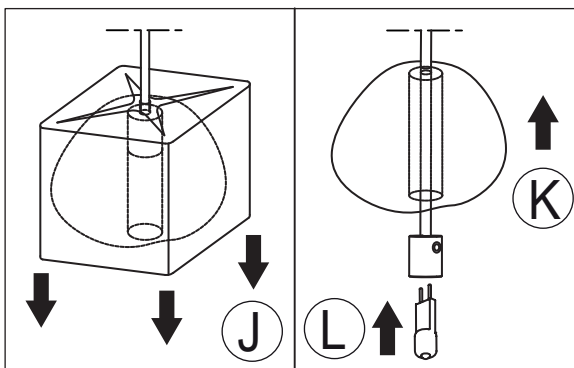
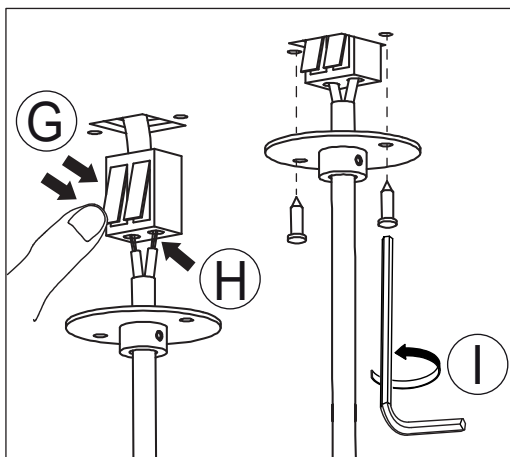
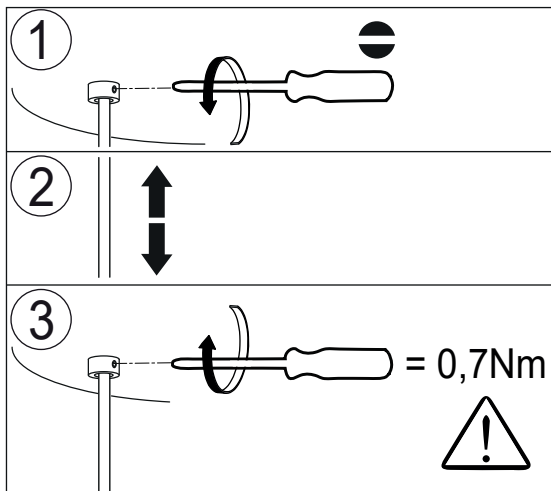
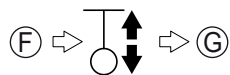
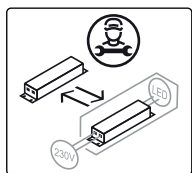

# CLEANING INSTRUCTIONS

## YES

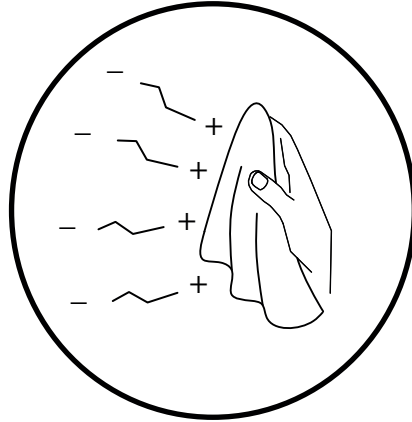

- IT** Usare panno elettrostatico asciutto  
**UK** Use dry electrostatic cloth  
**FR** Utiliser un chiffon électrostatique sec  
**DE** Verwenden sie ein trockenes elektrostattuch  
**PY** Использовать сухую электростатическую ткань  
عربي استخدم قطعة قماش جافة كهرباء

## NO

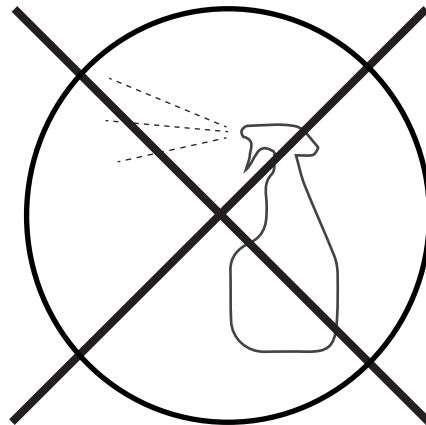

- IT** Non usare prodotti chimici | Usare prodotti specifici solo per cristalli e vetri  
**UK** Do not use chemical products | Use specific products only for crystals and glass  
**FR** Ne pas utiliser des produits chimiques | N'utiliser des produits spécifiques que pur les cristaux et le verre  
**DE** Verwenden Sie keine Chemikalien | Verwenden Sie bitte nur Glas-bzw Kristallreiniger  
**PY** Нельзя использовать химикаты | Использовать только специальные средства для хрусталя и стекла  
عربي لا تستخدم المنتجات الكيماوية | استعمل مواد مخصصة للكريستال والزجاج فقط



**IT** Conservare questa istruzione per la manutenzione | **UK** Keep these instructions for maintenance  
**FR** Garder ces instructions pour l'entretien | **DE** Dies Wartungsanleitung ist aufzubewahren  
**PY** Сохраните эту инструкцию по эксплуатации | عربي احتفظ بهذه الإرشادات للصيانة

**TERZANI**  
LA LUCE PENSATA

**Mizu** 26 round multi light pendant  
**0R26S-FTL**

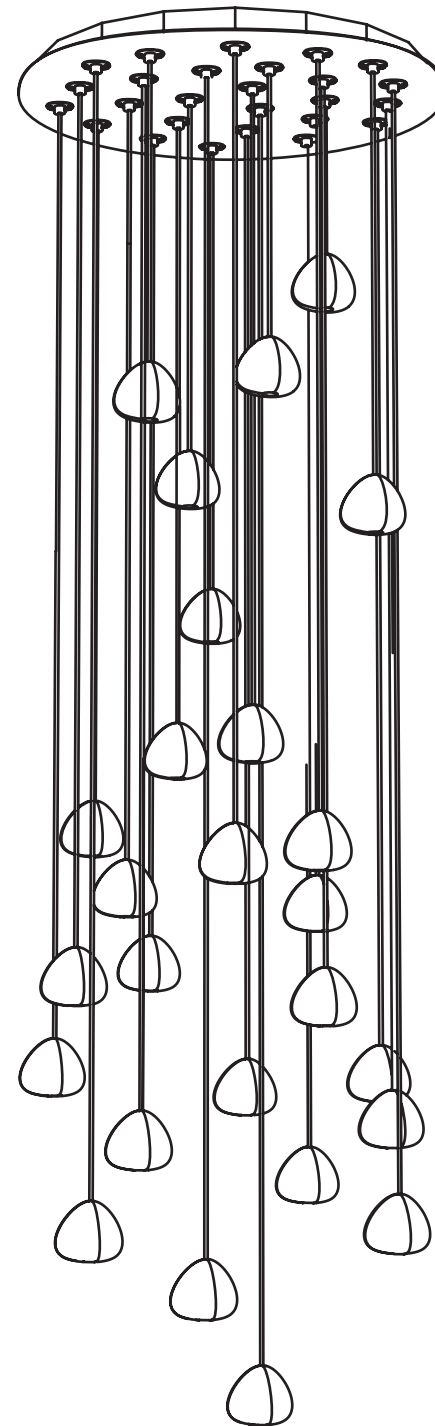

Design Nicolas Terzani

MIZU

CODE 0R26S -- -- FTL

220-240V ~ 50/60Hz MAX 52W

26xMAX 2W G4 12Vdc  
LED

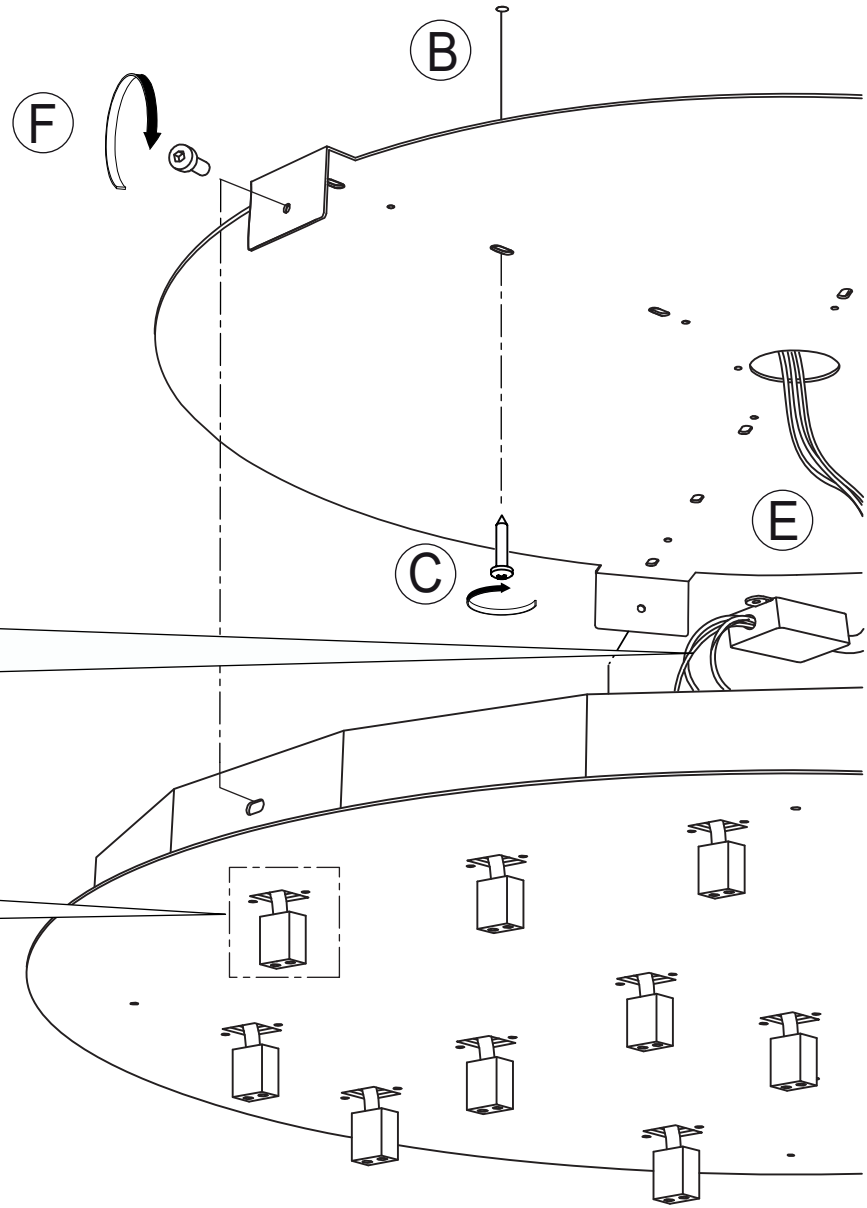
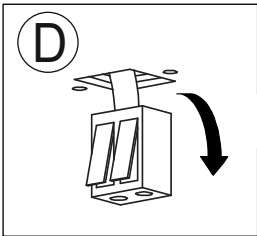
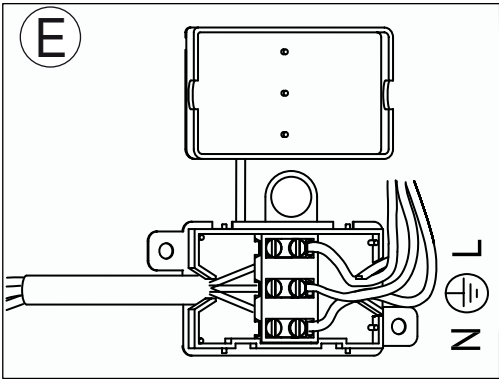
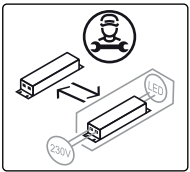

**CAUTION!**

<b>IT</b> questo prodotto non è compatibile con le lampadine LED G4 12V a marchio Beghelli	<b>UK</b> this product is not compatible with Beghelli branded G4 12V LED bulbs	<b>FR</b> cet produit n'est pas compatible avec les ampoules LED G4 12V marquée Beghelli	<b>DE</b> Das Produkt ist nicht kompatibel mit LED G4 12V Leuchtmittel Beghelli	<b>RU</b> Это изделие не совместимо со светодиодными лампами LED Beghelli G4 12V	<b>عربي</b> هذا المنتج لا يتوافق مع مصابيح ليد LED G4 12V من نوع بيغيلي Beghelli
---	--	---	--	---	---

**TERZANI**  
LA LUCE PENSATA

**MIZU**

**CODE 0R26S -- -- FTL**

**220-240V ~ 50/60Hz MAX 52W**

**26xMAX 2W G4 12Vdc**

**LED**



PWM



EAC

CB

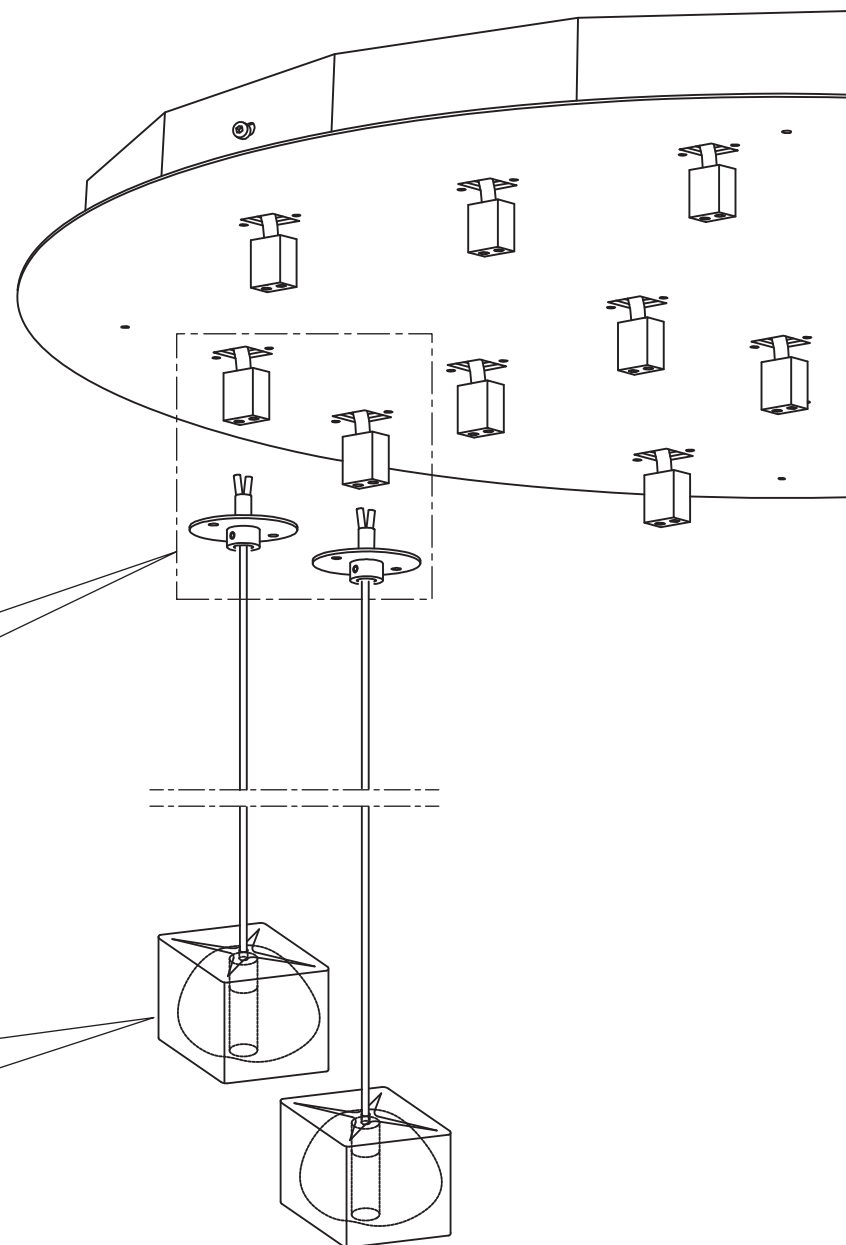
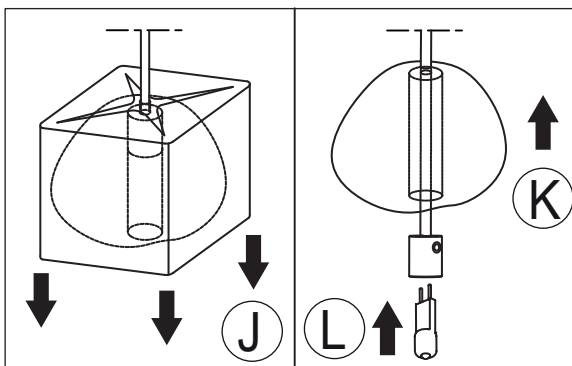
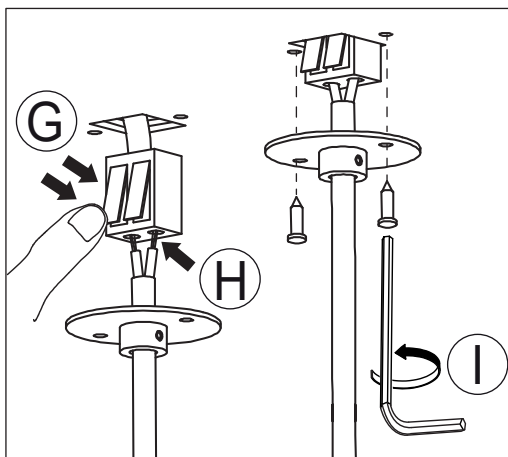
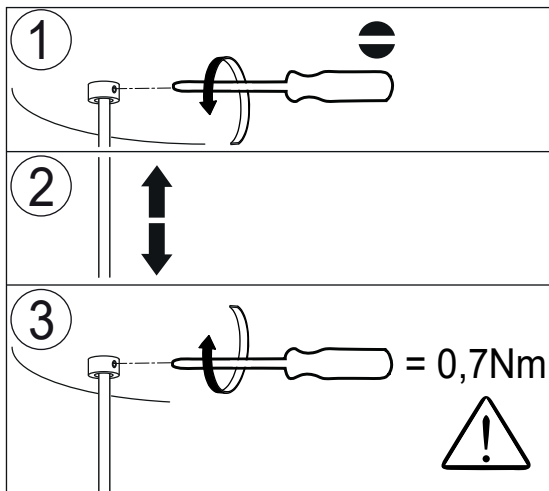
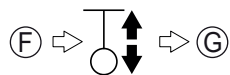
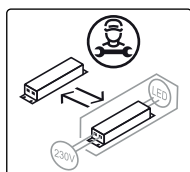

# CLEANING INSTRUCTIONS

## YES

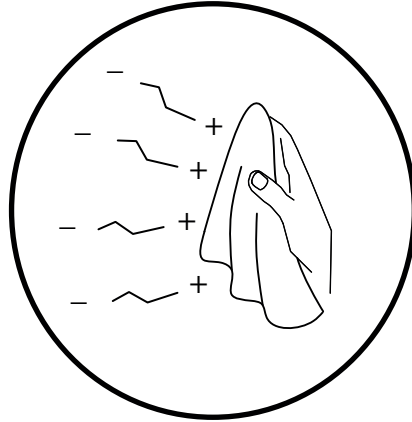

- IT** Usare panno elettrostatico asciutto  
**UK** Use dry electrostatic cloth  
**FR** Utiliser un chiffon électrostatique sec  
**DE** Verwenden sie ein trockenes elektrostattuch  
**PY** Использовать сухую электростатическую ткань  
عربي استخدم قطعة قماش جافة كهرباء

## NO

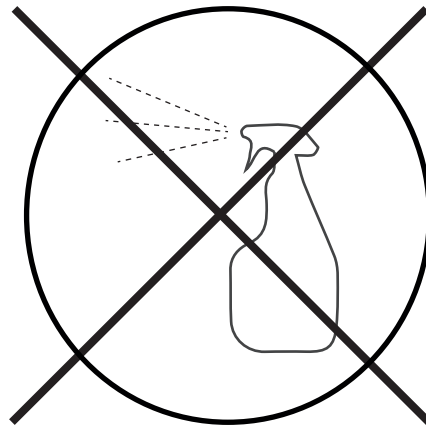

- IT** Non usare prodotti chimici | Usare prodotti specifici solo per cristalli e vetri  
**UK** Do not use chemical products | Use specific products only for crystals and glass  
**FR** Ne pas utiliser des produits chimiques | N'utiliser des produits spécifiques que pur les cristaux et le verre  
**DE** Verwenden Sie keine Chemikalien | Verwenden Sie bitte nur Glas-bzw Kristallreiniger  
**PY** Нельзя использовать химикаты | Использовать только специальные средства для хрусталя и стекла  
عربي لا تستخدم المنتجات الكيماوية | استعمل مواد مخصصة للكريستال والزجاج فقط



**IT** Conservare questa istruzione per la manutenzione | **UK** Keep these instructions for maintenance  
**FR** Garder ces instructions pour l'entretien | **DE** Dies Wartungsanleitung ist aufzubewahren  
**PY** Сохраните эту инструкцию по эксплуатации | عربي احتفظ بهذه الإرشادات للصيانة

**TERZANI**  
LA LUCE PENSATA

**Mizu** 26 round multi light pendant

**0R26S-FTE**

**0R26S-FTEW**

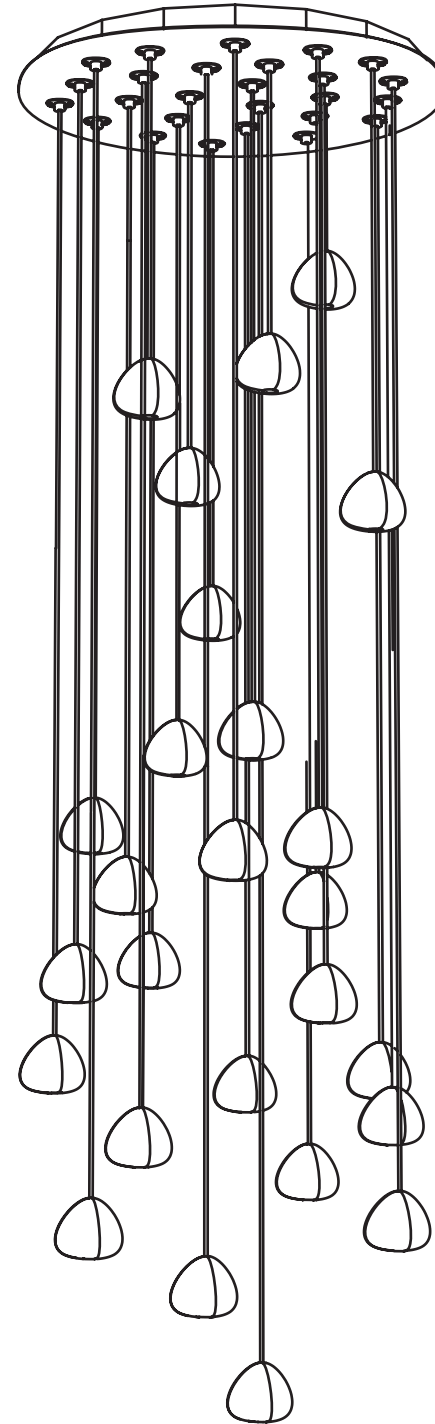

**MIZU**

**CODE 0R26S -- FTE**  
3000K

**CODE 0R26S -- FTEW**  
2700K

**220-240V ~ 50/60Hz MAX 39W**

**500mA 26xMAX 1,5W**  
**integrated LED**

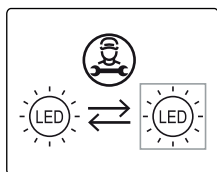
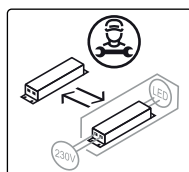

(A)

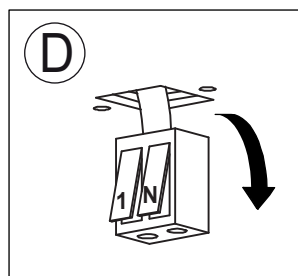
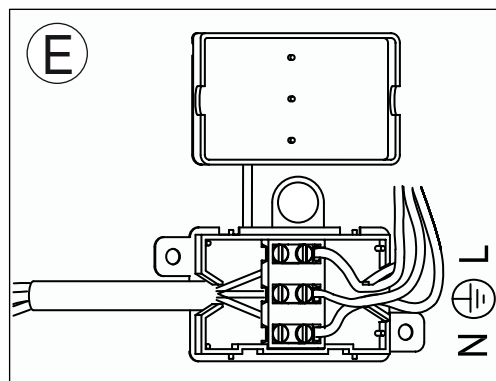

(D)

(B)



(C)

(E)

(F)

\* pag. 3/3

**MIZU**

**CODE 0R26S -- -- FTE**  
**3000K**

**CODE 0R26S -- -- FTEW**  
**2700K**

**220-240V ~ 50/60Hz MAX 39W**

**500mA 26xMAX 1,5W**

**integrated LED**

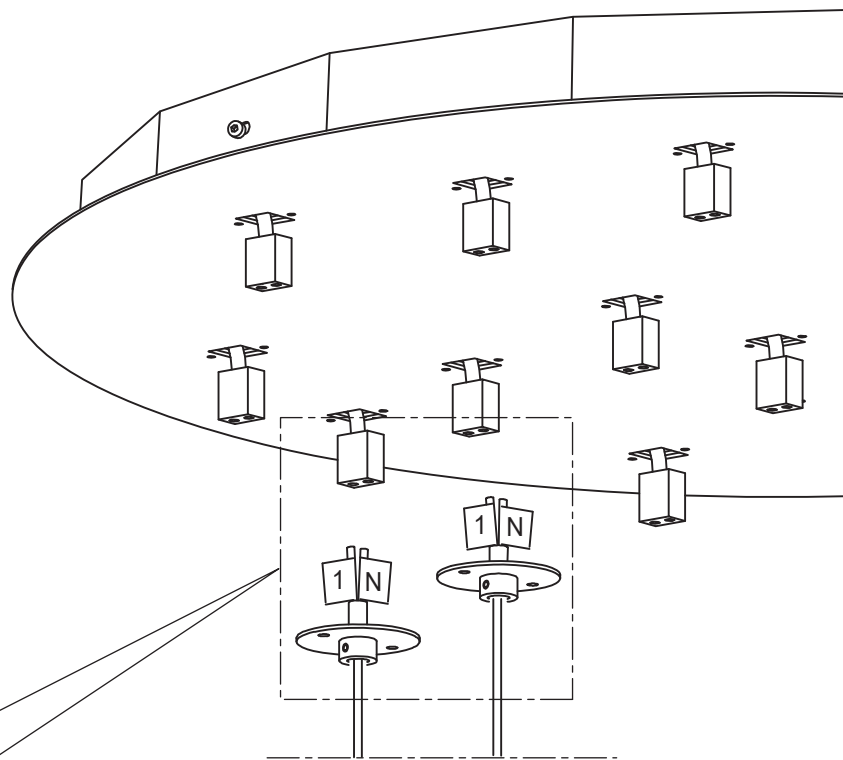
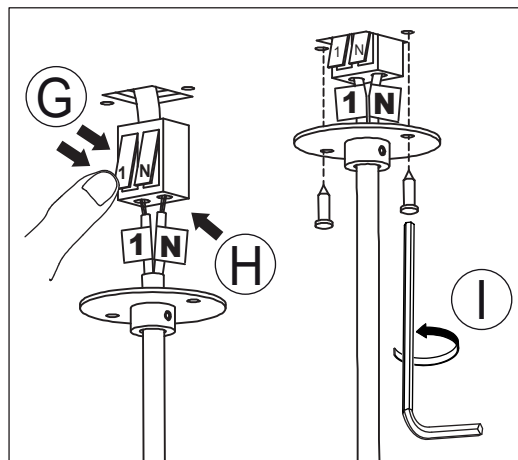
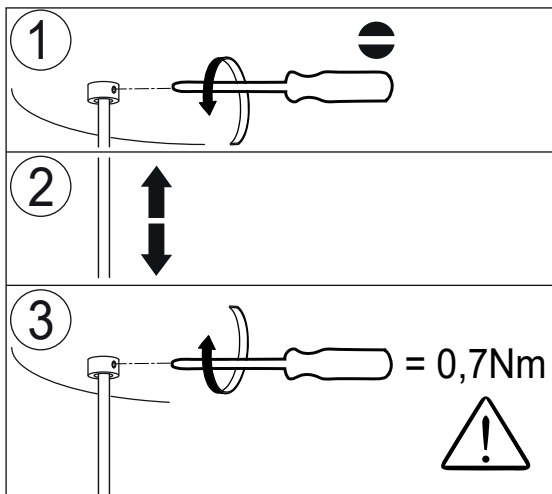
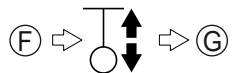
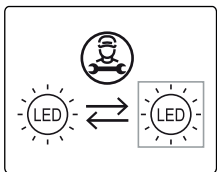
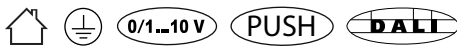

**MIZU**

**CODE 0R26S -- -- FTE**  
**3000K**

**CODE 0R26S -- -- FTEW**  
**2700K**

**220-240V ~ 50/60Hz MAX 39W**

**500mA 26xMAX 1,5W**

**integrated LED**

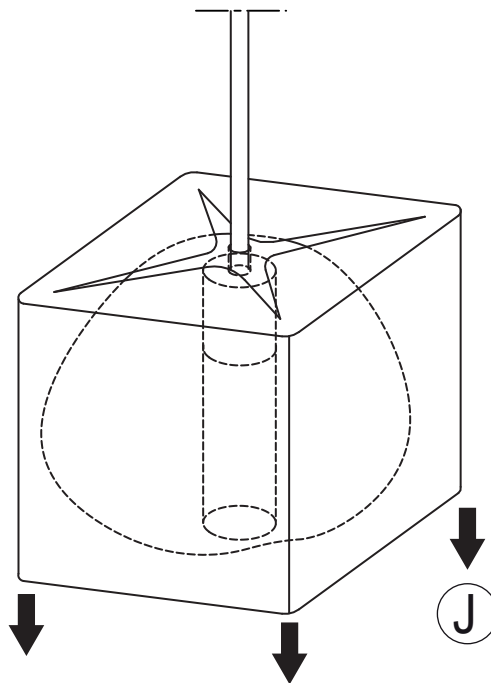
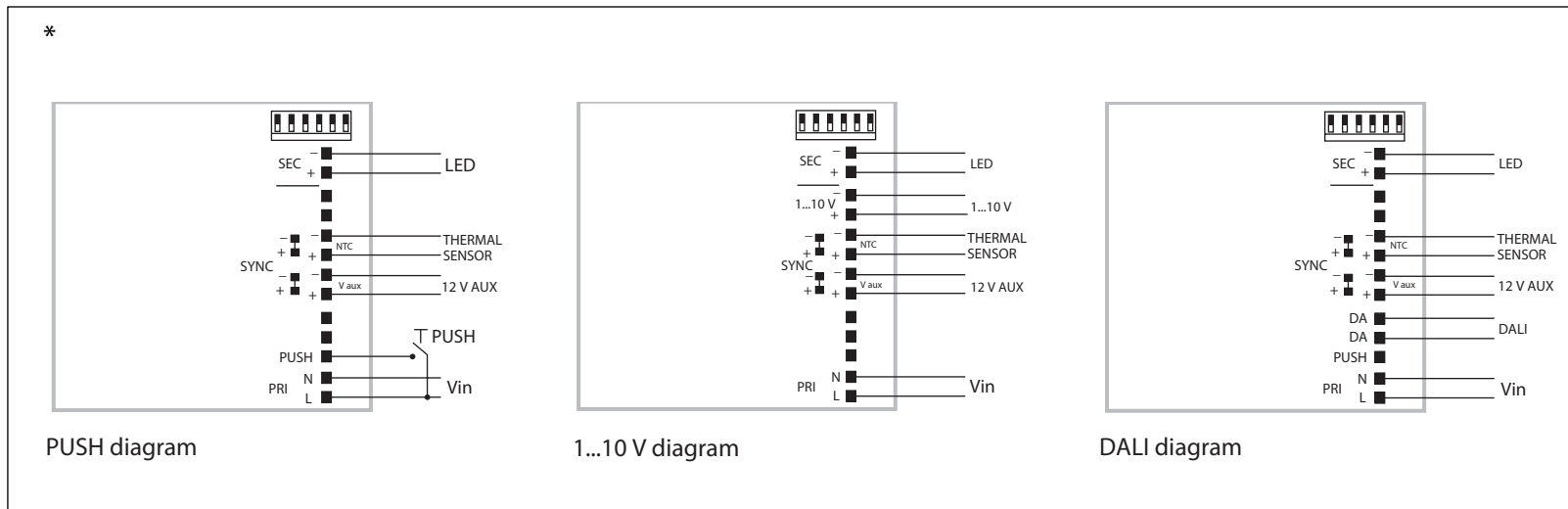
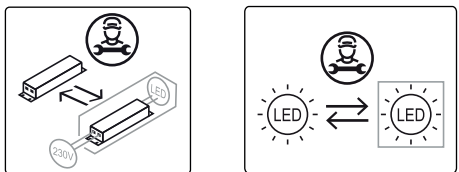
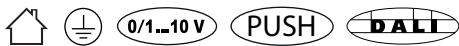

# CLEANING INSTRUCTIONS

## YES

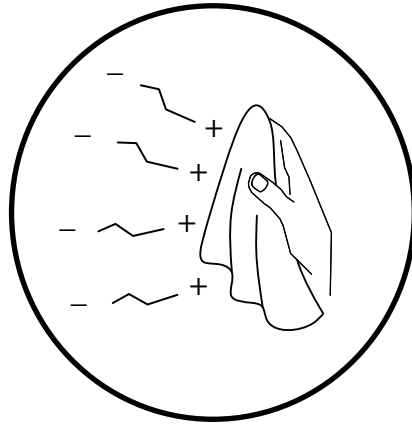

- IT** Usare panno elettrostatico asciutto  
**UK** Use dry electrostatic cloth  
**FR** Utiliser un chiffon électrostatique sec  
**DE** Verwenden sie ein trockenes elektrostattuch  
**PY** Использовать сухую электростатическую ткань  
عربي استخدم قطعة قماش جافة كهرباء

## NO

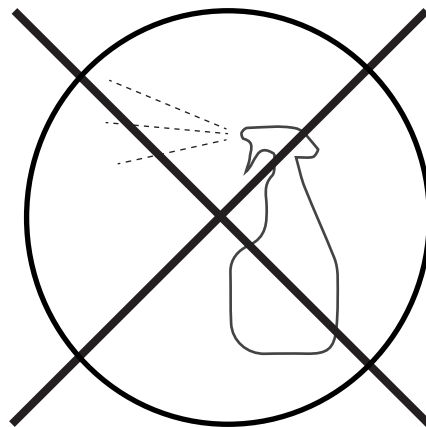

- IT** Non usare prodotti chimici | Usare prodotti specifici solo per cristalli e vetri  
**UK** Do not use chemical products | Use specific products only for crystals and glass  
**FR** Ne pas utiliser des produits chimiques | N'utiliser des produits spécifiques que pur les cristaux et le verre  
**DE** Verwenden Sie keine Chemikalien | Verwenden Sie bitte nur Glas-bzw Kristallreiniger  
**PY** Нельзя использовать химикаты | Использовать только специальные средства для хрусталя и стекла  
عربي لا تستخدم المنتجات الكيماوية | استعمل مواد مخصصة للكريستال والزجاج فقط



**IT** Conservare questa istruzione per la manutenzione | **UK** Keep these instructions for maintenance  
**FR** Garder ces instructions pour l'entretien | **DE** Dies Wartungsanleitung ist aufzubewahren  
**PY** Сохраните эту инструкцию по эксплуатации | عربي احتفظ بهذه الإرشادات للصيانة

**TERZANI**  
LA LUCE PENSATA

**Mizu** 26 round multi light pendant  
**0R26S-FTD**

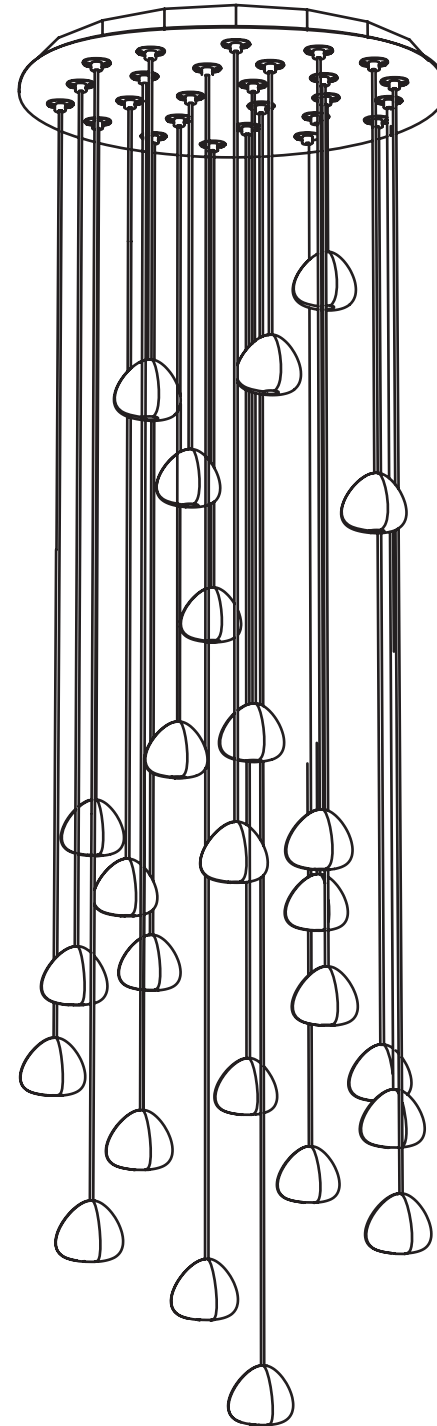

Design Nicolas Terzani

**TERZANI**  
LA LUCE PENSATA

**MIZU**

**CODE 0R26S -- -- FTD**

**230-240V ~ 50/60Hz MAX 260W**

**26xMAX 10W G4 12V** 

**Halogen**

or

**26xMAX 2W G4 12Vac** 

**LED**

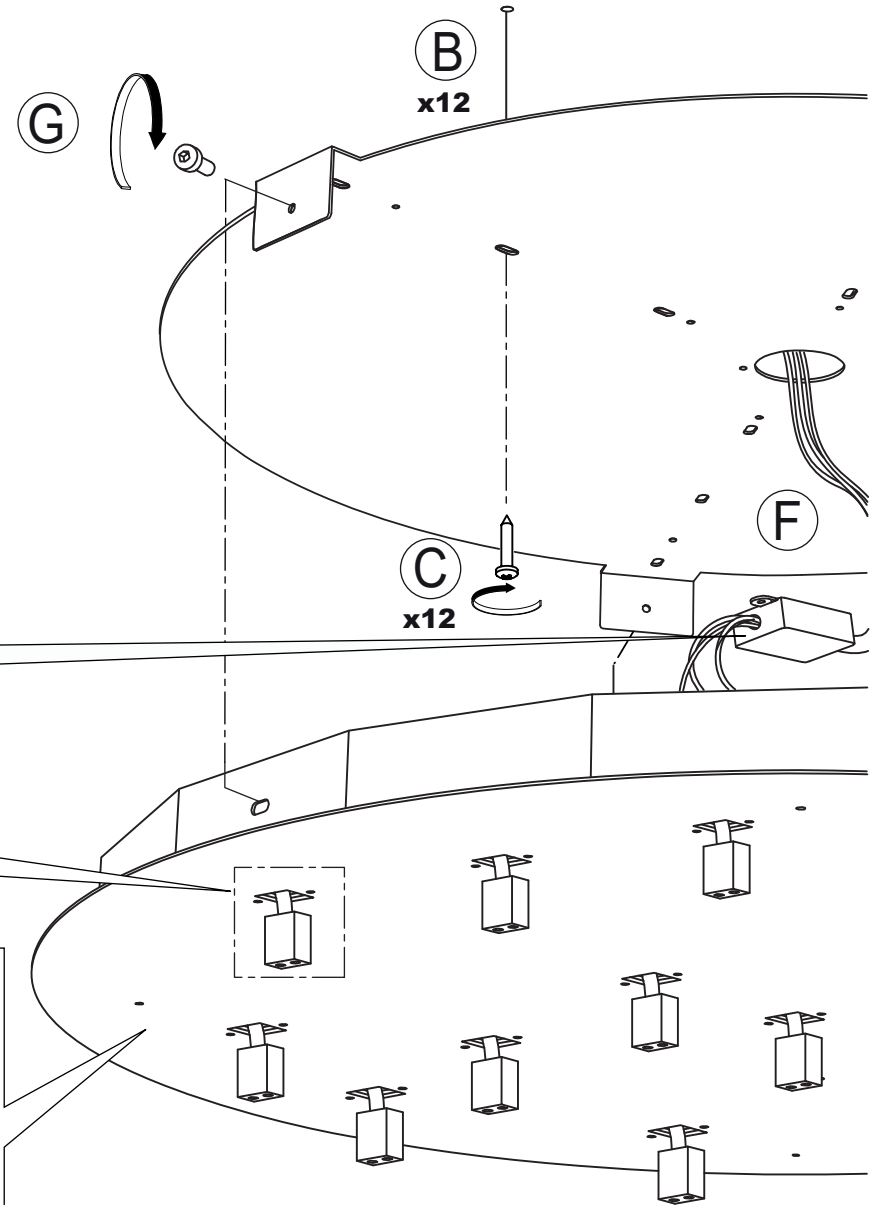
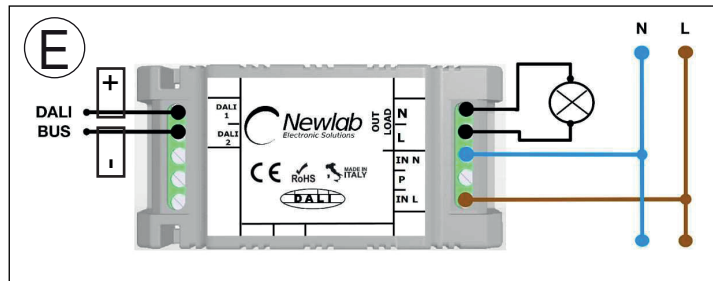
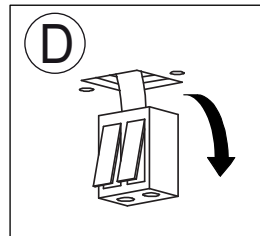
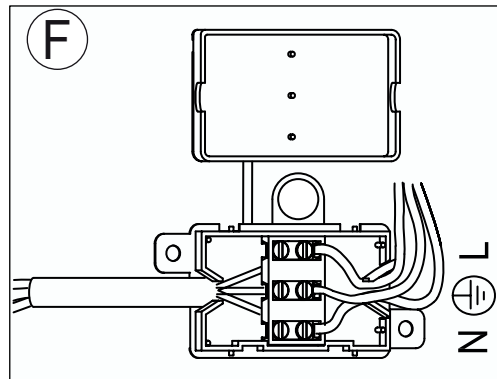
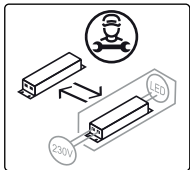

**IT**

questo prodotto non è compatibile con le lampadine LED G4 12V a marchio Beghelli

**UK**

this product is not compatible with Beghelli branded G4 12V LED bulbs

**FR**

cet produit n'est pas compatible avec les ampoules LED G4 12V marquée Beghelli

**DE**

Das Produkt ist nicht kompatibel mit LED G4 12V Leuchtmittel Beghelli

**RU**

Это изделие не совместимо со светодиодными лампами LED Beghelli G4 12V

عربي  
هذا المنتج لا يتوافق مع مصابيح ليد LED G4 12V من نوع بيغيلي Beghelli

**TERZANI**  
LA LUCE PENSATA

**MIZU**

**CODE 0R26S -- -- FTD**

**230-240V ~ 50/60Hz MAX 260W**

**26xMAX 10W G4 12V**  

**Halogen**

or

**26xMAX 2W G4 12Vac** 

**LED**



 **60Kgf**  
**600N**

 **x3**



**Y**



**ERC**

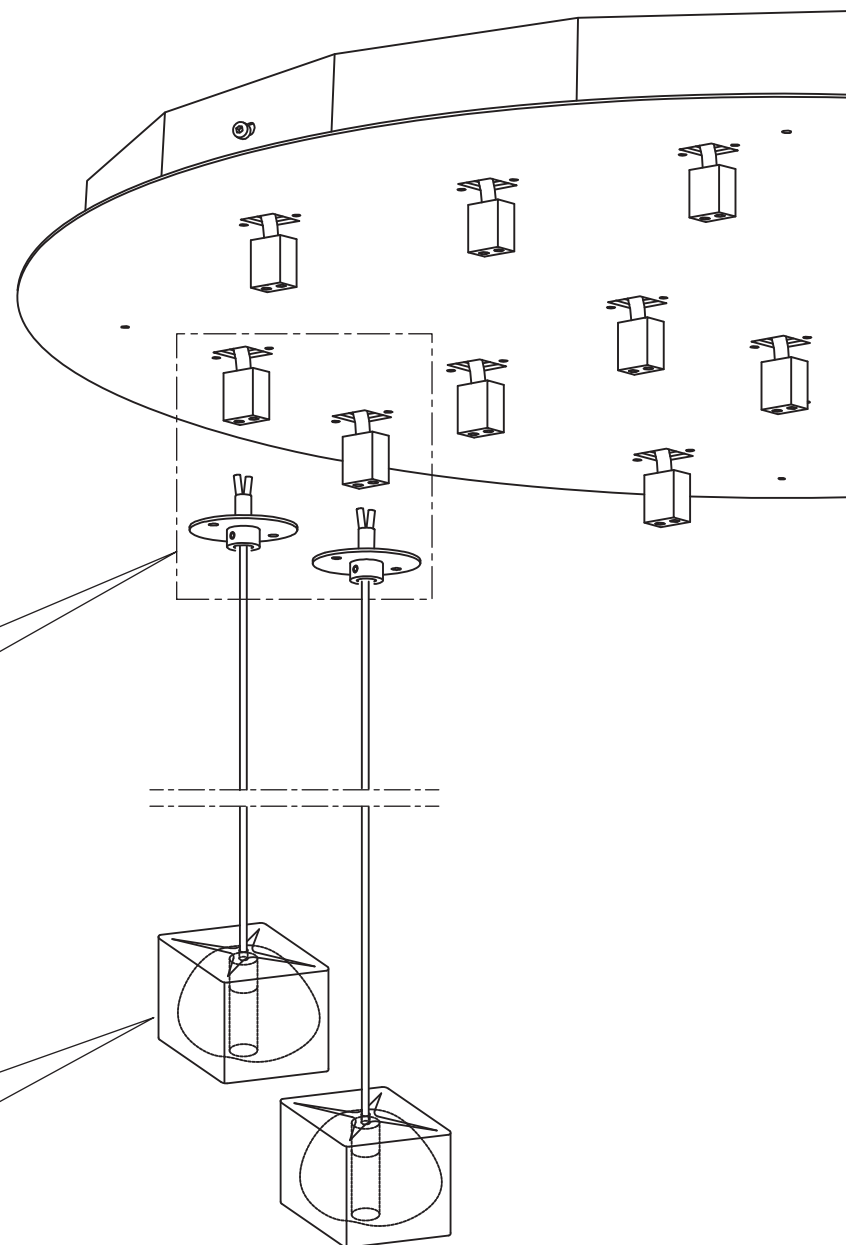
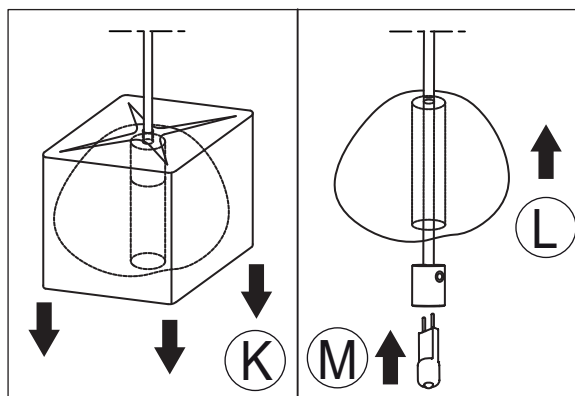
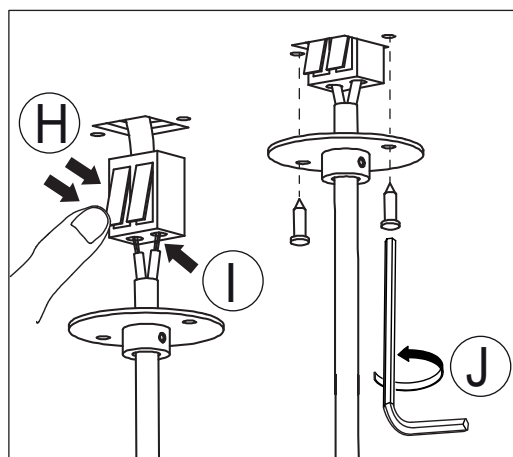
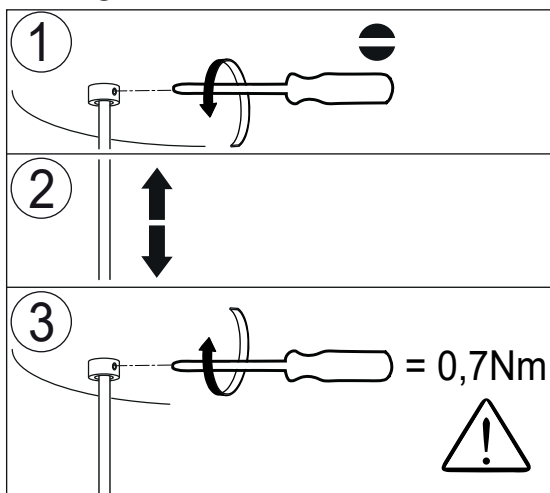
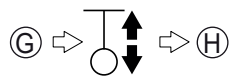
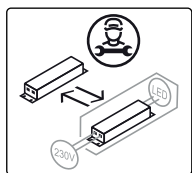

# CLEANING INSTRUCTIONS

## YES

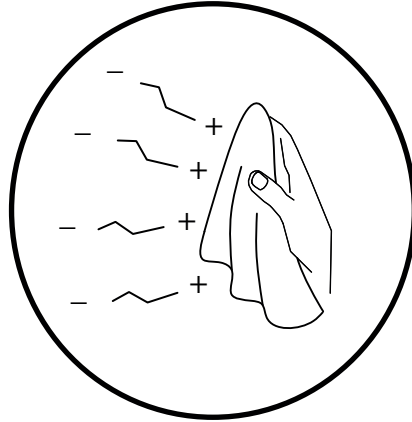

- IT** Usare panno elettrostatico asciutto  
**UK** Use dry electrostatic cloth  
**FR** Utiliser un chiffon électrostatique sec  
**DE** Verwenden sie ein trockenes elektrostattuch  
**PY** Использовать сухую электростатическую ткань  
عربي استخدم قطعة قماش جافة كهرباء

## NO

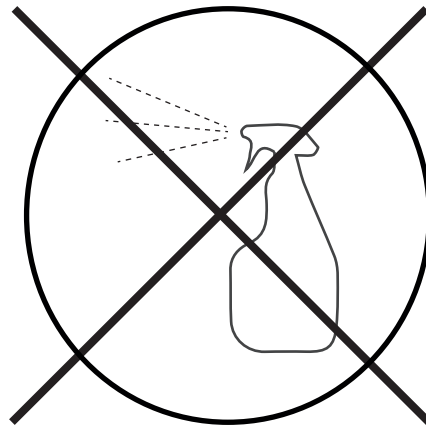

- IT** Non usare prodotti chimici | Usare prodotti specifici solo per cristalli e vetri  
**UK** Do not use chemical products | Use specific products only for crystals and glass  
**FR** Ne pas utiliser des produits chimiques | N'utiliser des produits spécifiques que pur les cristaux et le verre  
**DE** Verwenden Sie keine Chemikalien | Verwenden Sie bitte nur Glas-bzw Kristallreiniger  
**PY** Нельзя использовать химикаты | Использовать только специальные средства для хрусталя и стекла  
عربي لا تستخدم المنتجات الكيماوية | استعمل مواد مخصصة للكريستال والزجاج فقط



**IT** Conservare questa istruzione per la manutenzione | **UK** Keep these instructions for maintenance  
**FR** Garder ces instructions pour l'entretien | **DE** Dies Wartungsanleitung ist aufzubewahren  
**PY** Сохраните эту инструкцию по эксплуатации | عربي احتفظ بهذه الإرشادات للصيانة