

TERZANI
LA LUCE PENSATA

Mizu 15 rectangular multi light pendant
0R15S-FR

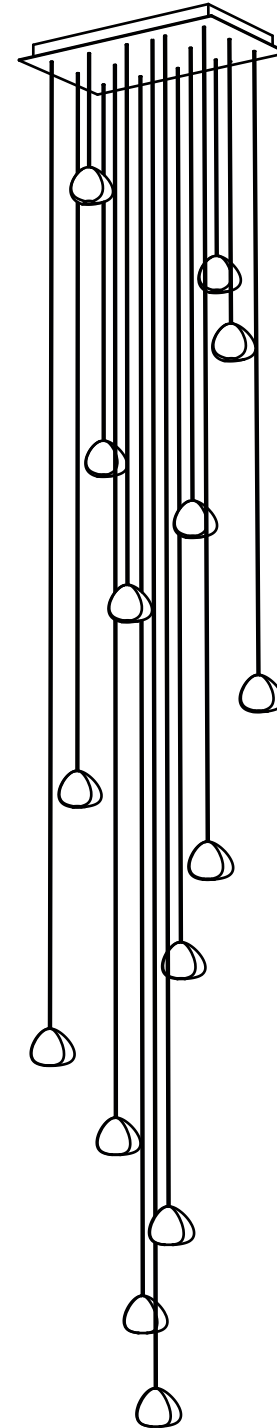

Design Nicolas Terzani



MIZU

CODE 0R15S -- -- FR

230-240V ~ 50/60Hz MAX 150W

15xMAX 10W G4 12V  

Halogen

or

15xMAX 2W G4 12Vac 

LED

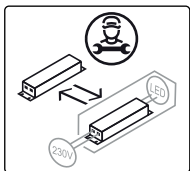

FOLLOW THE LETTERS TO PLACE THE PENDANTS IN THE CORRECT POSITION

TOP VIEW:

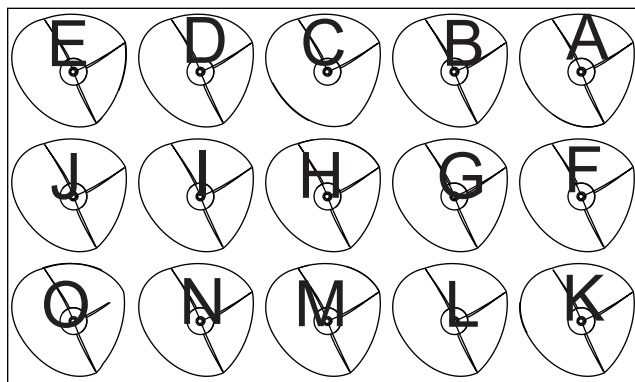
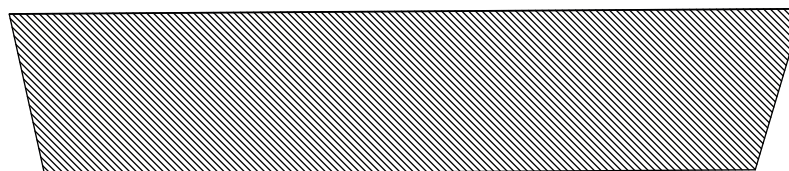
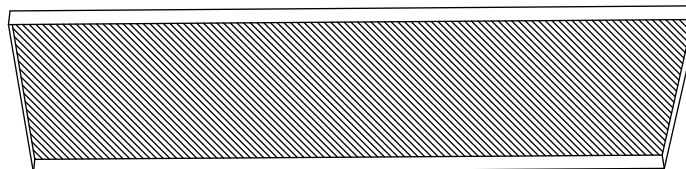

FRONT VIEW



MIZU

CODE 0R15S -- -- FR

230-240V ~ 50/60Hz MAX 150W

15xMAX 10W G4 12V

Halogen

or

15xMAX 2W G4 12Vac

LED

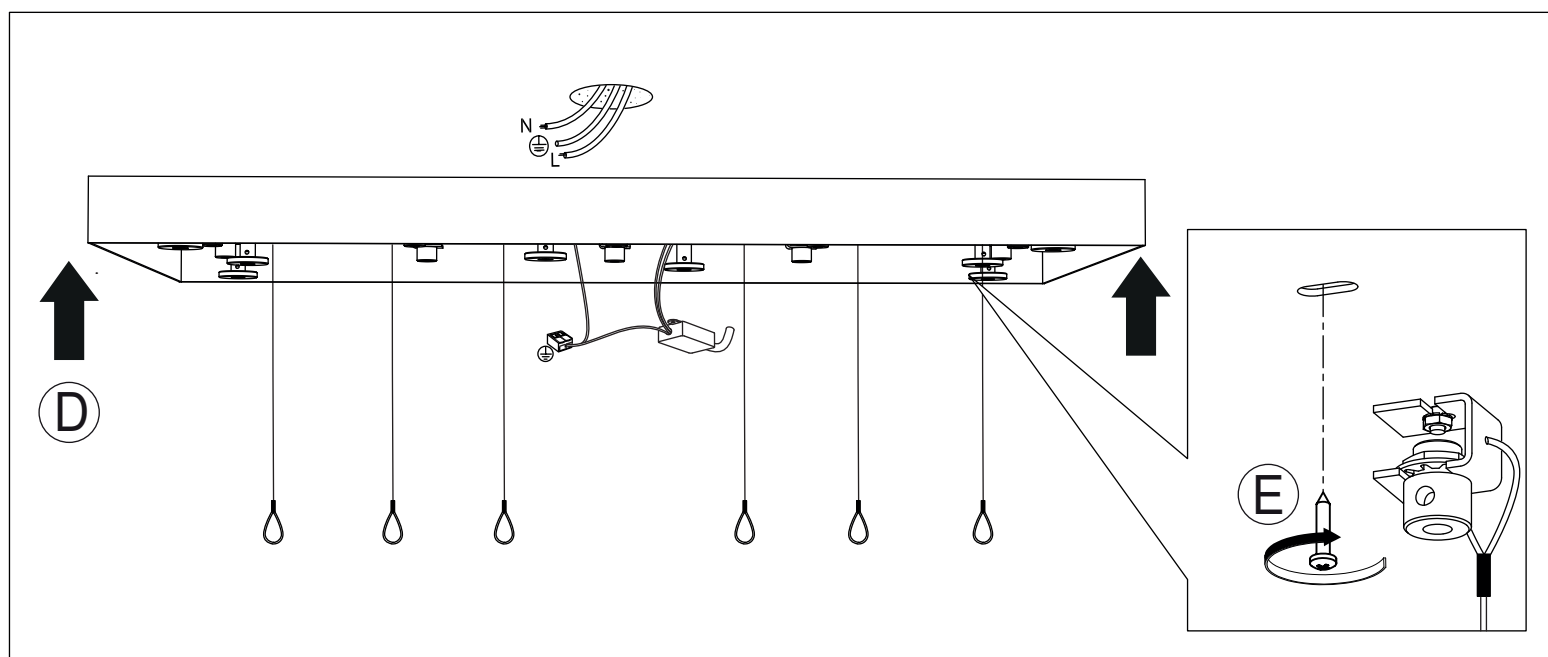
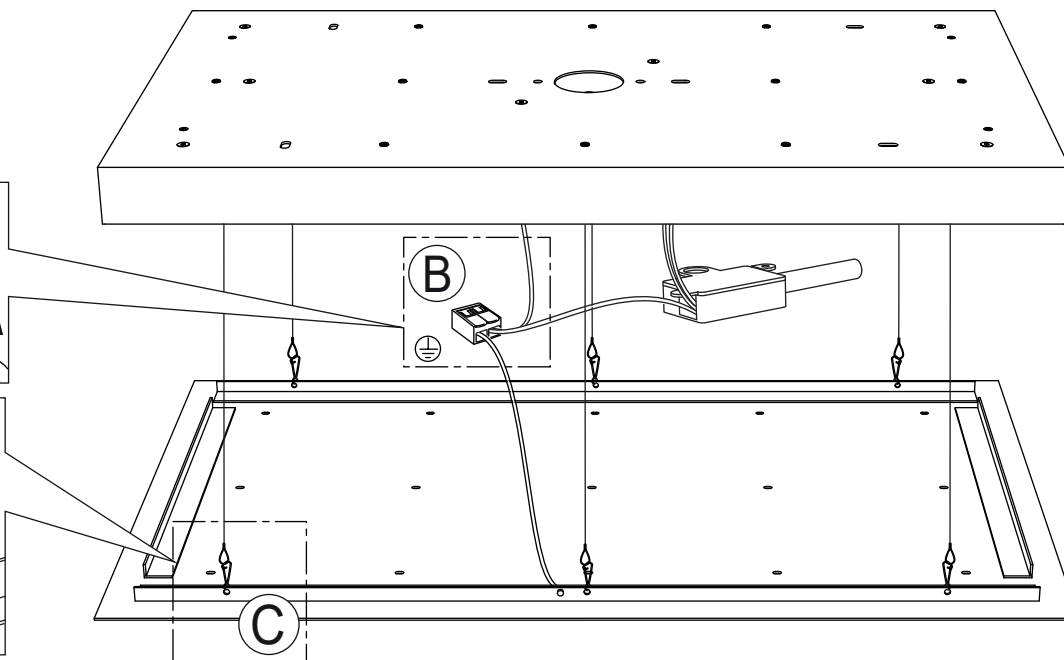
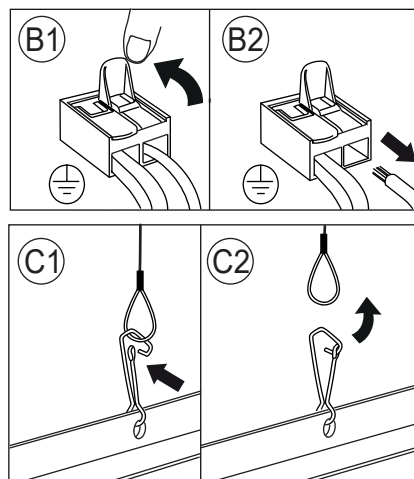
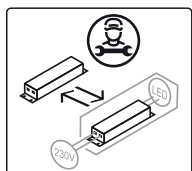



MIZU

CODE 0R15S -- FR

230-240V ~ 50/60Hz MAX 150W

15xMAX 10W G4 12V

Halogen

or

15xMAX 2W G4 12Vac

LED



36Kgf
360N

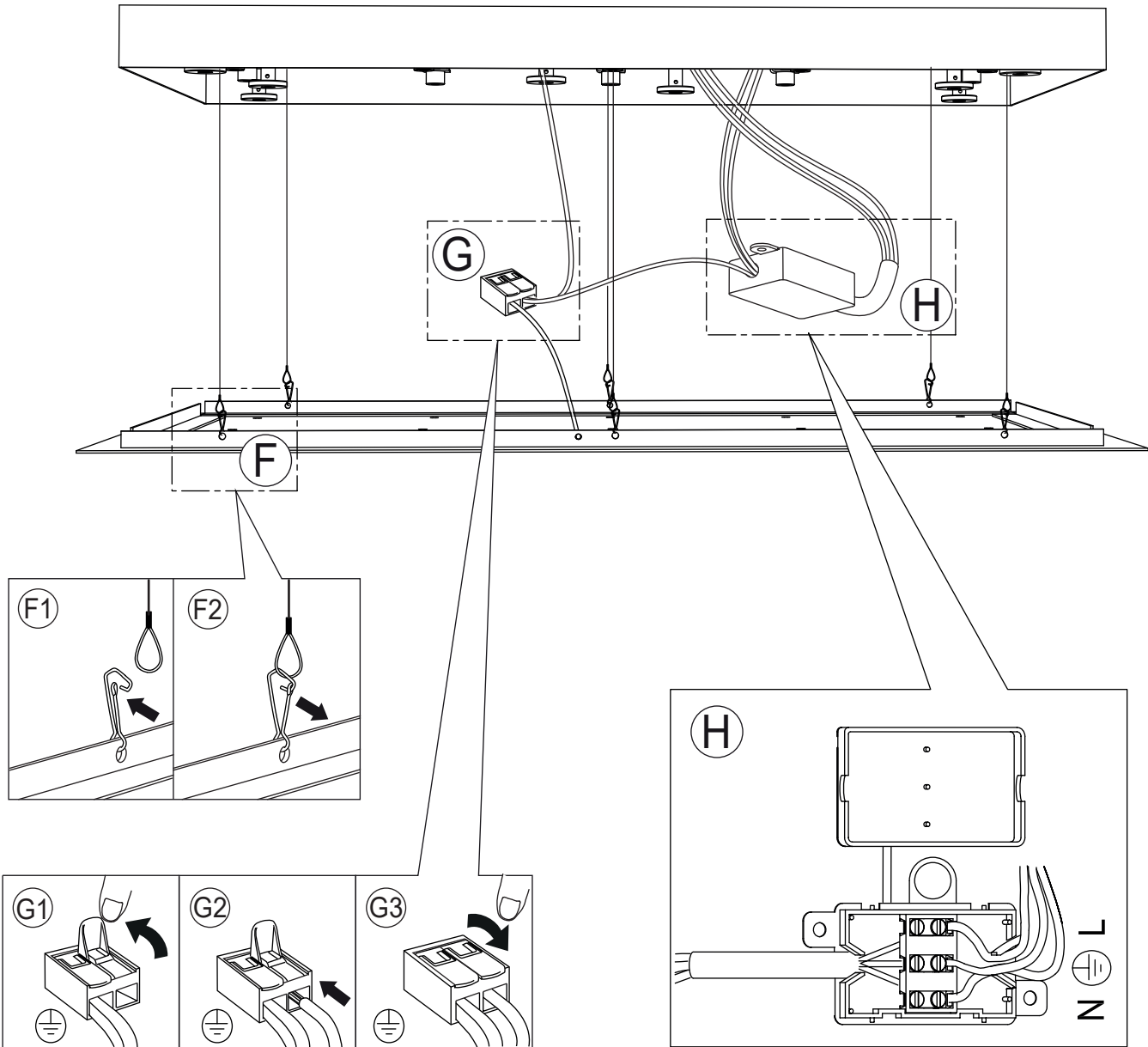
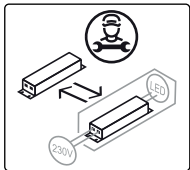

TERZANI

LA LUCE PENSATA

MIZU

CODE 0R15S -- FR

230-240V ~ 50/60Hz MAX 150W

15xMAX 10W G4 12V

Halogen

or

15xMAX 2W G4 12Vac

LED

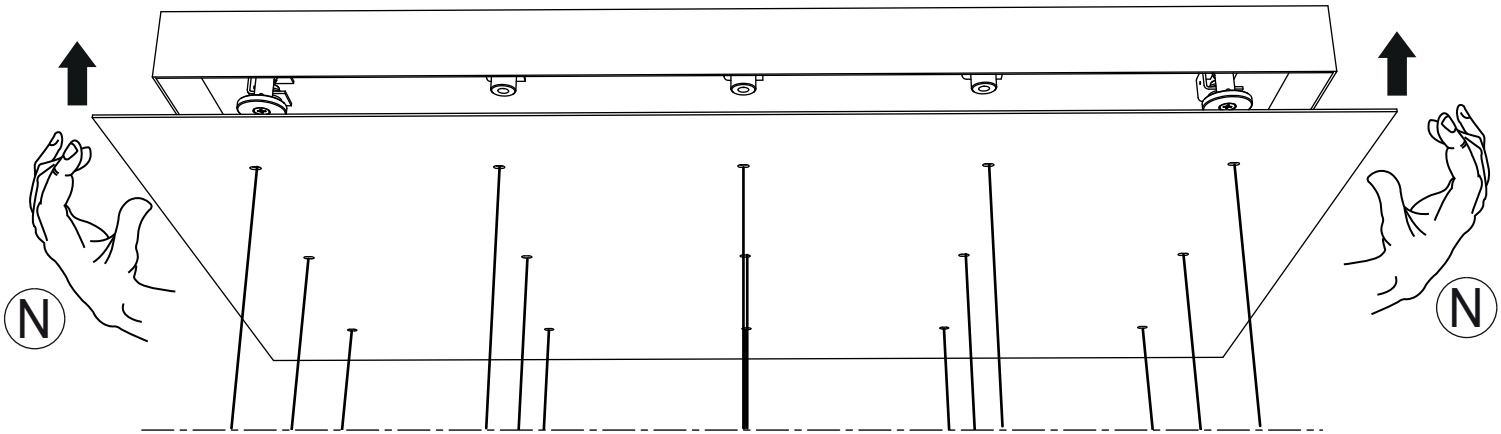
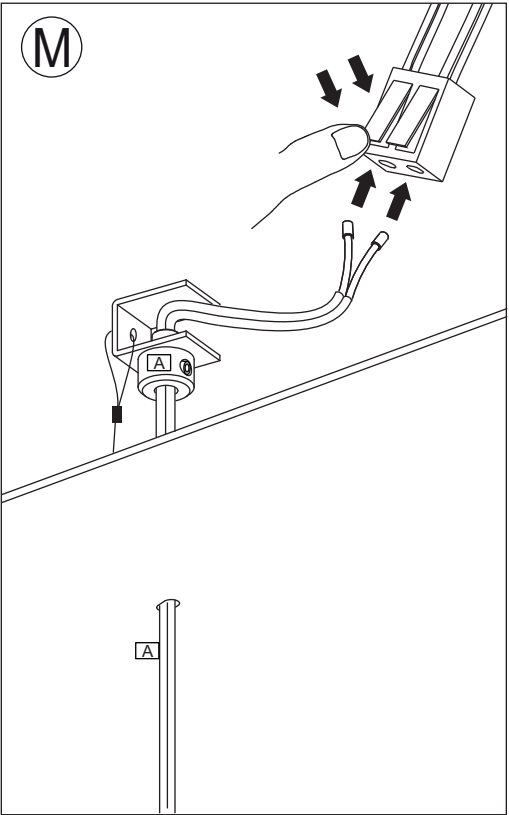
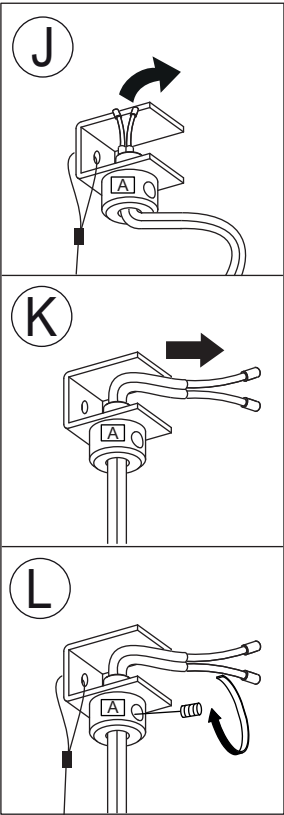
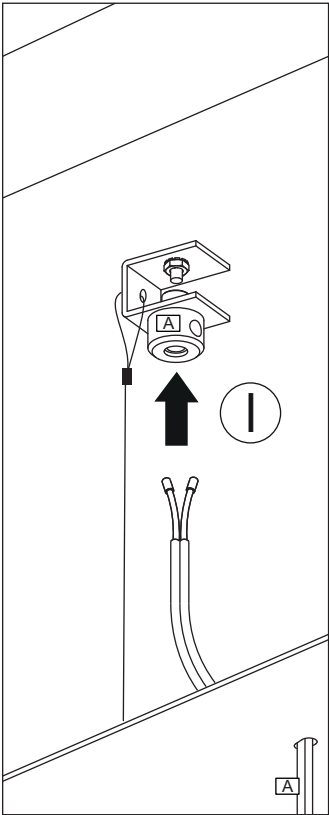
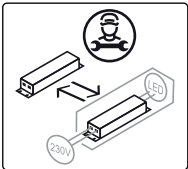

MIZU

CODE 0R15S -- -- FR

230-240V ~ 50/60Hz MAX 150W

15xMAX 10W G4 12V  

Halogen

or

15xMAX 2W G4 12Vac

LED

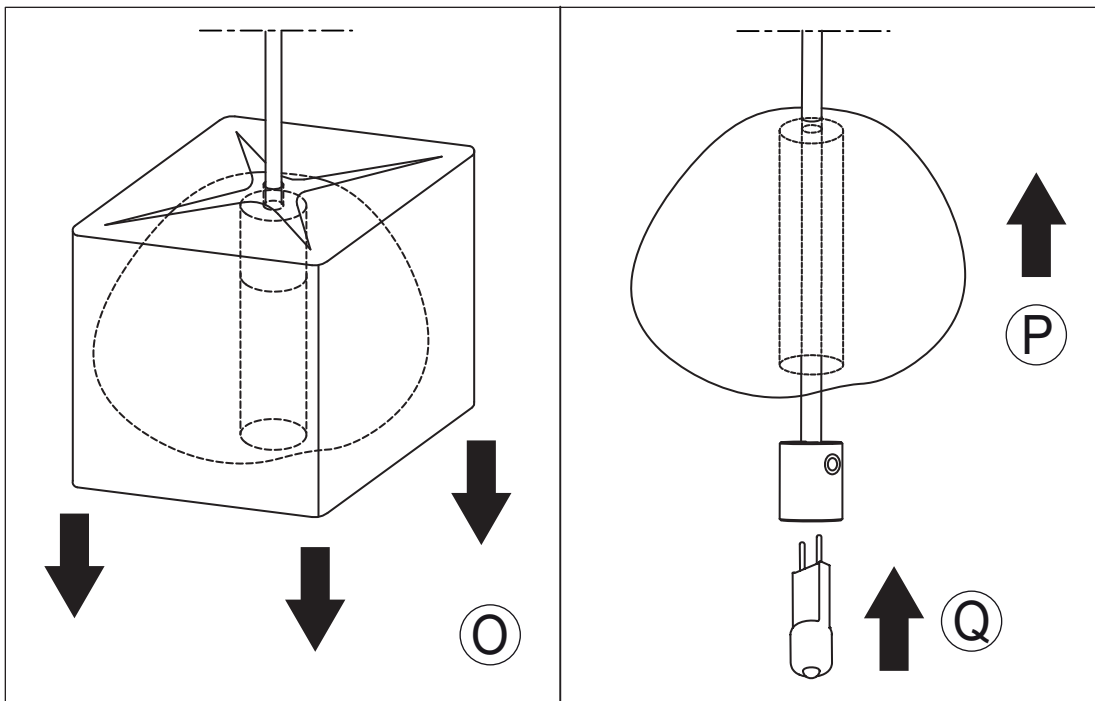
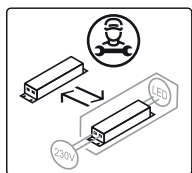

IT
questo prodotto non
è compatibile con le
lampadine LED G4
12V a marchio
Beghelli

UK
this product is not
compatible with
Beghelli branded G4
12V LED bulbs

FR
cet produit n'est pas
compatible avec les
ampoules LED G4
12V marquée
Beghelli

DE
Das Produkt ist nicht
kompatibel mit LED
G4 12V Leuchtmittel
Beghelli

ру
Это изделие не
совместимо со
светодиодными
лампами LED Beghelli
G4 12V

عربي
هذا المنتج لا يتوافق مع
LED G4 12V مصابيح ليد
من نوع بيغھللي Beghelli

CLEANING INSTRUCTIONS

YES

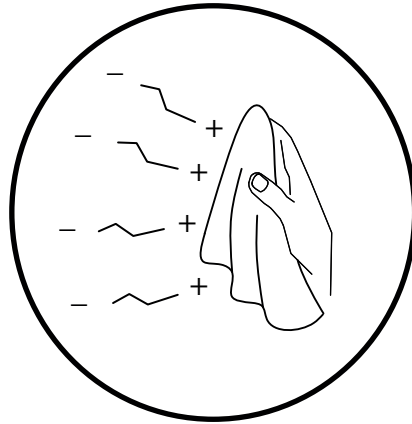

- IT** Usare panno elettrostatico asciutto
UK Use dry electrostatic cloth
FR Utiliser un chiffon électrostatique sec
DE Verwenden sie ein trockenes elektrostattuch
PY Использовать сухую электростатическую ткань
عربي استخدم قطعة قماش جافة كهرباء

NO

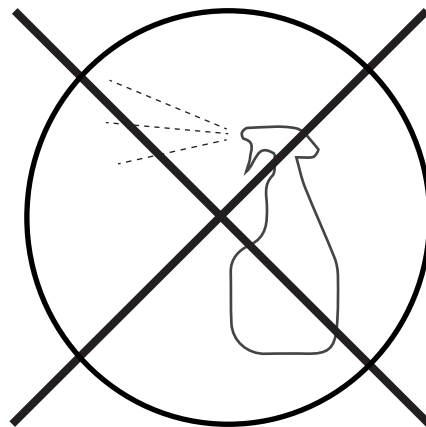

- IT** Non usare prodotti chimici | Usare prodotti specifici solo per cristalli e vetri
UK Do not use chemical products | Use specific products only for crystals and glass
FR Ne pas utiliser des produits chimiques | N'utiliser des produits spécifiques que pur les cristaux et le verre
DE Verwenden Sie keine Chemikalien | Verwenden Sie bitte nur Glas-bzw Kristallreiniger
PY Нельзя использовать химикаты | Использовать только специальные средства для хрусталя и стекла
عربي لا تستخدم المنتجات الكيماوية | استعمل مواد مخصصة للكريستال والزجاج فقط



IT Conservare questa istruzione per la manutenzione | **UK** Keep these instructions for maintenance
FR Garder ces instructions pour l'entretien | **DE** Dies Wartungsanleitung ist aufzubewahren
PY Сохраните эту инструкцию по эксплуатации | عربي احتفظ بهذه الإرشادات للصيانة

TERZANI
LA LUCE PENSATA

Mizu 15 rectangular multi light pendant
0R15S-FRL

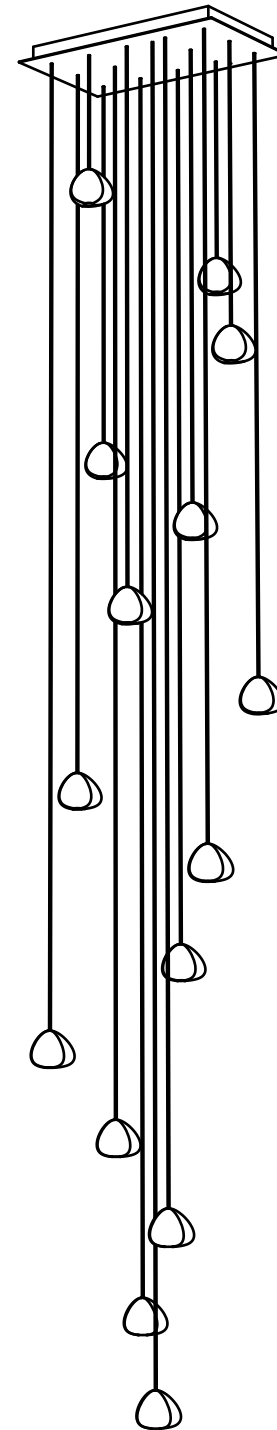

Design Nicolas Terzani



MIZU

CODE 0R15S -- -- FRL

220-240V ~ 50/60Hz MAX 30W

15xMAX 2W G4 12Vdc

LED

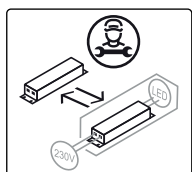

FOLLOW THE LETTERS TO PLACE THE PENDANTS IN THE CORRECT POSITION

TOP VIEW:

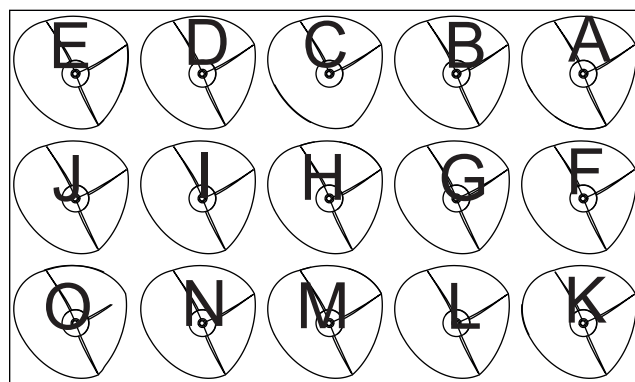
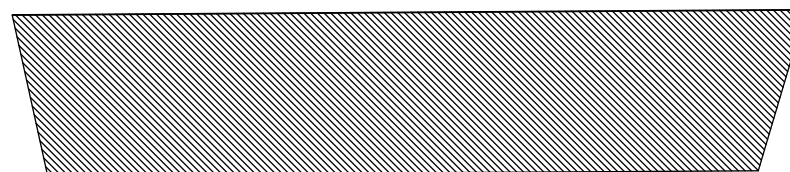
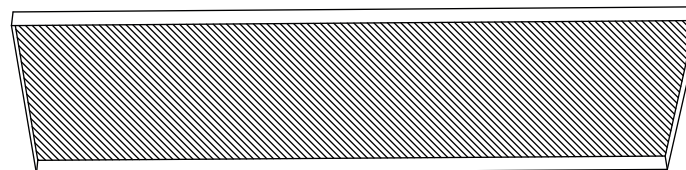

FRONT VIEW





MIZU

CODE 0R15S -- FRL

220-240V ~ 50/60Hz MAX 30W

15xMAX 2W G4 12Vdc

LED



36KgF
360N

x3



1...10 V

PWM



ERC

CB

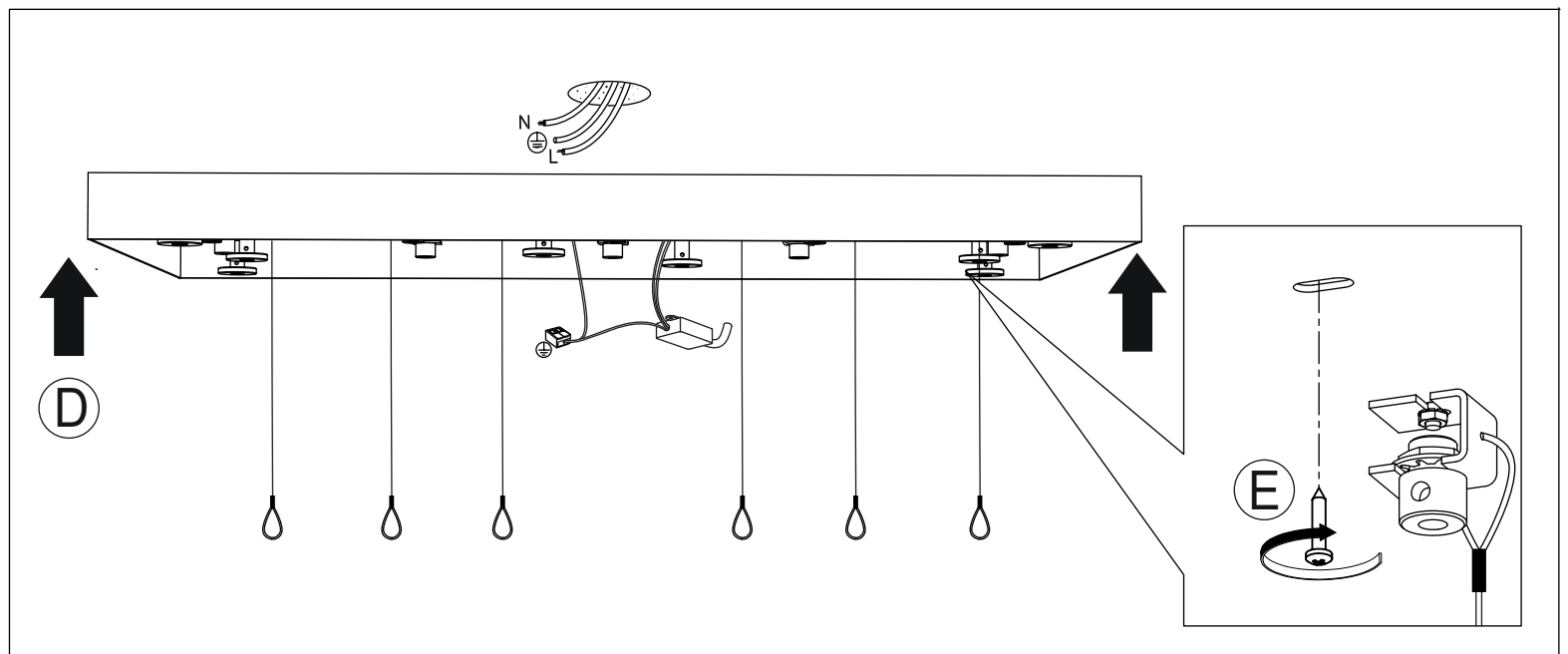
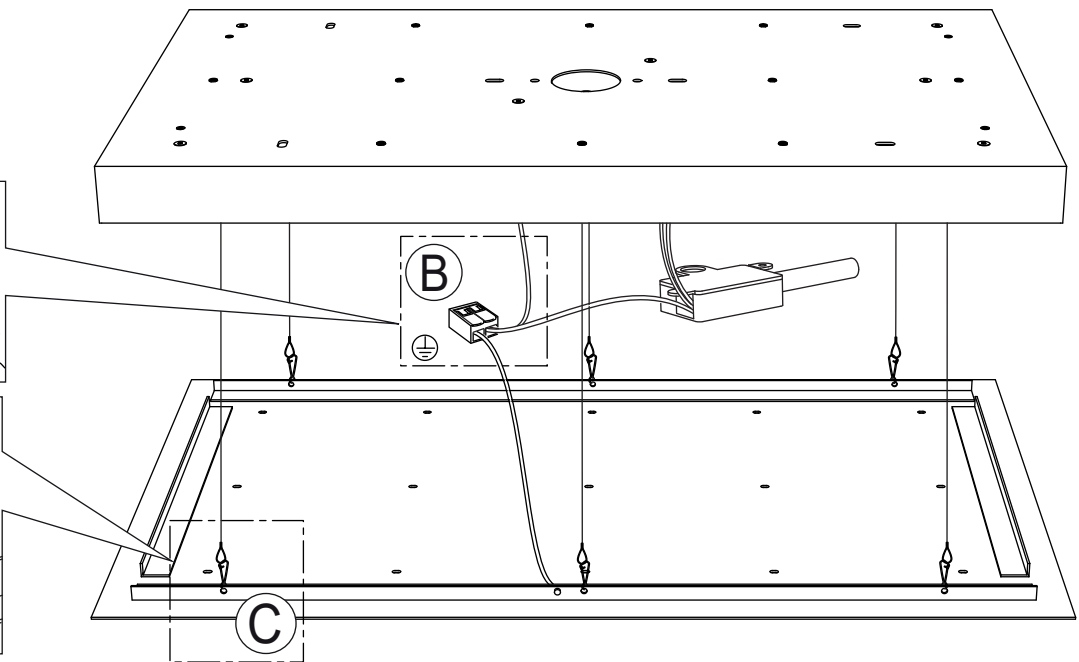
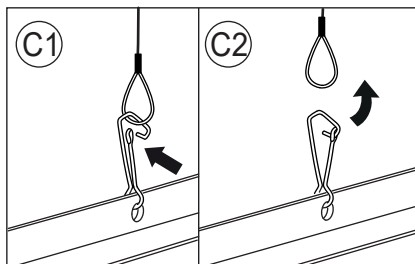
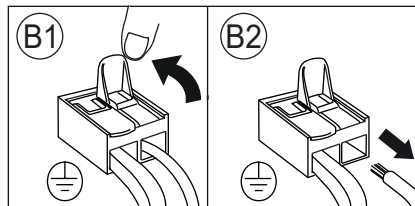
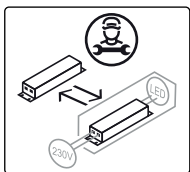

MIZU

CODE 0R15S -- FRL

220-240V ~ 50/60Hz MAX 30W

15xMAX 2W G4 12Vdc

LED

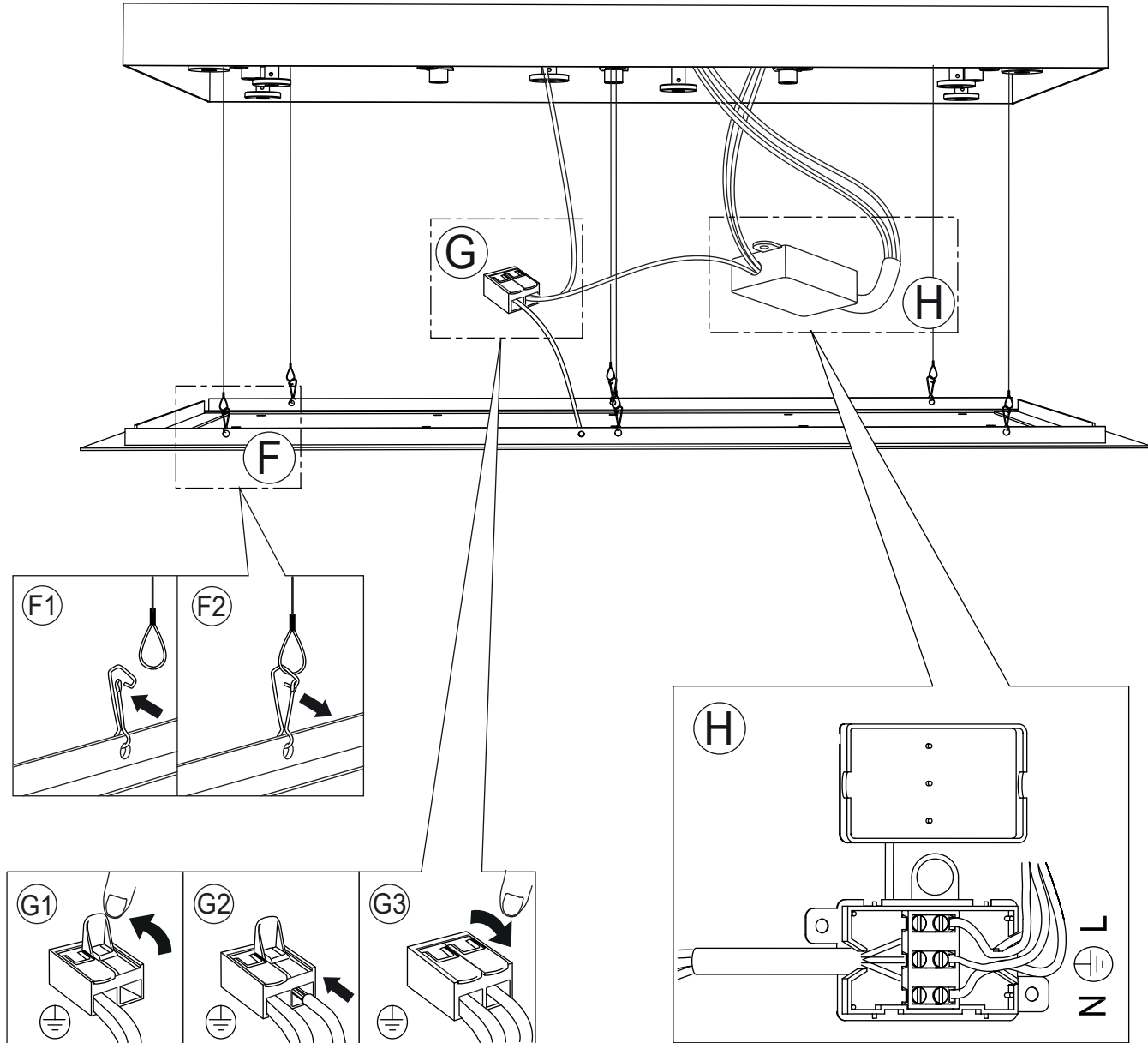
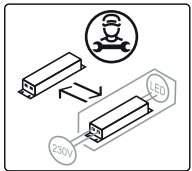
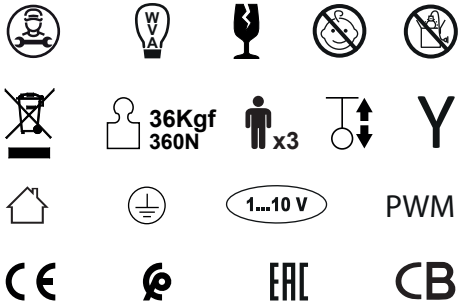

TERZANI

LA LUCE PENSATA

MIZU

CODE 0R15S -- FRL

220-240V ~ 50/60Hz MAX 30W

15xMAX 2W G4 12Vdc

LED

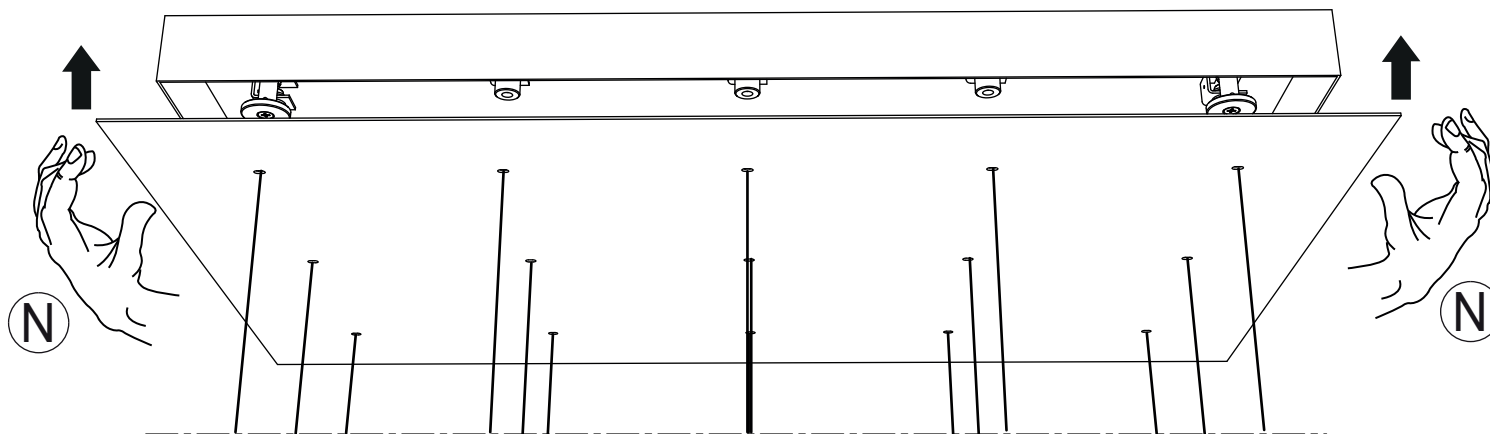
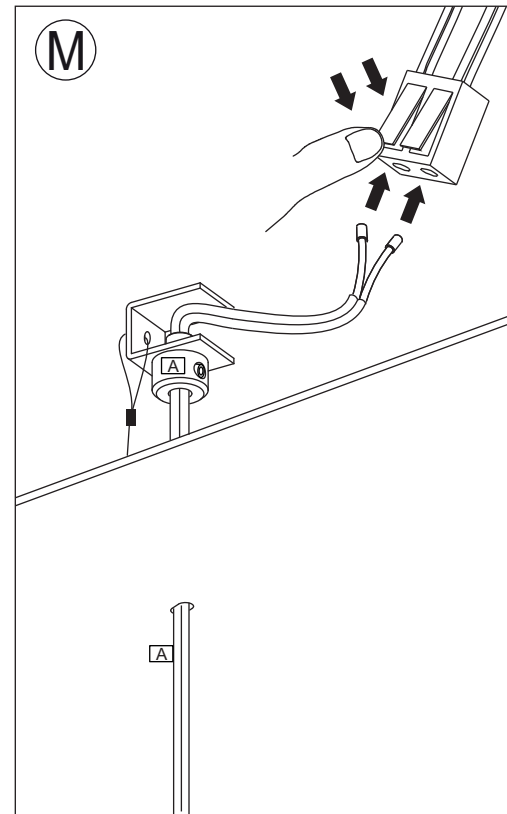
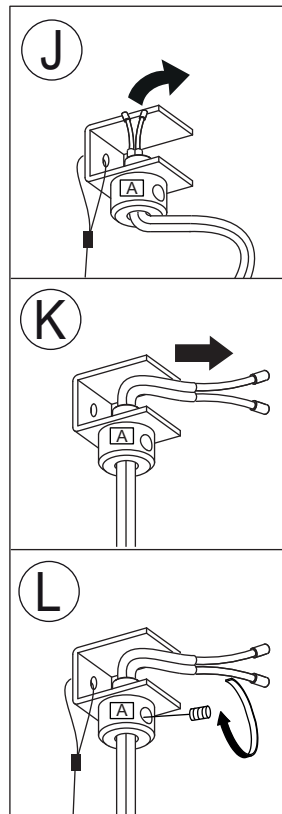
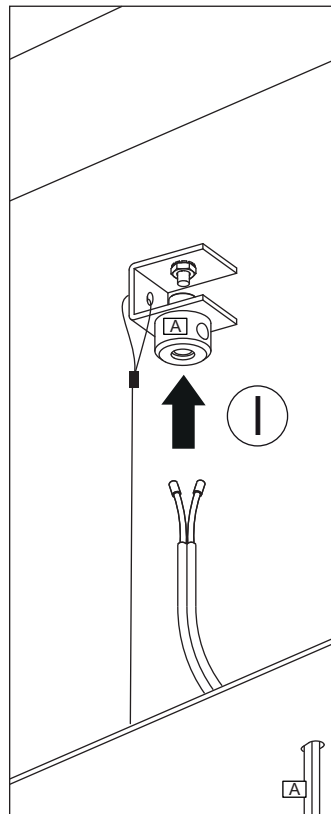
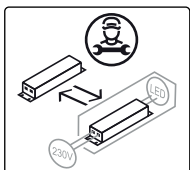

MIZU

CODE 0R15S -- -- FRL

220-240V ~ 50/60Hz MAX 30W

15xMAX 2W G4 12Vdc

LED

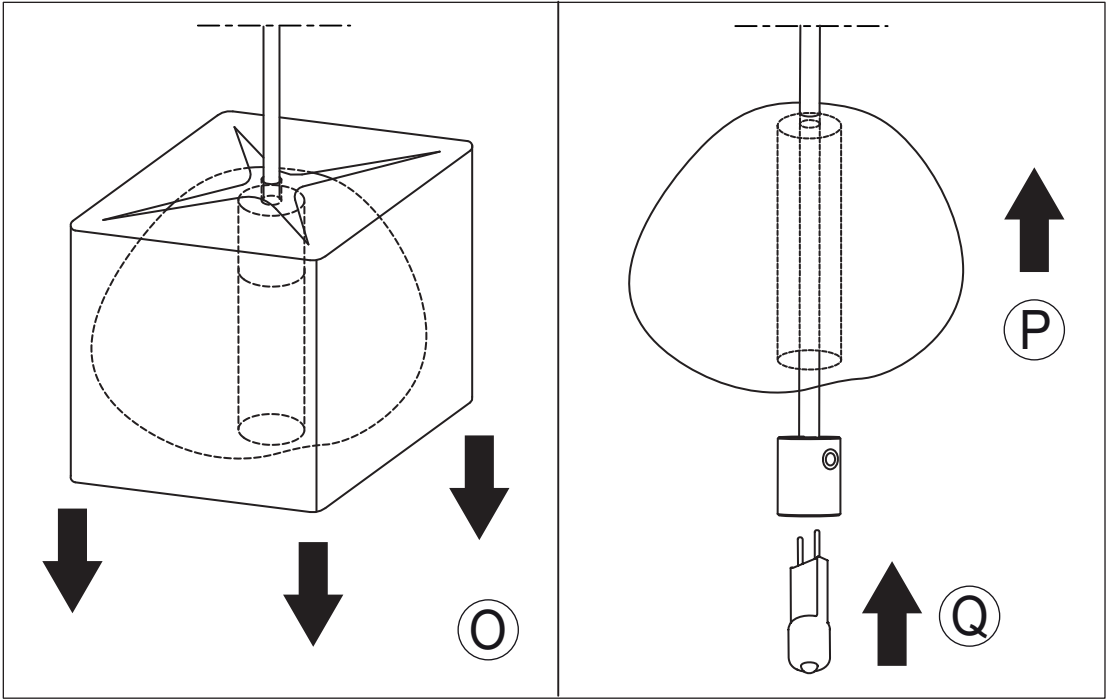
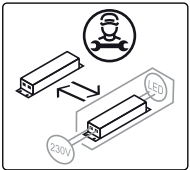

CAUTION!

IT
questo prodotto non è compatibile con le lampadine LED G4 12V a marchio Beghelli

UK
this product is not compatible with Beghelli branded G4 12V LED bulbs

FR
cet produit n'est pas compatible avec les ampoules LED G4 12V marquée Beghelli

DE
Das Produkt ist nicht kompatibel mit LED G4 12V Leuchtmittel Beghelli

RU
Это изделие не совместимо со светодиодными лампами LED Beghelli G4 12V

عربي
هذا المنتج لا يتوافق مع مصابيح ليد LED G4 12V من نوع بيغيلي Beghelli

CLEANING INSTRUCTIONS

YES

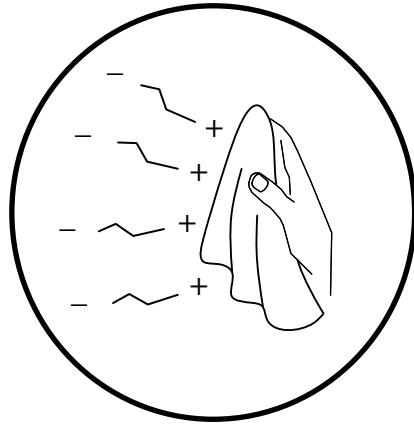

- IT** Usare panno elettrostatico asciutto
UK Use dry electrostatic cloth
FR Utiliser un chiffon électrostatique sec
DE Verwenden sie ein trockenes elektrostattuch
PY Использовать сухую электростатическую ткань
عربي استخدم قطعة قماش جافة كهرباء

NO

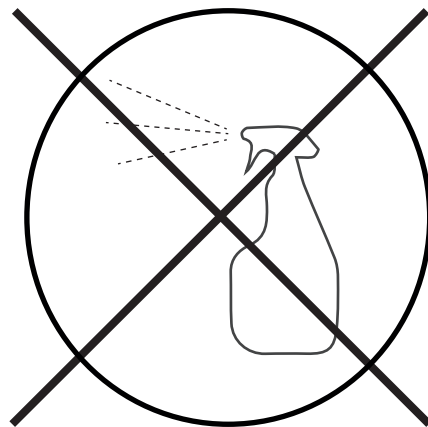

- IT** Non usare prodotti chimici | Usare prodotti specifici solo per cristalli e vetri
UK Do not use chemical products | Use specific products only for crystals and glass
FR Ne pas utiliser des produits chimiques | N'utiliser des produits spécifiques que pur les cristaux et le verre
DE Verwenden Sie keine Chemikalien | Verwenden Sie bitte nur Glas-bzw Kristallreiniger
PY Нельзя использовать химикаты | Использовать только специальные средства для хрусталя и стекла
عربي لا تستخدم المنتجات الكيماوية | استعمل مواد مخصصة للكريستال والزجاج فقط



IT Conservare questa istruzione per la manutenzione | **UK** Keep these instructions for maintenance
FR Garder ces instructions pour l'entretien | **DE** Dies Wartungsanleitung ist aufzubewahren
PY Сохраните эту инструкцию по эксплуатации | عربي احتفظ بهذه الإرشادات للصيانة

TERZANI
LA LUCE PENSATA

Mizu 15 rectangular multi light pendant
0R15S-FRD

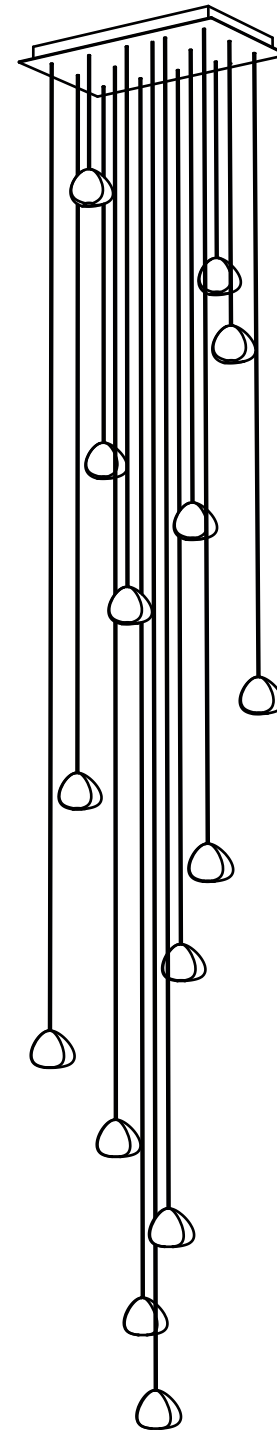

Design Nicolas Terzani



MIZU

CODE 0R15S -- -- FRD

230-240V ~ 50/60Hz MAX 150W

15xMAX 10W G4 12V  

Halogen

or

15xMAX 2W G4 12Vac 

LED

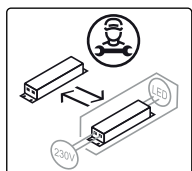

FOLLOW THE LETTERS TO PLACE THE PENDANTS IN THE CORRECT POSITION

TOP VIEW:

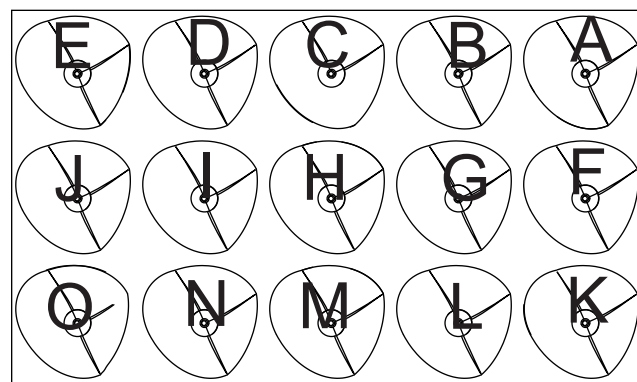
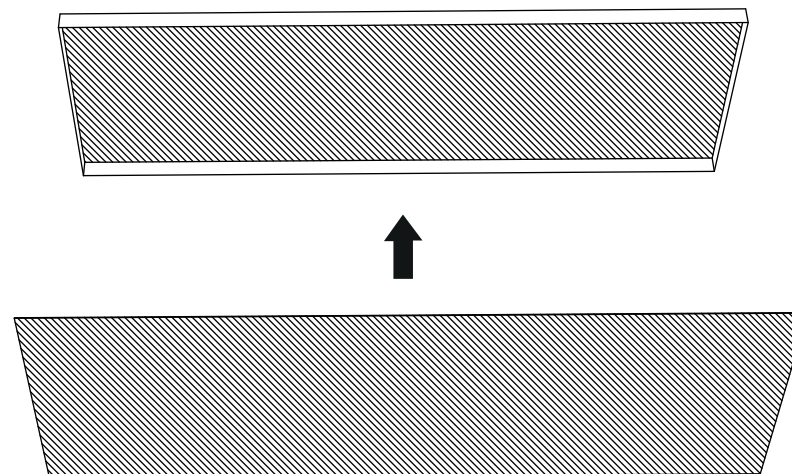

FRONT VIEW





MIZU

CODE 0R15S -- -- FRD

230-240V ~ 50/60Hz MAX 150W

15xMAX 10W G4 12V

Halogen

or

15xMAX 2W G4 12Vac

LED

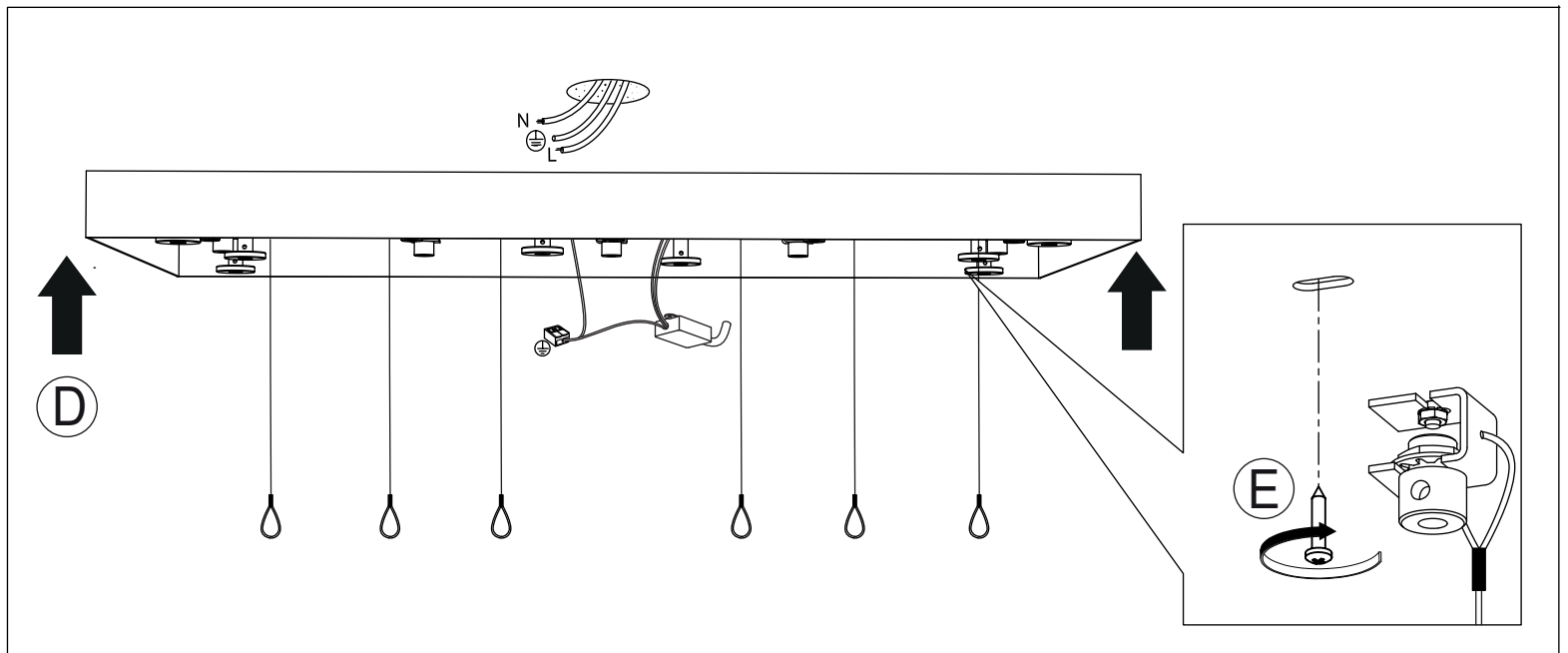
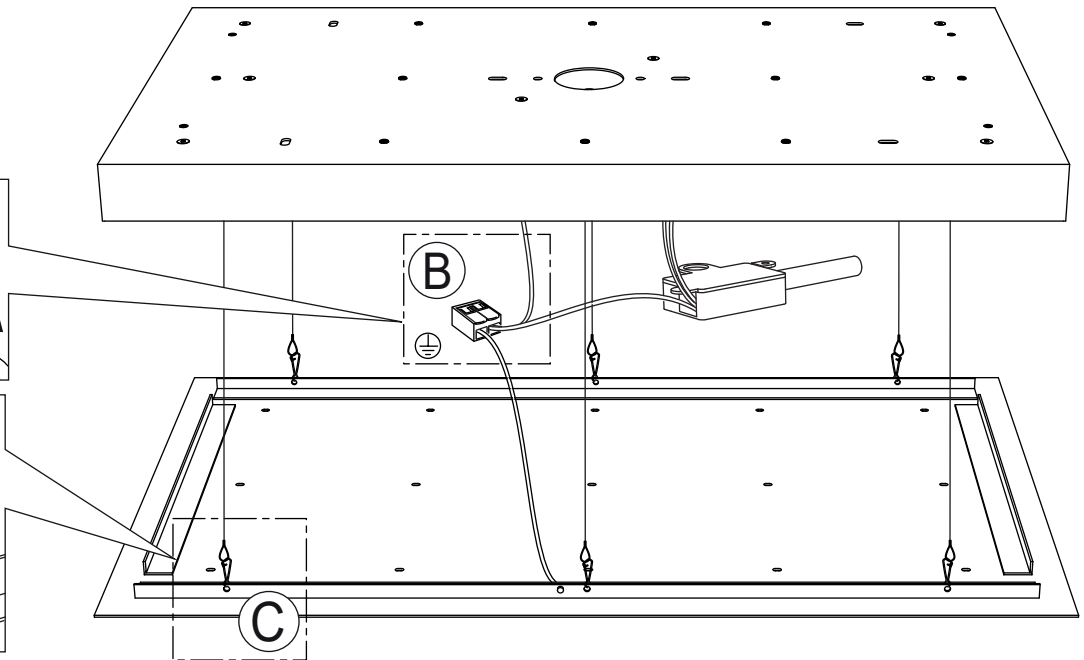
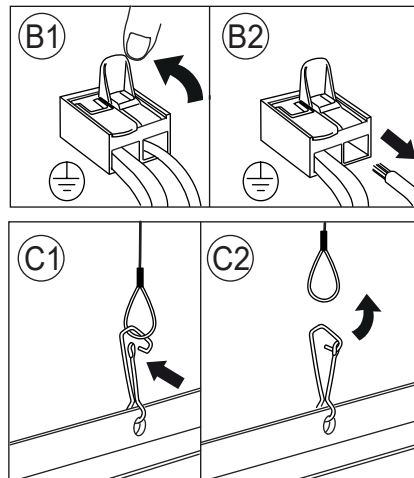
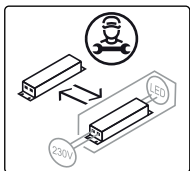

TERZANI

LA LUCE PENSATA

MIZU

CODE 0R15S -- -- FRD

230-240V ~ 50/60Hz MAX 150W

15xMAX 10W G4 12V 

Halogen

or

15xMAX 2W G4 12Vac 

LED



36Kgf
360N

x3



Y

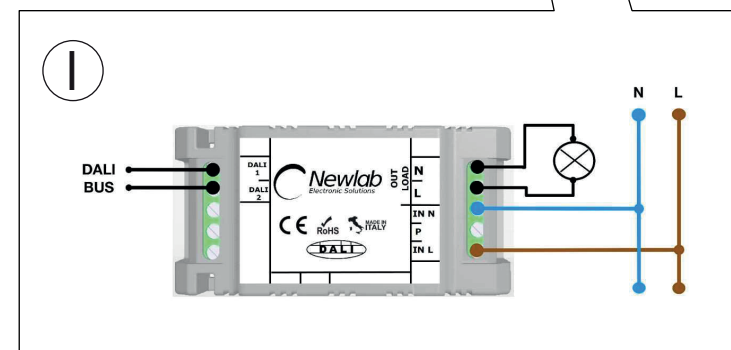
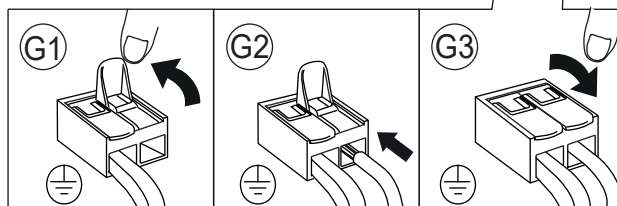
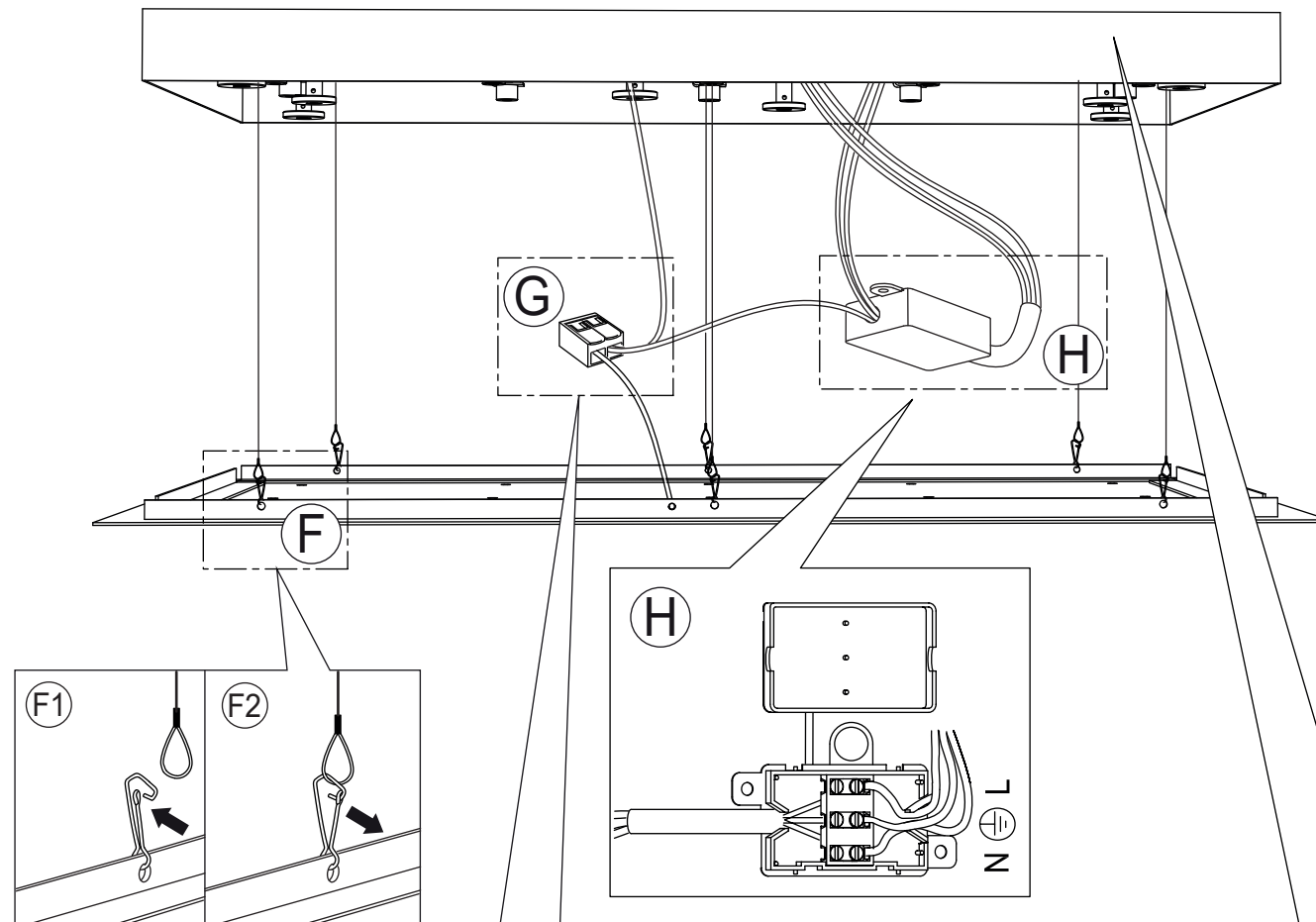
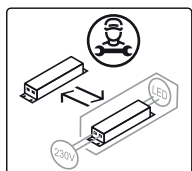

TERZANI

LA LUCE PENSATA

MIZU

CODE 0R15S -- -- FRD

230-240V ~ 50/60Hz MAX 150W

15xMAX 10W G4 12V

Halogen

or

15xMAX 2W G4 12Vac

LED

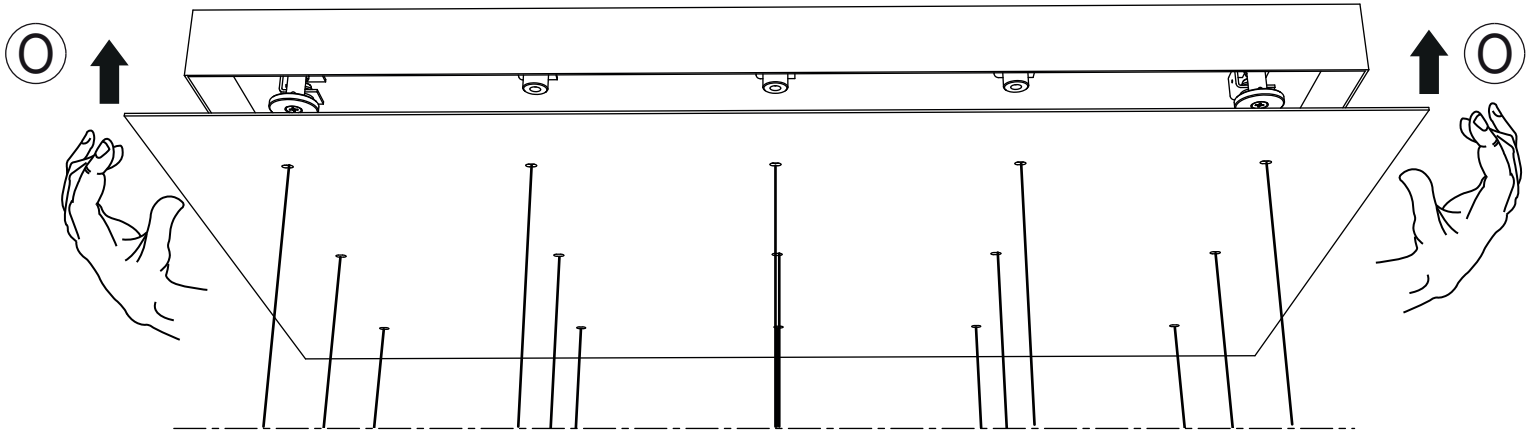
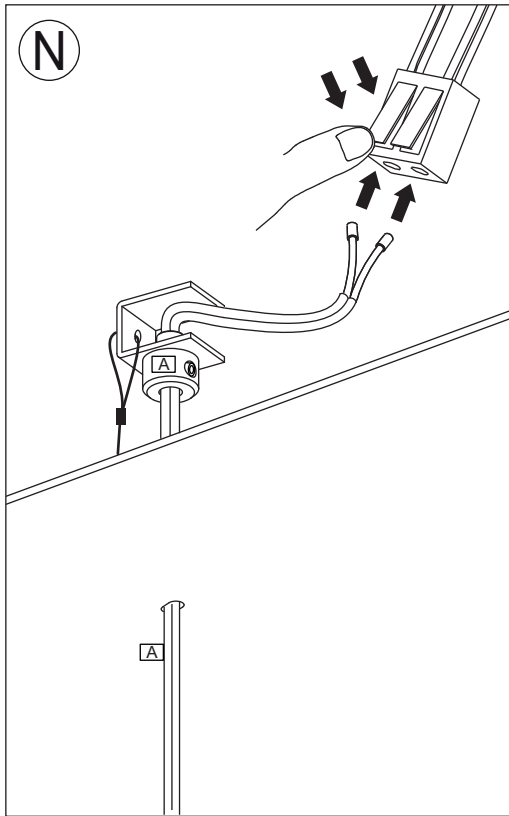
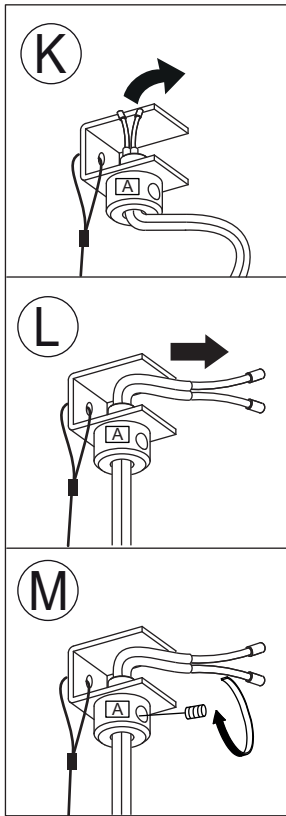
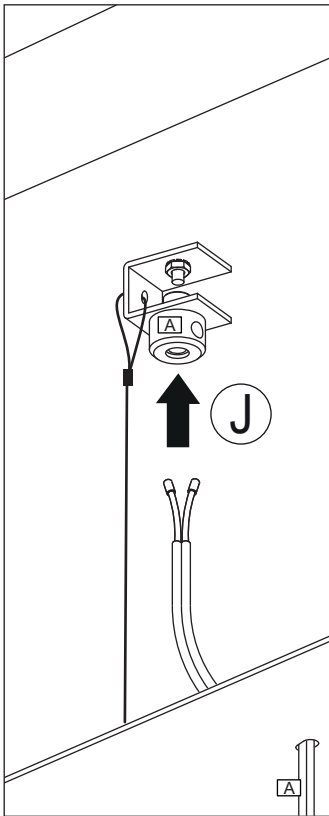
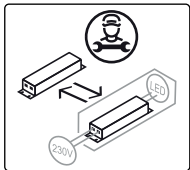

TERZANI
LA LUCE PENSATA

MIZU

CODE 0R15S -- -- FRD

230-240V ~ 50/60Hz MAX 150W

15xMAX 10W G4 12V  

Halogen

or

15xMAX 2W G4 12Vac 

LED

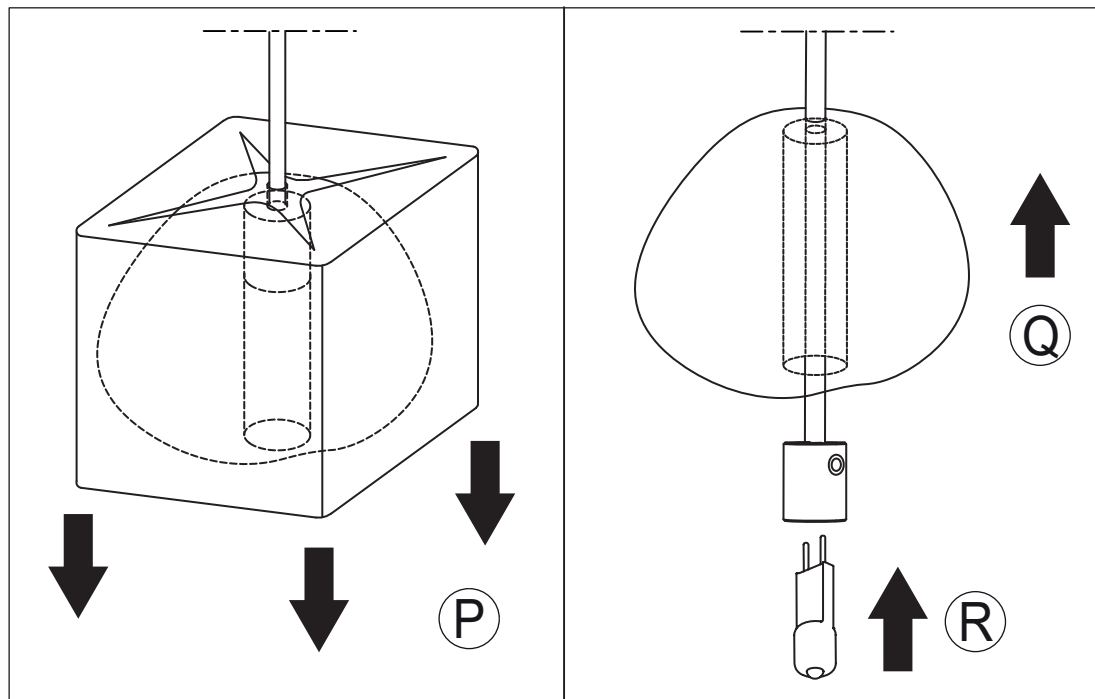
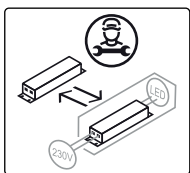

CAUTION!

IT
questo prodotto non
è compatibile con le
lampadine LED G4
12V a marchio
Beghelli

UK
this product is not
compatible with
Beghelli branded G4
12V LED bulbs

FR
cet produit n'est pas
compatible avec les
ampoules LED G4
12V marquée
Beghelli

DE
Das Produkt ist nicht
kompatibel mit LED
G4 12V Leuchtmittel
Beghelli

RU
Это изделие не
совместимо со
светодиодными
лампами LED Beghelli
G4 12V

عربي
هذا المنتج لا يتوافق مع
مصابيح LED G4 12V
من نوع بيغيلي Beghelli

CLEANING INSTRUCTIONS

YES

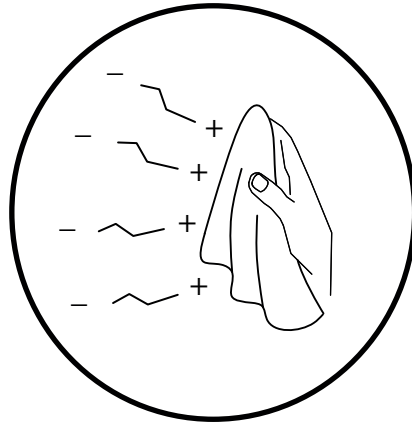

- IT** Usare panno elettrostatico asciutto
UK Use dry electrostatic cloth
FR Utiliser un chiffon électrostatique sec
DE Verwenden sie ein trockenes elektrostattuch
PY Использовать сухую электростатическую ткань
عربي استخدم قطعة قماش جافة كهرباء

NO

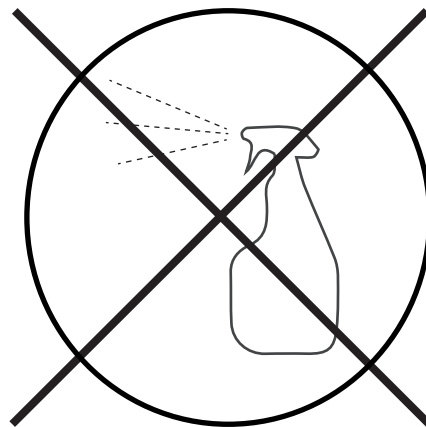

- IT** Non usare prodotti chimici | Usare prodotti specifici solo per cristalli e vetri
UK Do not use chemical products | Use specific products only for crystals and glass
FR Ne pas utiliser des produits chimiques | N'utiliser des produits spécifiques que pur les cristaux et le verre
DE Verwenden Sie keine Chemikalien | Verwenden Sie bitte nur Glas-bzw Kristallreiniger
PY Нельзя использовать химикаты | Использовать только специальные средства для хрусталя и стекла
عربي لا تستخدم المنتجات الكيماوية | استعمل مواد مخصصة للكريستال والزجاج فقط



IT Conservare questa istruzione per la manutenzione | **UK** Keep these instructions for maintenance
FR Garder ces instructions pour l'entretien | **DE** Diese Wartungsanleitung ist aufzubewahren
PY Сохраните эту инструкцию по эксплуатации | عربي احتفظ بهذه الإرشادات للصيانة

TERZANI
LA LUCE PENSATA

Mizu 15 rectangular multi light pendant

0R15S-FRE

0R15S-FREW

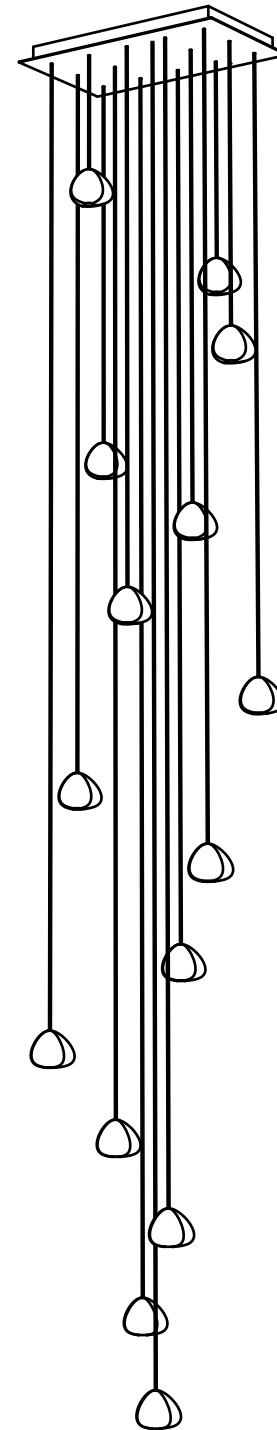



MIZU

CODE 0R15S -- -- FRE
3000K

CODE 0R15S -- -- FREW
2700K

220-240V ~ 50/60Hz MAX 22,5W

500mA 15xMAX 1,5W

integrated LED

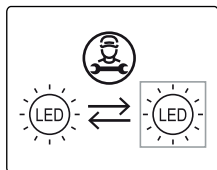
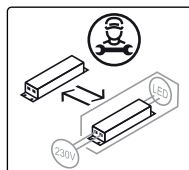

FOLLOW THE LETTERS TO PLACE THE PENDANTS IN THE CORRECT POSITION

TOP VIEW:

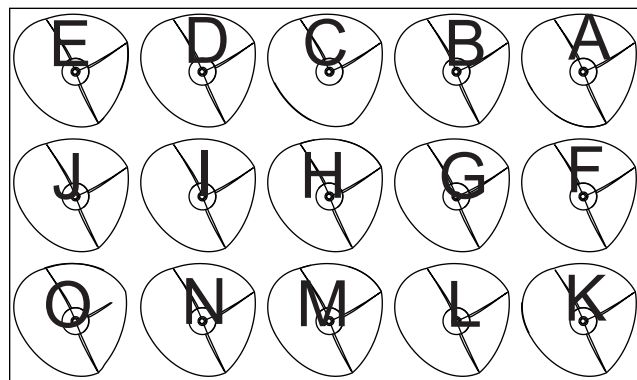
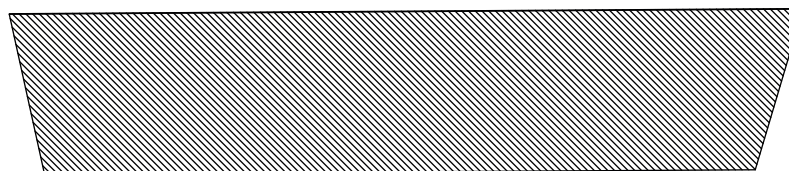
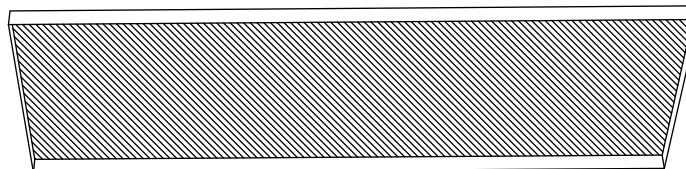

FRONT VIEW





MIZU

CODE 0R15S -- -- FRE
3000K

CODE 0R15S -- -- FREW
2700K

220-240V ~ 50/60Hz MAX 22,5W

500mA 15xMAX 1,5W

integrated LED

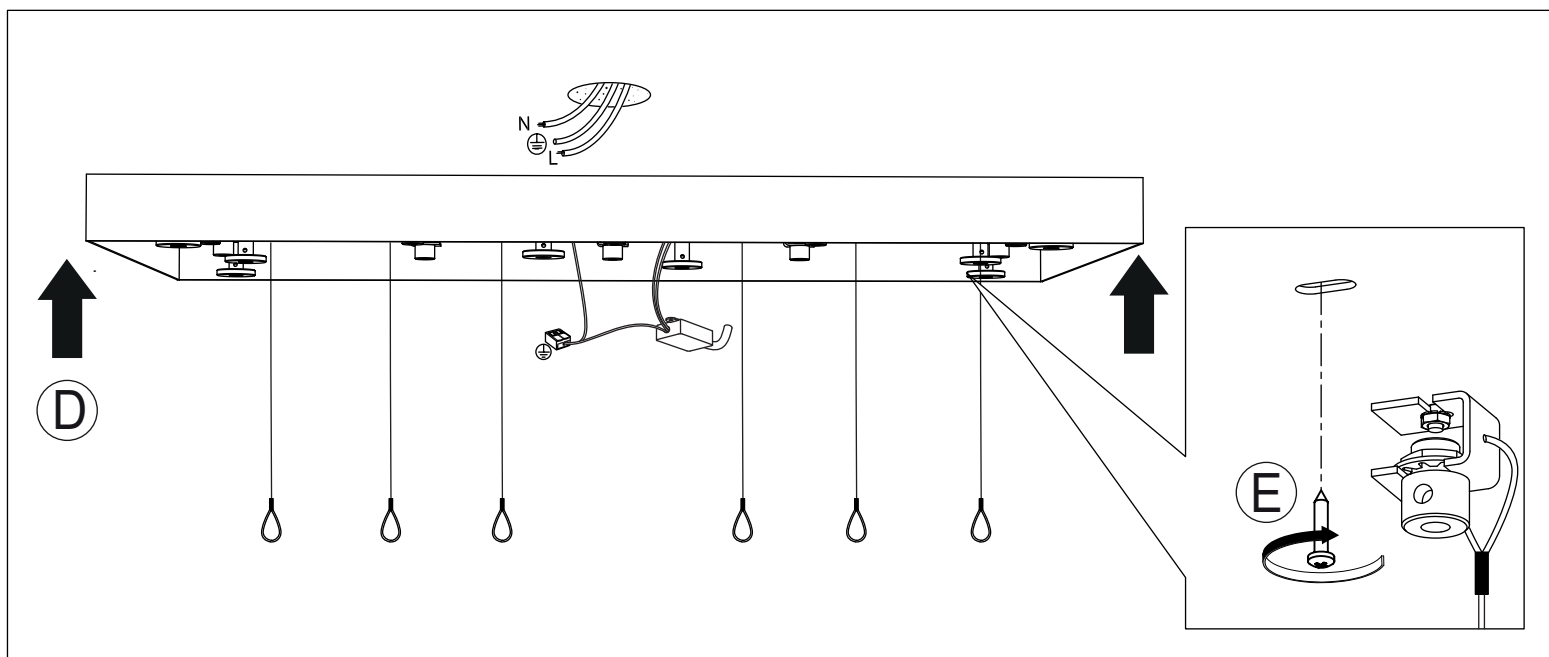
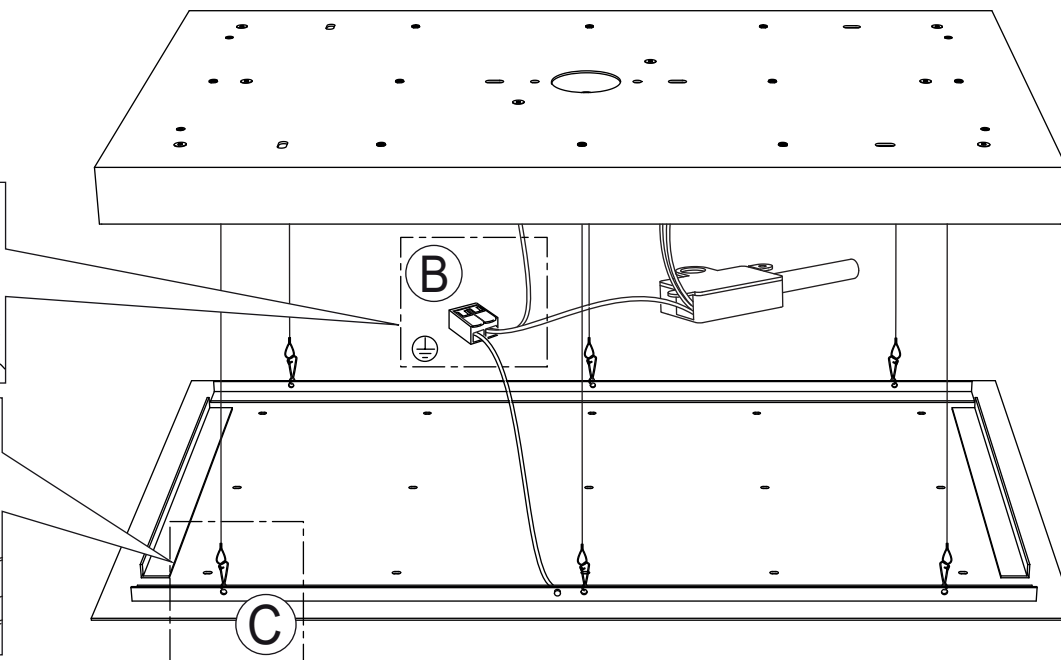
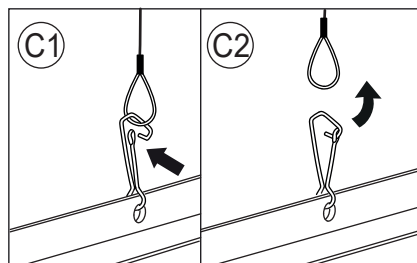
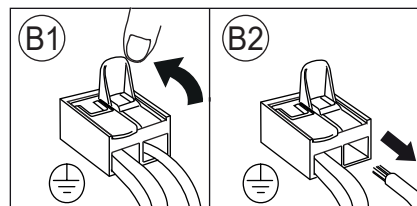
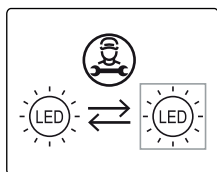
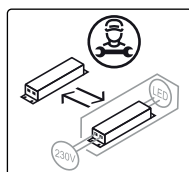
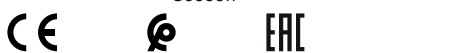

TERZANI

LA LUCE PENSATA

MIZU

CODE 0R15S -- -- FRE
3000K

CODE 0R15S -- -- FREW
2700K

220-240V ~ 50/60Hz MAX 22,5W

500mA 15xMAX 1,5W

integrated LED

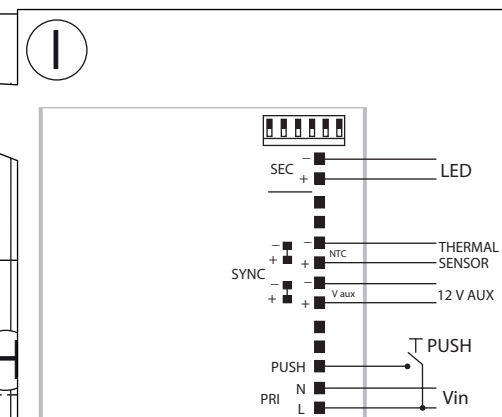
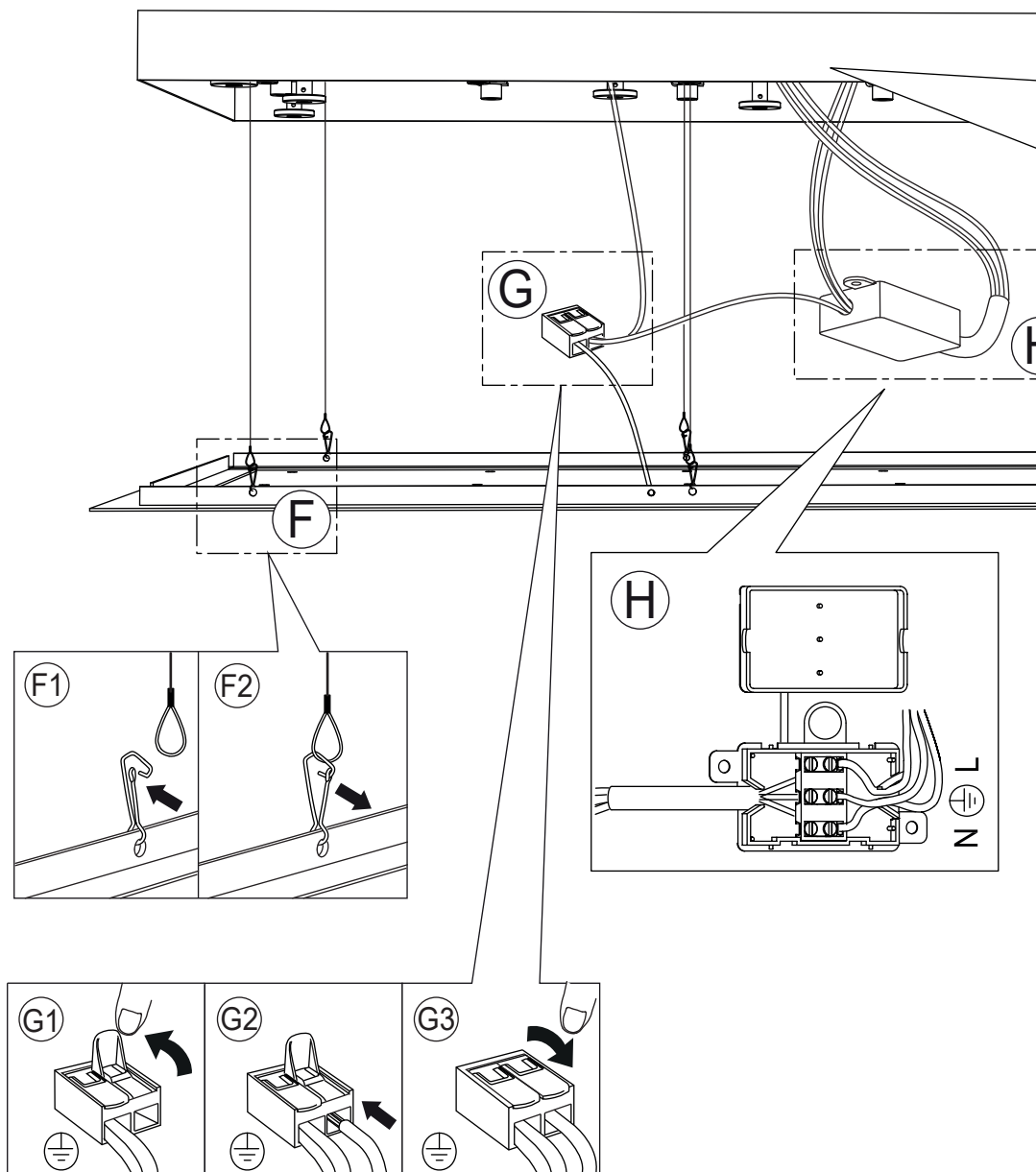
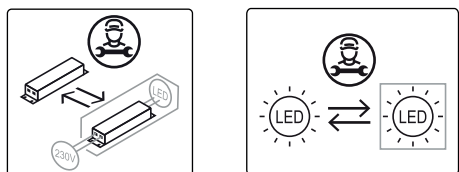
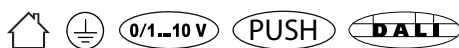

PUSH diagram

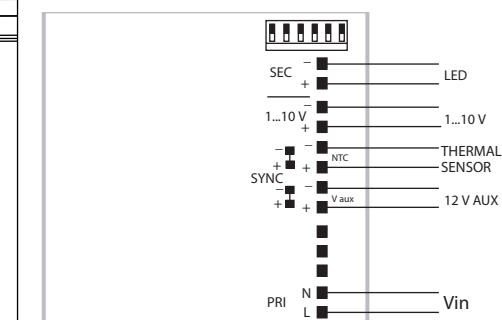

1...10 V diagram

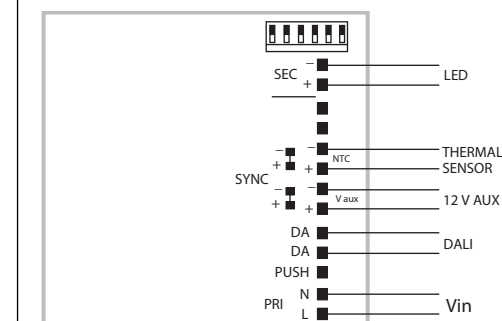

DALI diagram

TERZANI

LA LUCE PENSATA

MIZU

CODE 0R15S -- -- FRE
3000K

CODE 0R15S -- -- FREW
2700K

220-240V ~ 50/60Hz MAX 22,5W

500mA 15xMAX 1,5W

integrated LED

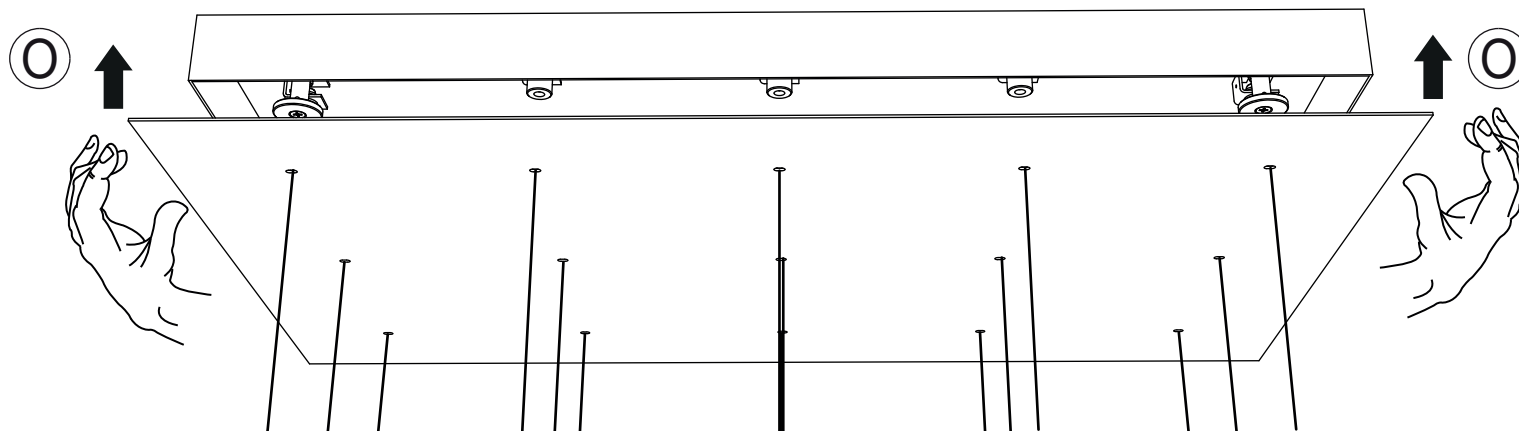
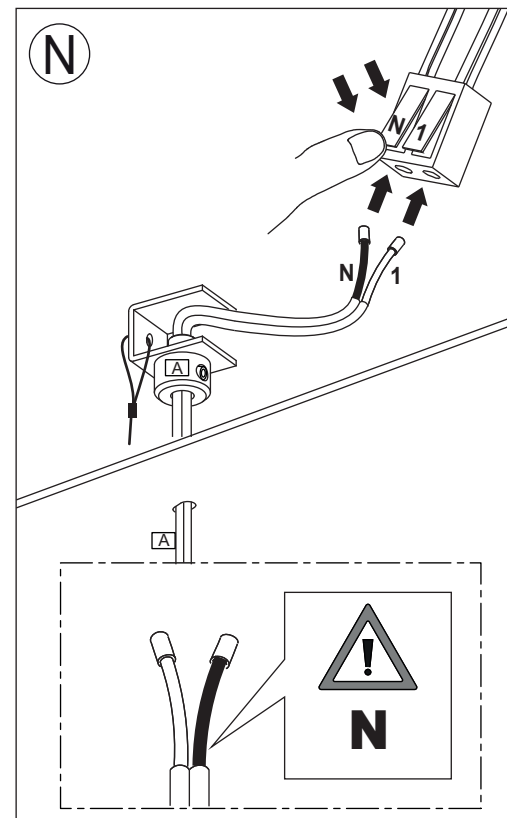
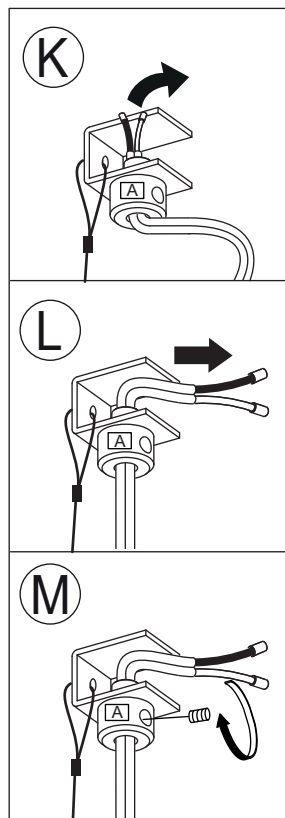
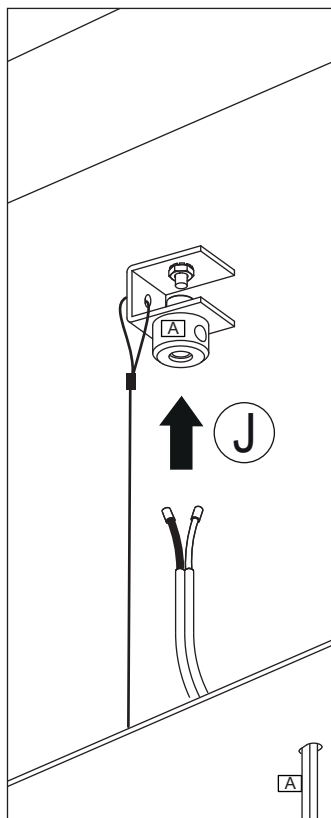
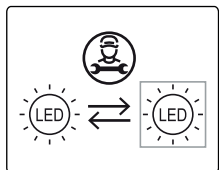
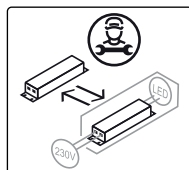



MIZU

CODE 0R15S -- -- FRE
3000K

CODE 0R15S -- -- FREW
2700K

220-240V ~ 50/60Hz MAX 22,5W

500mA 15xMAX 1,5W

integrated LED

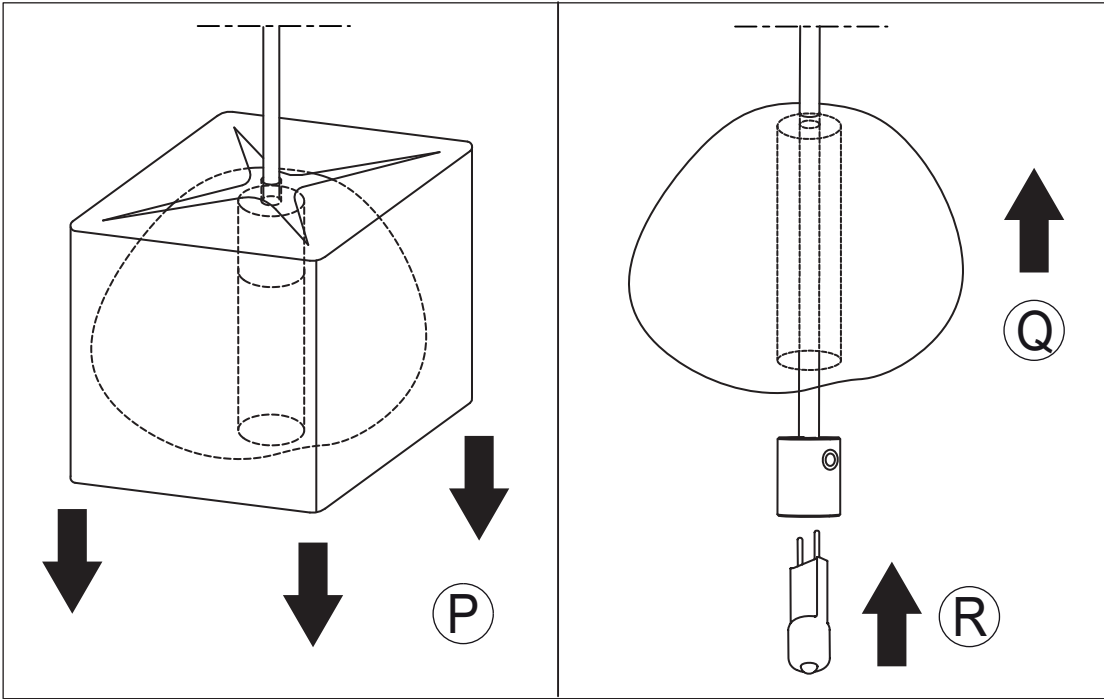
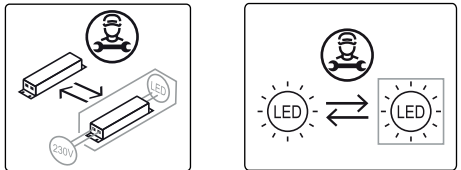
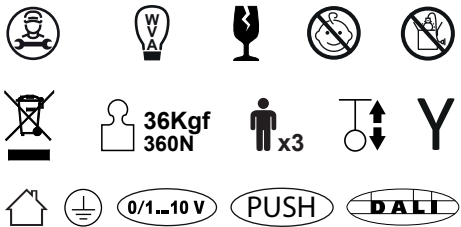

CAUTION!

IT
questo prodotto non
è compatibile con le
lampadine LED G4
12V a marchio
Beghelli

UK
this product is not
compatible with
Beghelli branded G4
12V LED bulbs

FR
cet produit n'est pas
compatible avec les
ampoules LED G4
12V marquée
Beghelli

DE
Das Produkt ist nicht
kompatibel mit LED
G4 12V Leuchtmittel
Beghelli

RU
Это изделие не
совместимо со
светодиодными
лампами LED Beghelli
G4 12V

عربي
هذا المنتج لا يتوافق مع
مصابيح LED G4 12V
من نوع بيغيلي Beghelli

CLEANING INSTRUCTIONS

YES

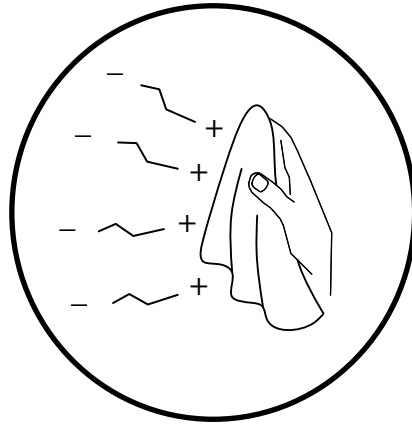

- IT** Usare panno elettrostatico asciutto
UK Use dry electrostatic cloth
FR Utiliser un chiffon électrostatique sec
DE Verwenden sie ein trockenes elektrostattuch
PY Использовать сухую электростатическую ткань
عربي استخدم قطعة قماش جافة كهرباء

NO

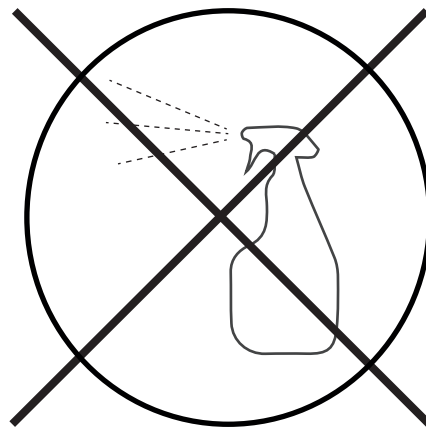

- IT** Non usare prodotti chimici | Usare prodotti specifici solo per cristalli e vetri
UK Do not use chemical products | Use specific products only for crystals and glass
FR Ne pas utiliser des produits chimiques | N'utiliser des produits spécifiques que pur les cristaux et le verre
DE Verwenden Sie keine Chemikalien | Verwenden Sie bitte nur Glas-bzw Kristallreiniger
PY Нельзя использовать химикаты | Использовать только специальные средства для хрусталя и стекла
عربي لا تستخدم المنتجات الكيماوية | استعمل مواد مخصصة للكريستال والزجاج فقط



IT Conservare questa istruzione per la manutenzione | **UK** Keep these instructions for maintenance
FR Garder ces instructions pour l'entretien | **DE** Diese Wartungsanleitung ist aufzubewahren
PY Сохраните эту инструкцию по эксплуатации | عربي احتفظ بهذه الإرشادات للصيانة