

TERZANI
LA LUCE PENSATA

Mizu 7 light pendant

0R07S-F

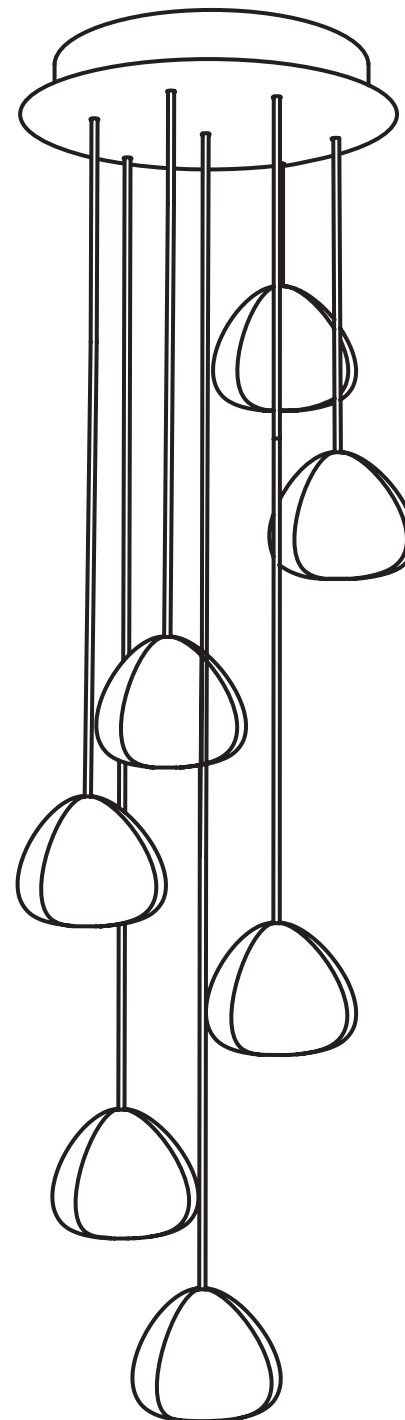

Design Nicolas Terzani



MIZU

CODE 0R07S -- -- F

230-240V ~ 50/60Hz MAX 70W

7xMAX 10W G4 12V  

Halogen

or

7xMAX 2W G4 12Vac 

LED

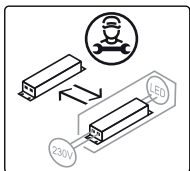

FOLLOW THE LETTERS TO PLACE THE PENDANTS IN THE CORRECT POSITION

TOP VIEW:

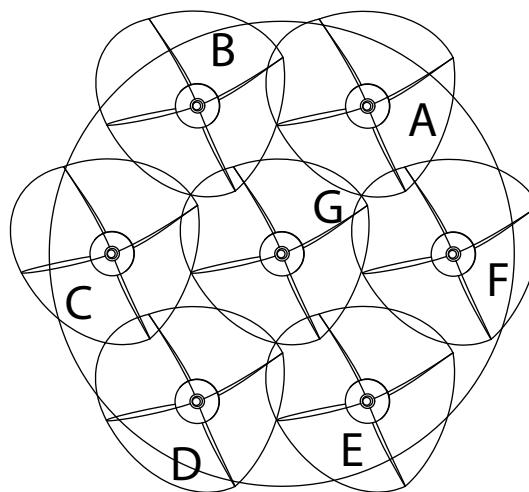
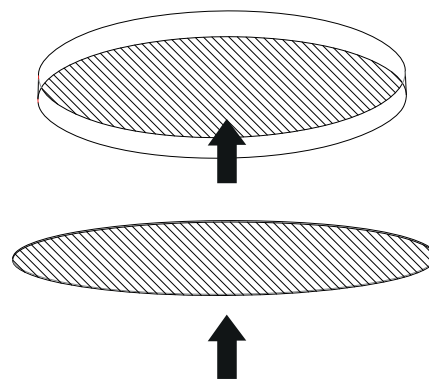

FRONT VIEW





MIZU

CODE 0R07S -- F

230-240V ~ 50/60Hz MAX 70W

7xMAX 10W G4 12V  

Halogen

or

7xMAX 2W G4 12Vac 
LED



15KgF
150N

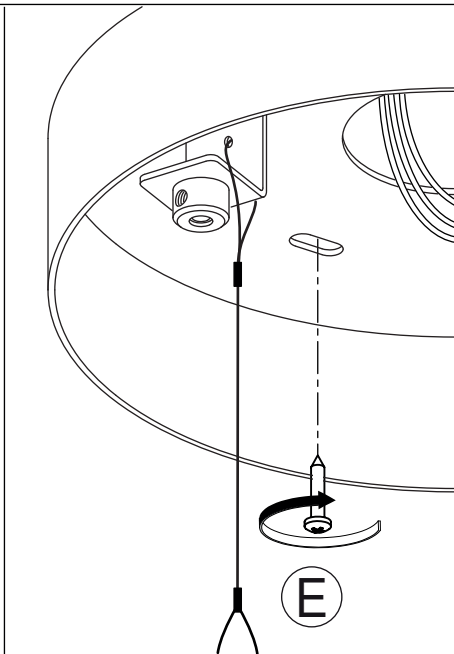
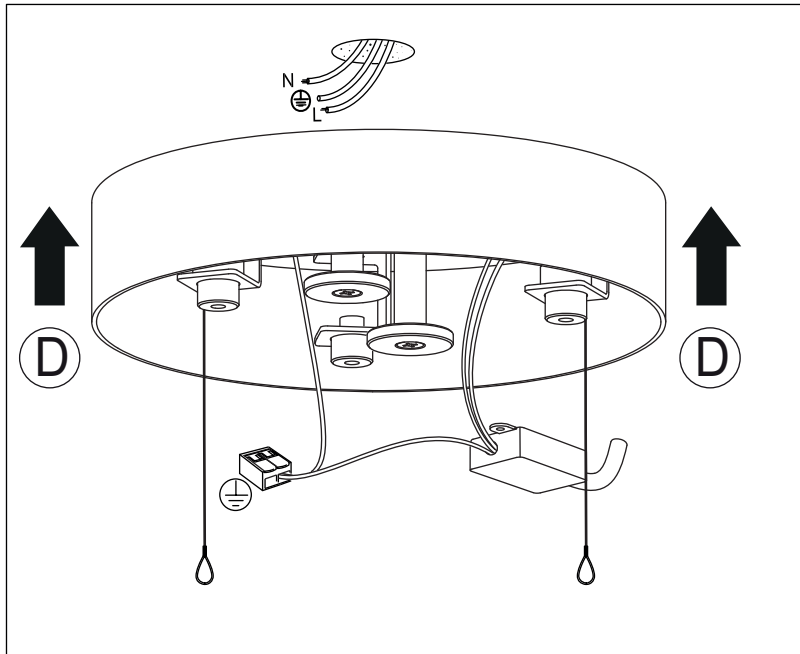
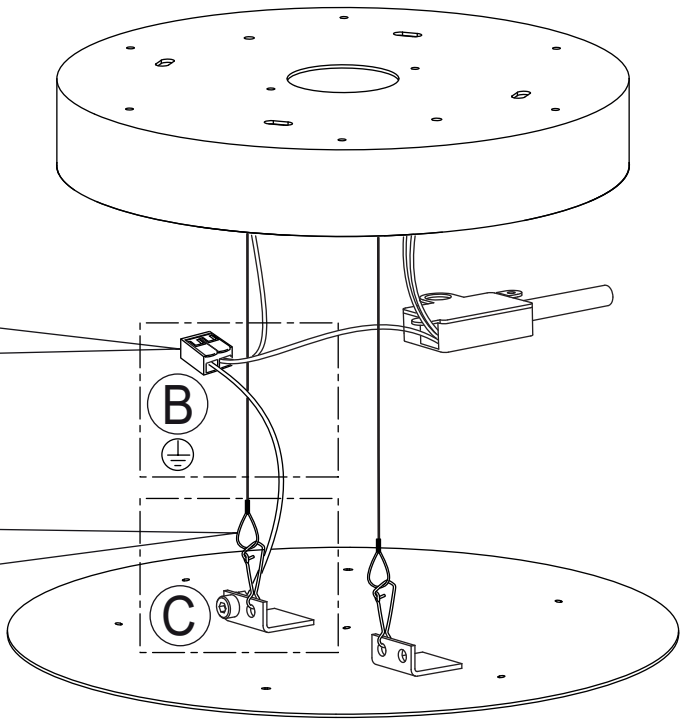
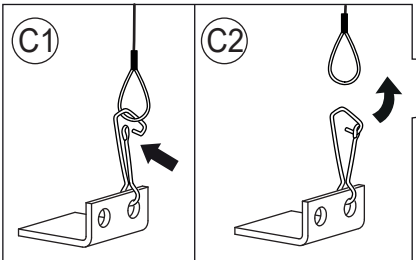
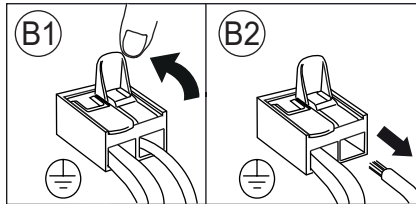
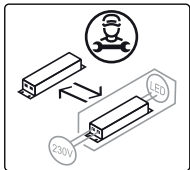

MIZU

CODE 0R07S -- -- F

230-240V ~ 50/60Hz MAX 70W

7xMAX 10W G4 12V  

Halogen

or

7xMAX 2W G4 12Vac 

LED

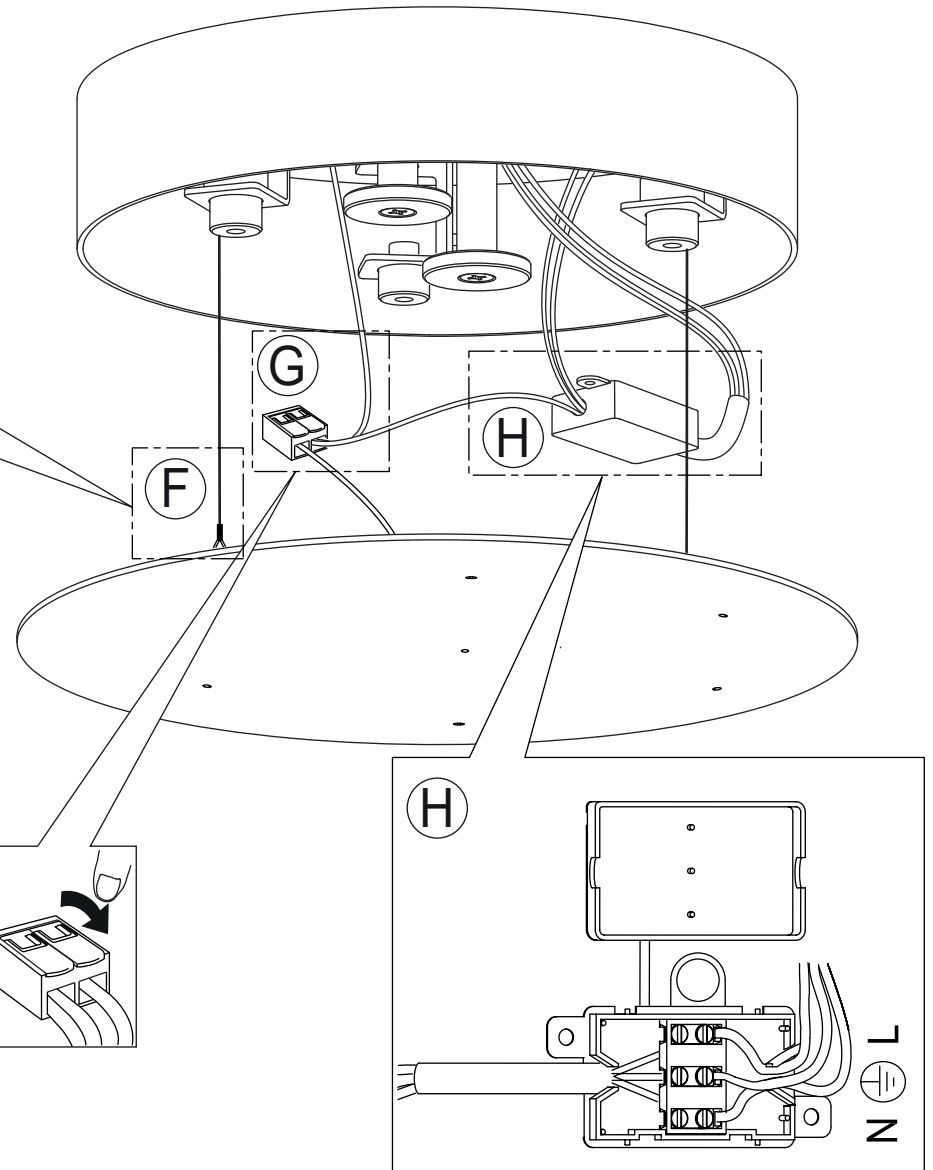
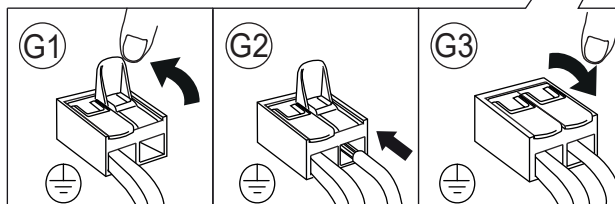
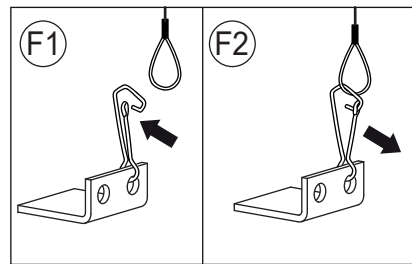
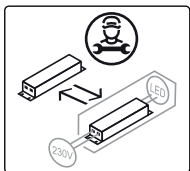

TERZANI

LA LUCE PENSATA

MIZU

CODE 0R07S -- F

230-240V ~ 50/60Hz MAX 70W

7xMAX 10W G4 12V 

Halogen

or

7xMAX 2W G4 12Vac 

LED

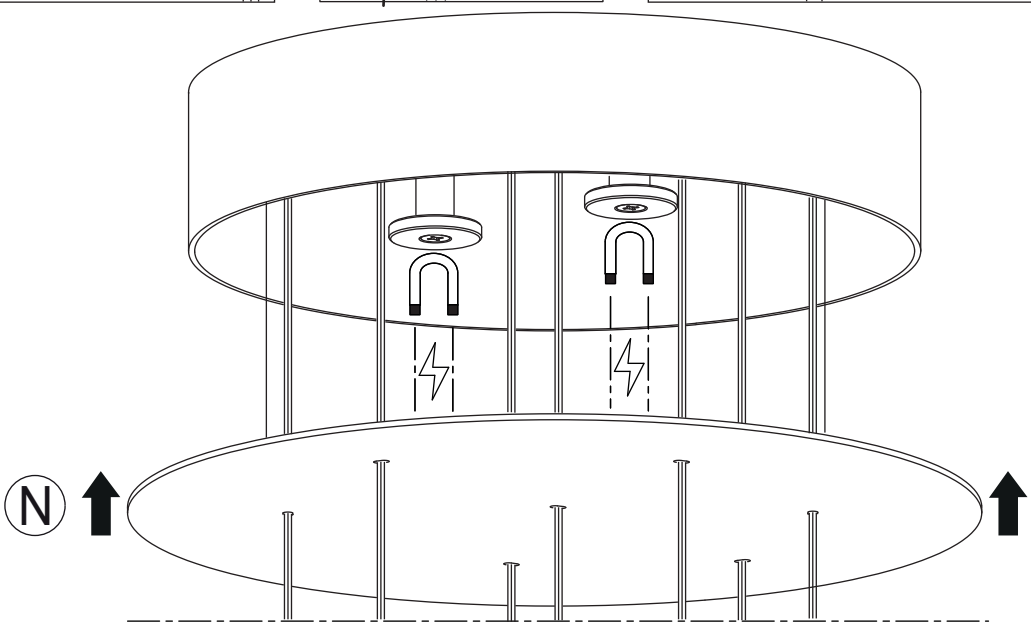
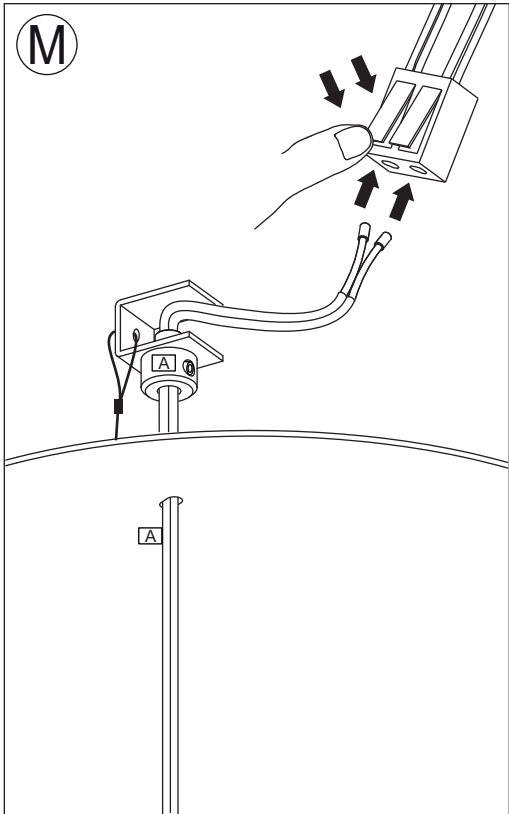
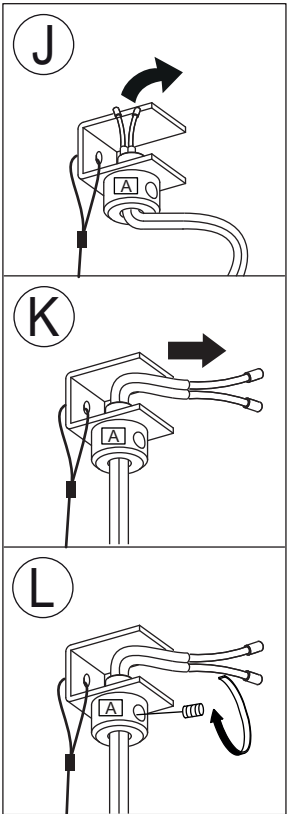
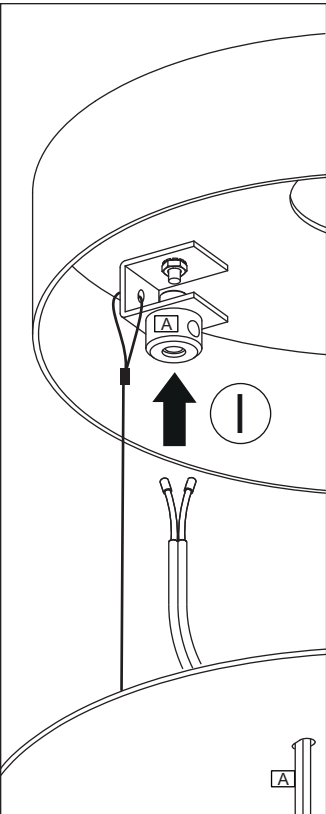
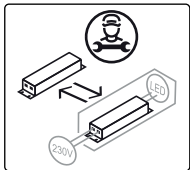

TERZANI
LA LUCE PENSATA

MIZU

CODE 0R07S -- -- F

230-240V ~ 50/60Hz MAX 70W

7xMAX 10W G4 12V



Halogen

or

7xMAX 2W G4 12Vac



LED



**15Kgf
150N**

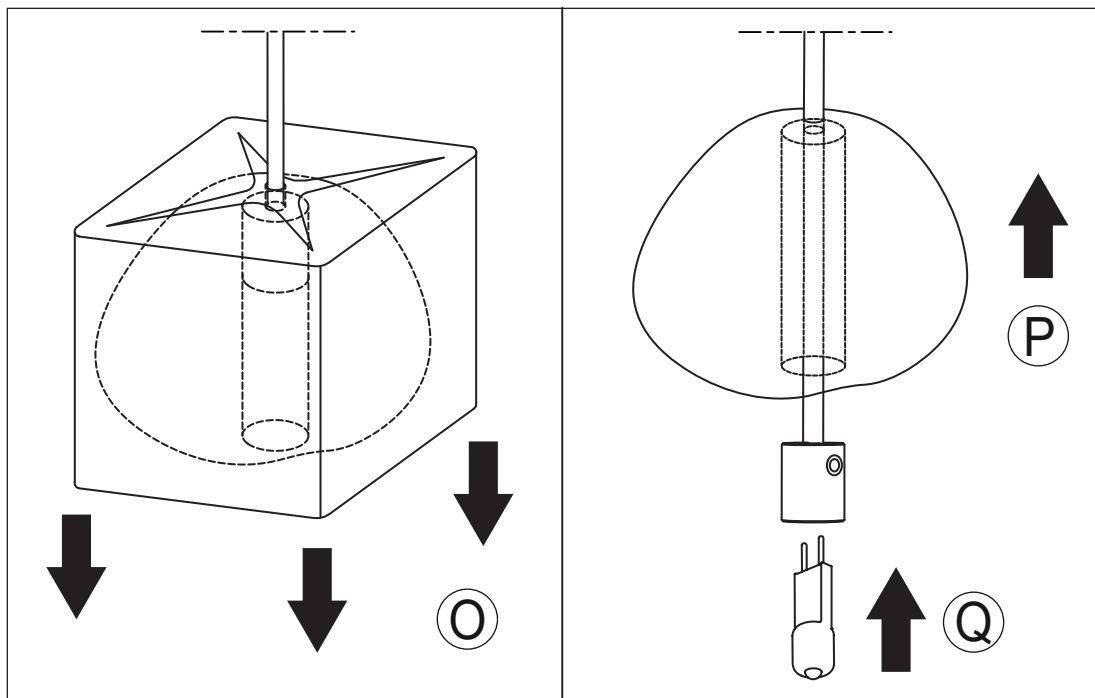
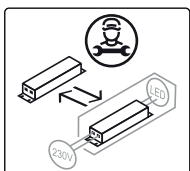

CAUTION!

IT
questo prodotto non
è compatibile con le
lampadine LED G4
12V a marchio
Beghelli

UK
this product is not
compatible with
Beghelli branded G4
12V LED bulbs

FR
cet produit n'est pas
compatible avec les
ampoules LED G4
12V marquée
Beghelli

DE
Das Produkt ist nicht
kompatibel mit LED
G4 12V Leuchtmittel
Beghelli

RU
Это изделие не
совместимо со
светодиодными
лампами LED Beghelli
G4 12V

عربي
هذا المنتج لا يتوافق مع
مصباح LED G4 12V
من نوع بيغيلي Beghelli

CLEANING INSTRUCTIONS

YES

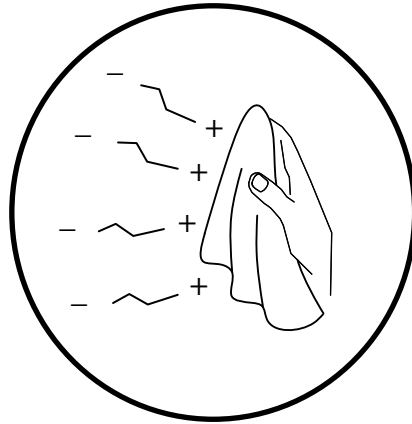

- IT** Usare panno elettrostatico asciutto
UK Use dry electrostatic cloth
FR Utiliser un chiffon électrostatique sec
DE Verwenden sie ein trockenes elektrostattuch
PY Использовать сухую электростатическую ткань
عربي استخدم قطعة قماش جافة كهرباء

NO

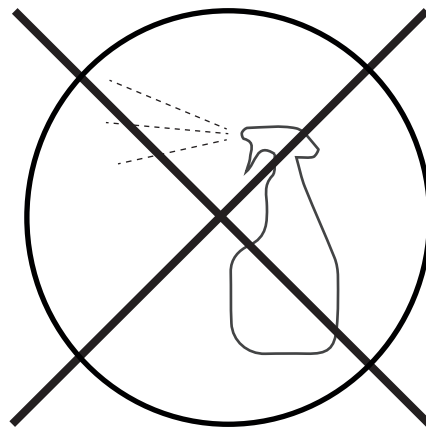

- IT** Non usare prodotti chimici | Usare prodotti specifici solo per cristalli e vetri
UK Do not use chemical products | Use specific products only for crystals and glass
FR Ne pas utiliser des produits chimiques | N'utiliser des produits spécifiques que pur les cristaux et le verre
DE Verwenden Sie keine Chemikalien | Verwenden Sie bitte nur Glas-bzw Kristallreiniger
PY Нельзя использовать химикаты | Использовать только специальные средства для хрусталя и стекла
عربي لا تستخدم المنتجات الكيماوية | استعمل مواد مخصصة للكريستال والزجاج فقط



IT Conservare questa istruzione per la manutenzione | **UK** Keep these instructions for maintenance
FR Garder ces instructions pour l'entretien | **DE** Dies Wartungsanleitung ist aufzubewahren
PY Сохраните эту инструкцию по эксплуатации | عربي احتفظ بهذه الإرشادات للصيانة

TERZANI
LA LUCE PENSATA

Mizu 7 light pendant

0R07S-FL

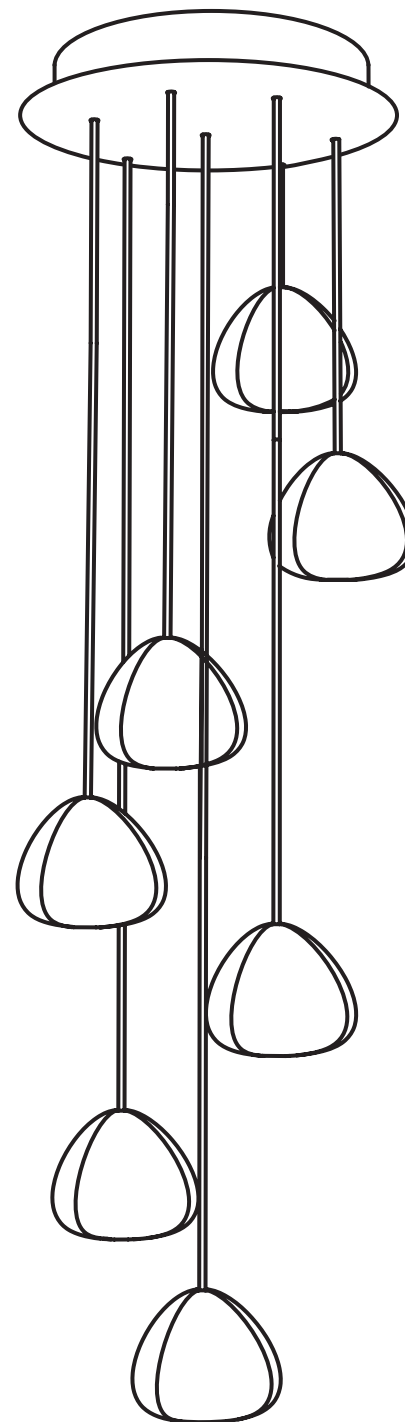

Design Nicolas Terzani



MIZU

CODE 0R07S -- -- FL

220-240V ~ 50/60Hz MAX 14W

7xMAX 2W G4 12Vdc

LED

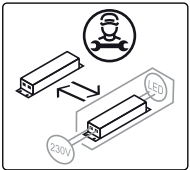

FOLLOW THE LETTERS TO PLACE THE PENDANTS IN THE CORRECT POSITION

TOP VIEW:

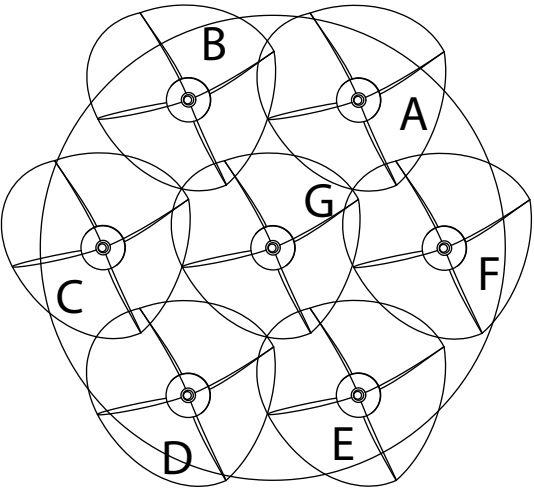
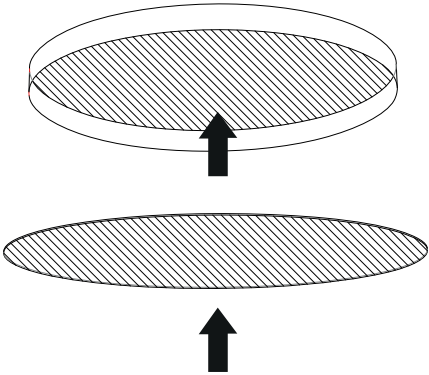

FRONT VIEW





MIZU

CODE 0R07S -- FL

220-240V ~ 50/60Hz MAX 14W

7xMAX 2W G4 12Vdc

LED

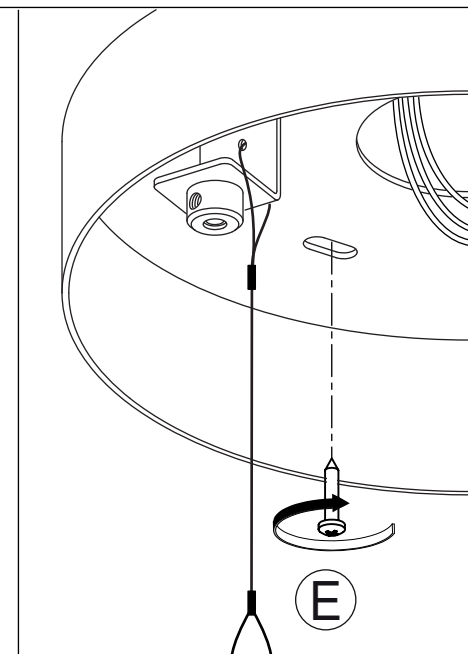
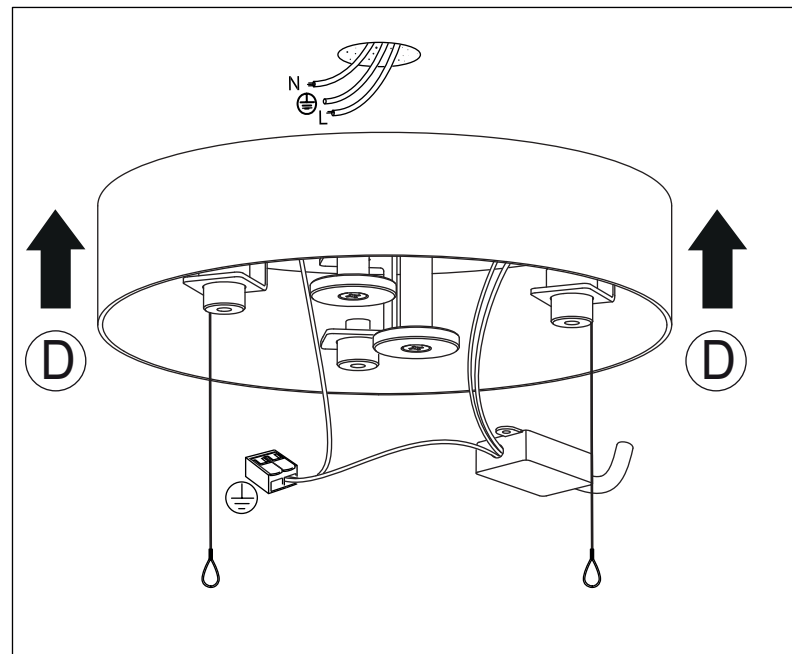
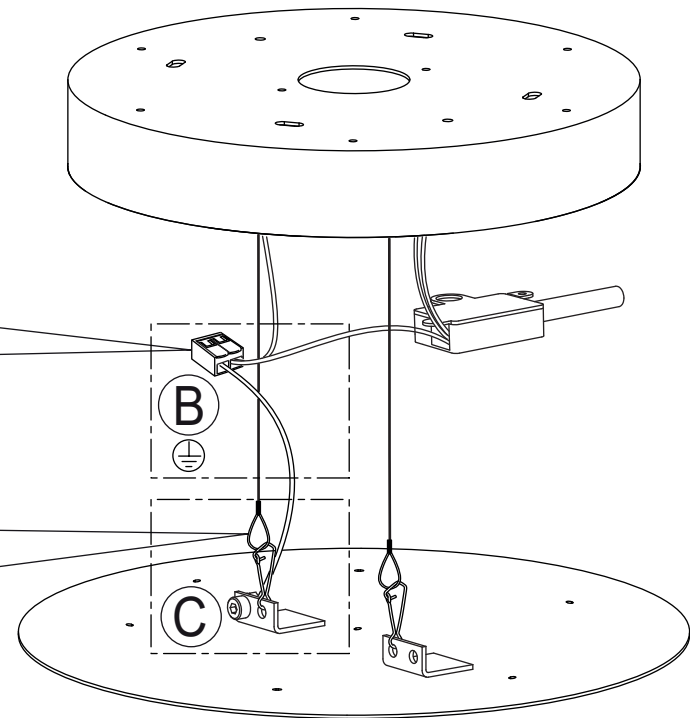
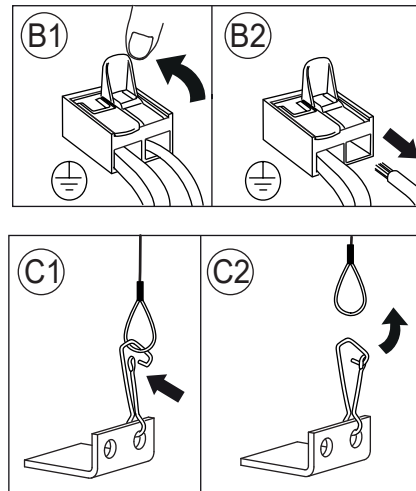
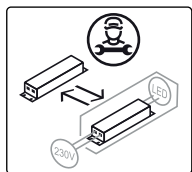

MIZU

CODE 0R07S -- FL

220-240V ~ 50/60Hz MAX 14W

7xMAX 2W G4 12Vdc

LED

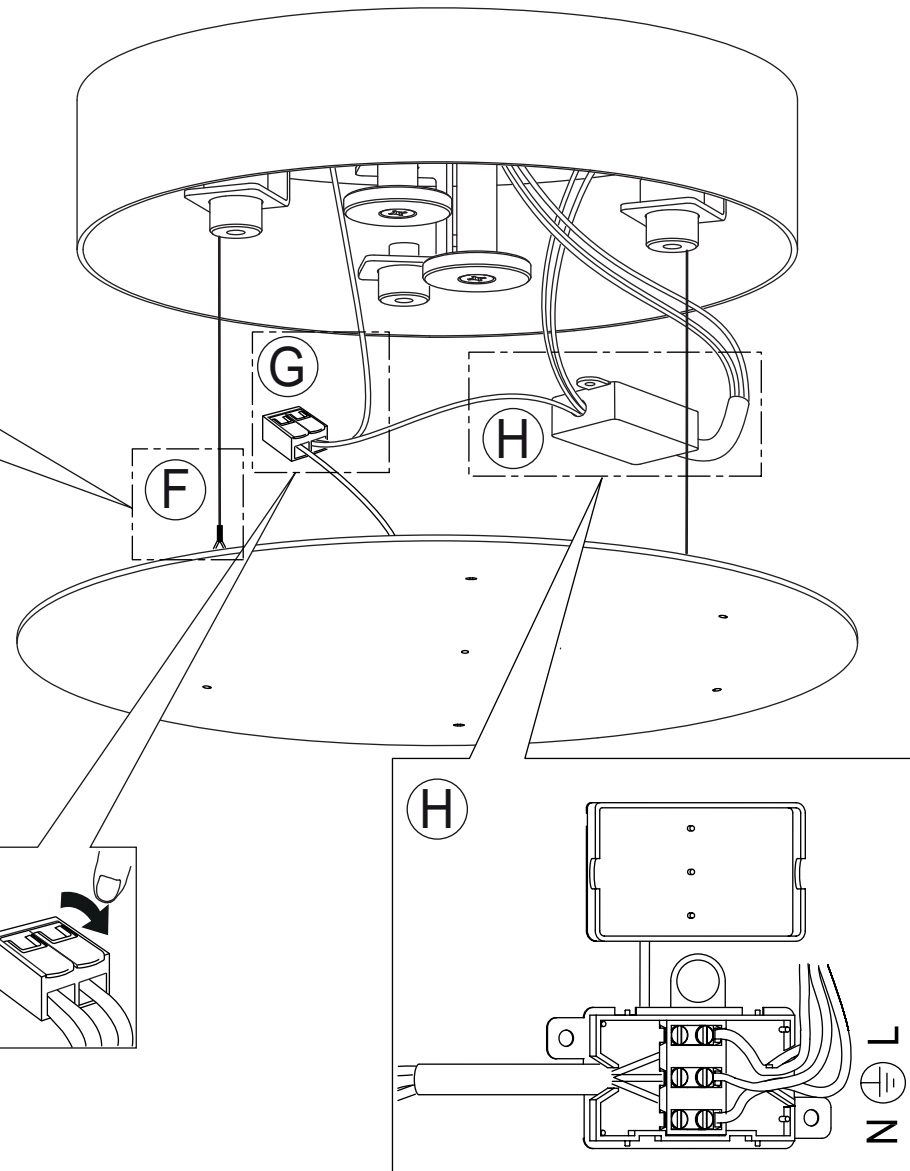
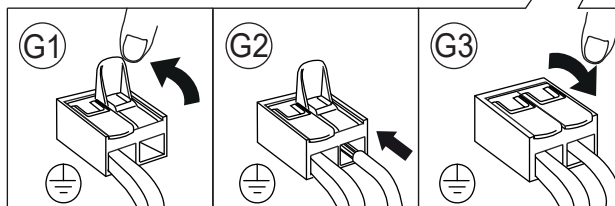
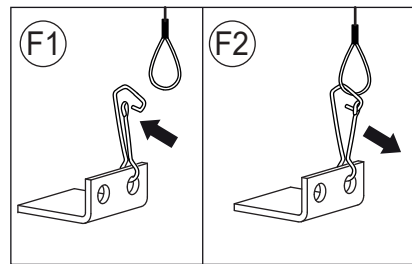
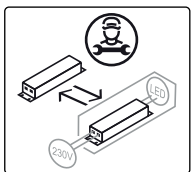

TERZANI

LA LUCE PENSATA

MIZU

CODE 0R07S -- FL

220-240V ~ 50/60Hz MAX 14W

7xMAX 2W G4 12Vdc

LED



PWM

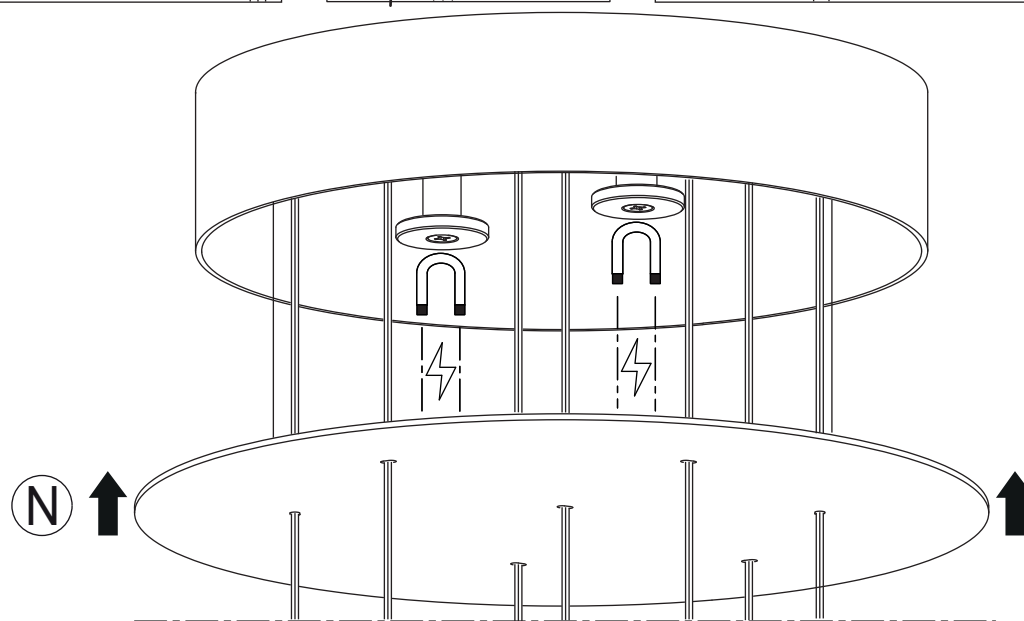
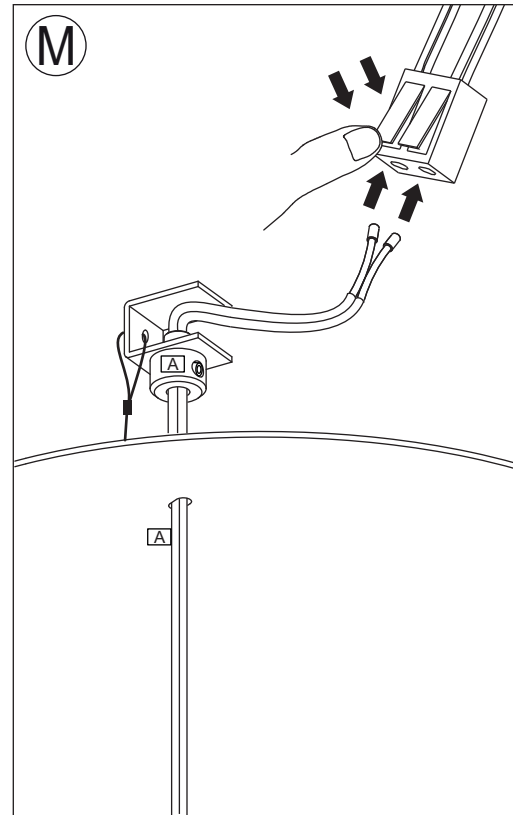
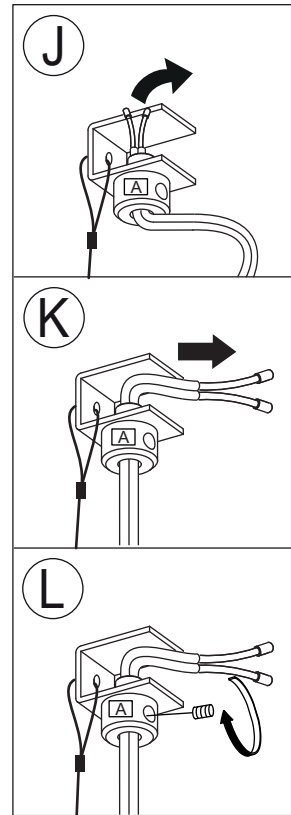
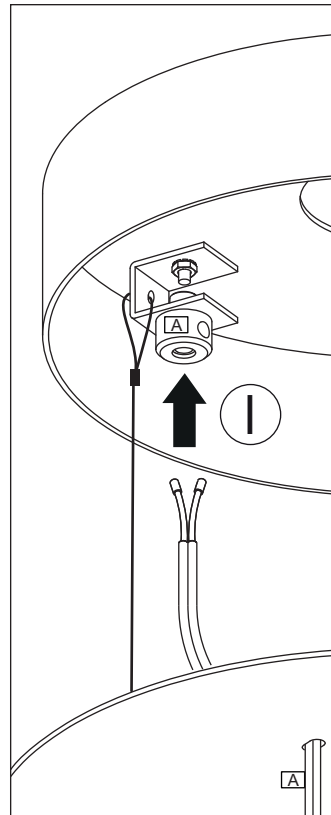
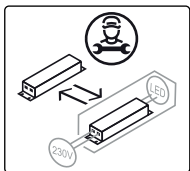

MIZU

CODE 0R07S -- -- FL

220-240V ~ 50/60Hz MAX 14W

7xMAX 2W G4 12Vdc

LED

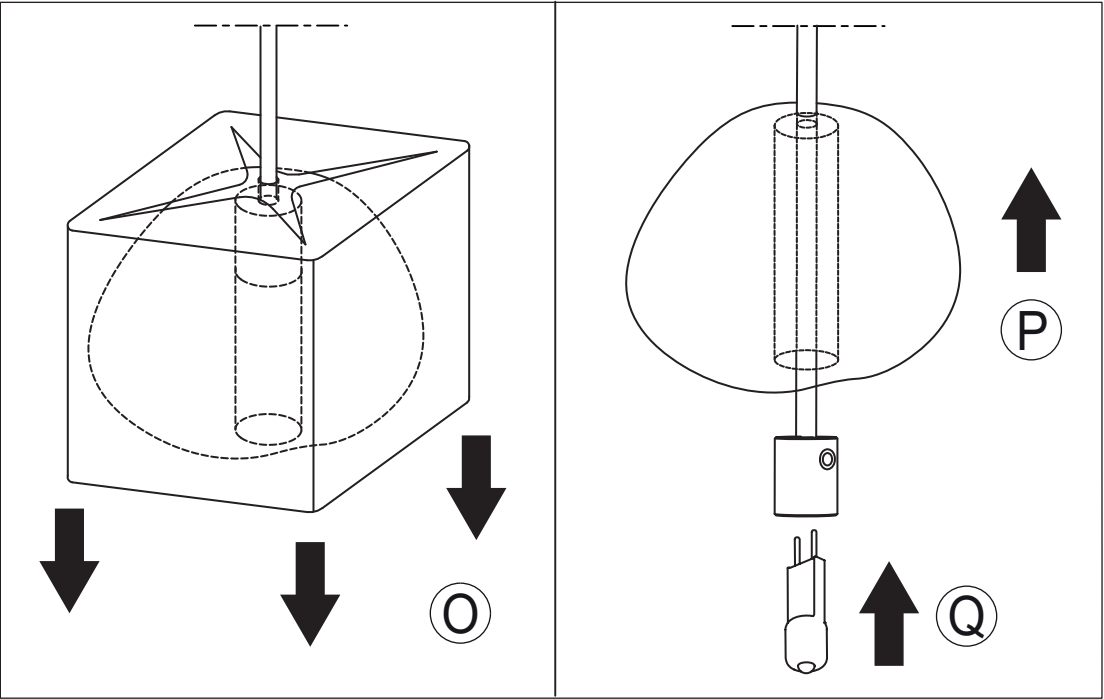
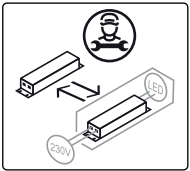

CAUTION!

IT
questo prodotto non è compatibile con le lampadine LED G4 12V a marchio Beghelli

UK
this product is not compatible with Beghelli branded G4 12V LED bulbs

FR
cet produit n'est pas compatible avec les ampoules LED G4 12V marquée Beghelli

DE
Das Produkt ist nicht kompatibel mit LED G4 12V Leuchtmittel Beghelli

py
Это изделие не совместимо со светодиодами лампами LED Beghelli G4 12V

عربي
هذا المنتج لا يتوافق مع مصابيح ليد LED G4 12V من نوع بيغيلي Beghelli

CLEANING INSTRUCTIONS

YES

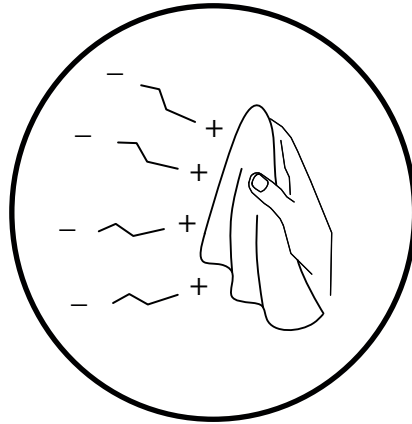

- IT** Usare panno elettrostatico asciutto
UK Use dry electrostatic cloth
FR Utiliser un chiffon électrostatique sec
DE Verwenden sie ein trockenes elektrostattuch
PY Использовать сухую электростатическую ткань
عربي استخدم قطعة قماش جافة كهرباء

NO

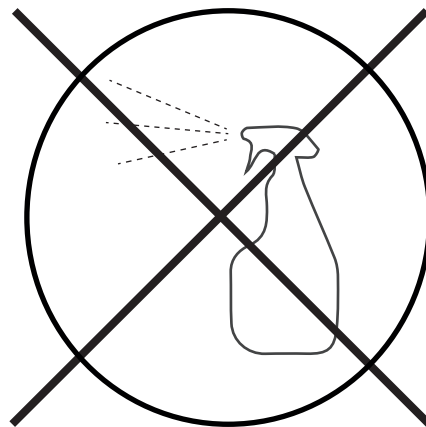

- IT** Non usare prodotti chimici | Usare prodotti specifici solo per cristalli e vetri
UK Do not use chemical products | Use specific products only for crystals and glass
FR Ne pas utiliser des produits chimiques | N'utiliser des produits spécifiques que pur les cristaux et le verre
DE Verwenden Sie keine Chemikalien | Verwenden Sie bitte nur Glas-bzw Kristallreiniger
PY Нельзя использовать химикаты | Использовать только специальные средства для хрусталя и стекла
عربي لا تستخدم المنتجات الكيماوية | استعمل مواد مخصصة للكريستال والزجاج فقط



IT Conservare questa istruzione per la manutenzione | **UK** Keep these instructions for maintenance
FR Garder ces instructions pour l'entretien | **DE** Dies Wartungsanleitung ist aufzubewahren
PY Сохраните эту инструкцию по эксплуатации | عربي احتفظ بهذه الإرشادات للصيانة

TERZANI
LA LUCE PENSATA

Mizu 7 light pendant

0R07S-FD

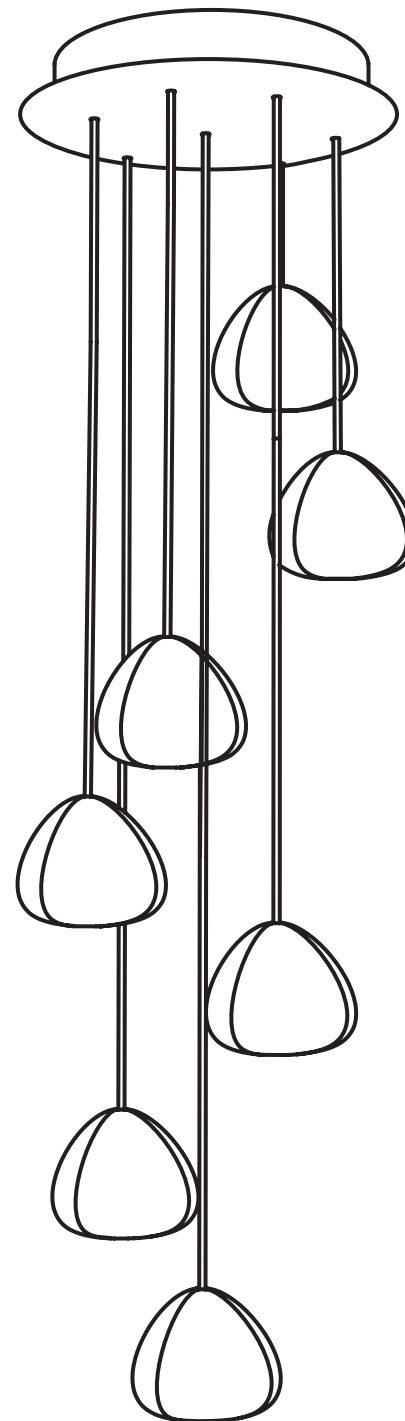

Design Nicolas Terzani

TERZANI
LA LUCE PENSATA

MIZU

CODE 0R07S -- -- FD

230-240V ~ 50/60Hz MAX 70W

7xMAX 10W G4 12V  

Halogen

or

7xMAX 2W G4 12Vac 

LED

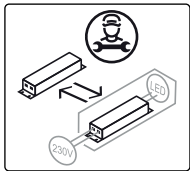

FOLLOW THE LETTERS TO PLACE THE PENDANTS IN THE CORRECT POSITION

TOP VIEW:

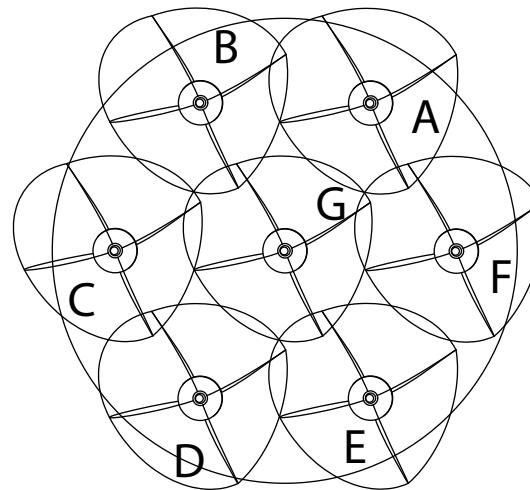
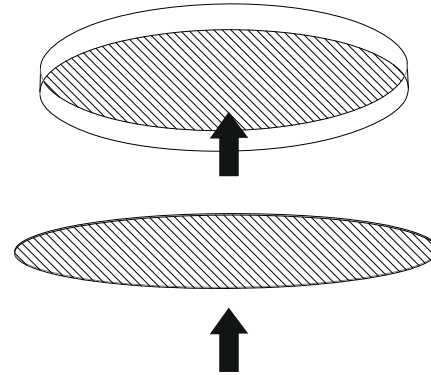

FRONT VIEW





MIZU

CODE 0R07S -- -- FD

230-240V ~ 50/60Hz MAX 70W

7xMAX 10W G4 12V 

Halogen

or

7xMAX 2W G4 12Vac 

LED

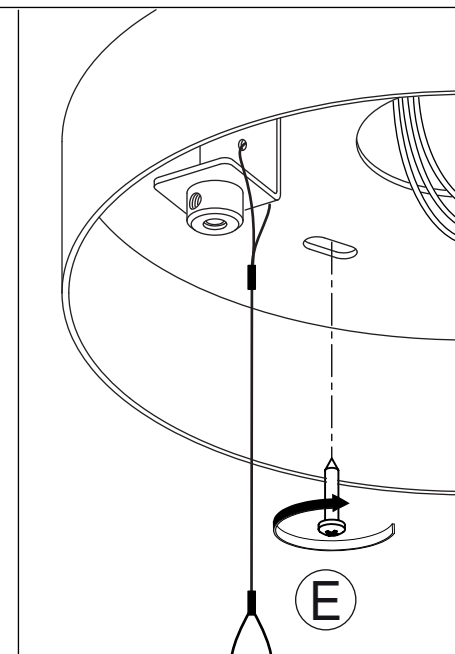
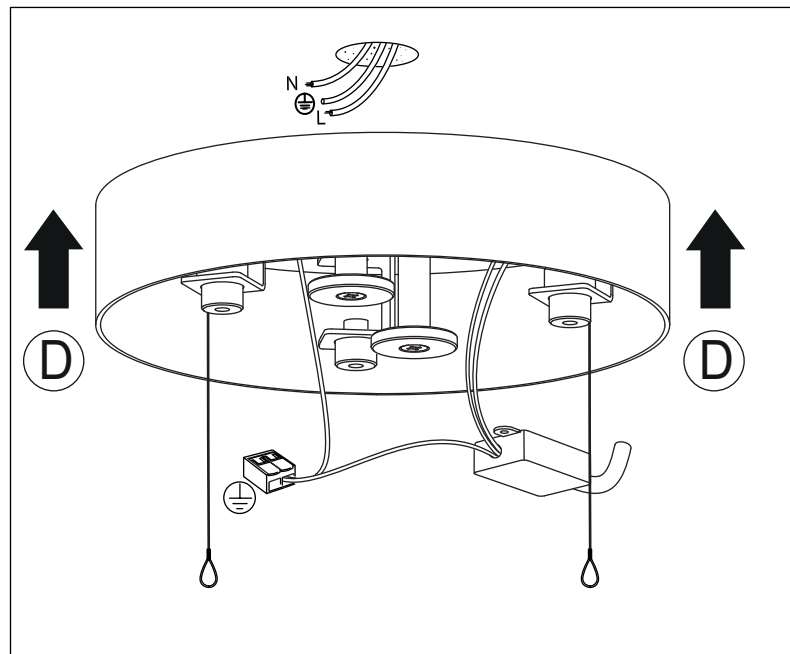
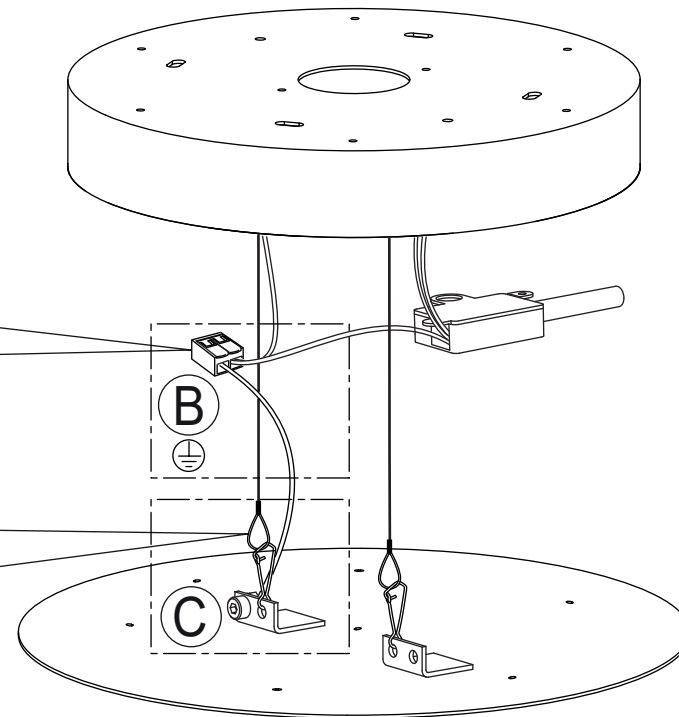
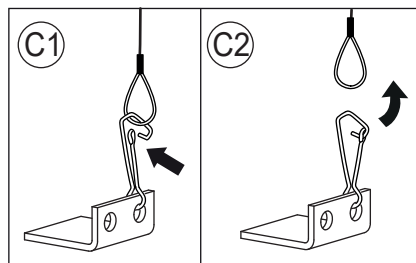
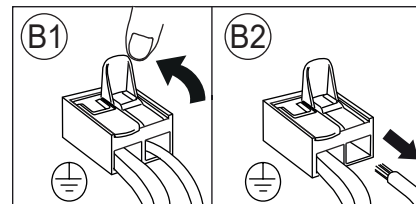
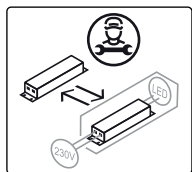

TERZANI

LA LUCE PENSATA

MIZU

CODE 0R07S -- -- FD

230-240V ~ 50/60Hz MAX 70W

7xMAX 10W G4 12V 

Halogen

or

7xMAX 2W G4 12Vac 

LED

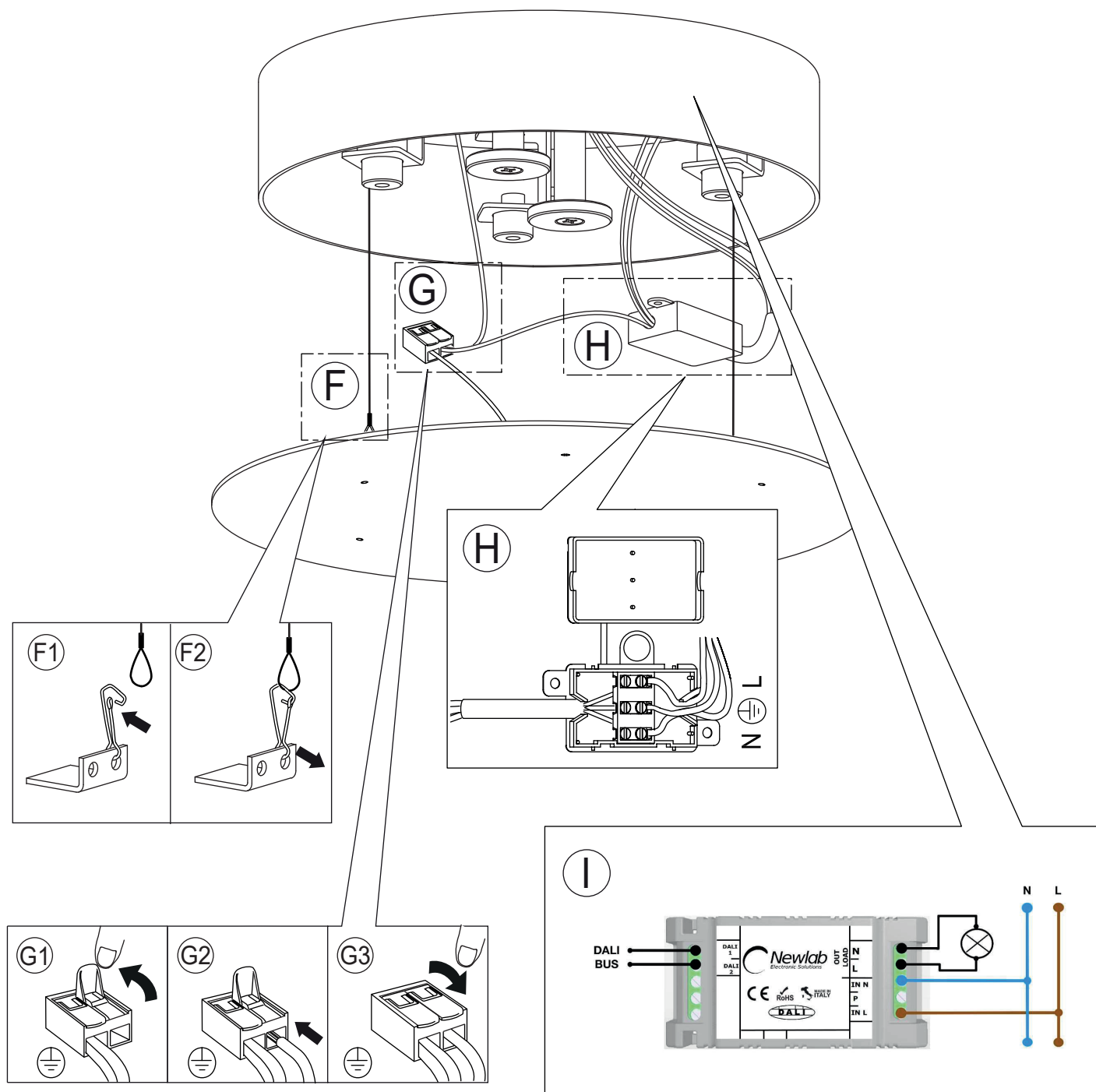
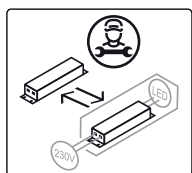

TERZANI

LA LUCE PENSATA

MIZU

CODE 0R07S -- -- FD

230-240V ~ 50/60Hz MAX 70W

7xMAX 10W G4 12V

Halogen

or

7xMAX 2W G4 12Vac

LED

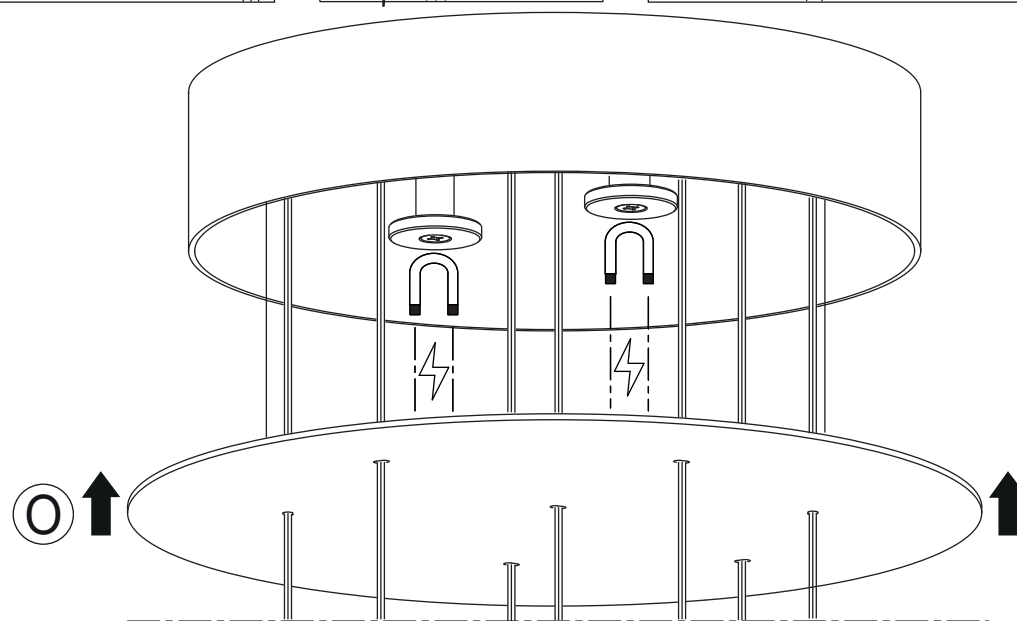
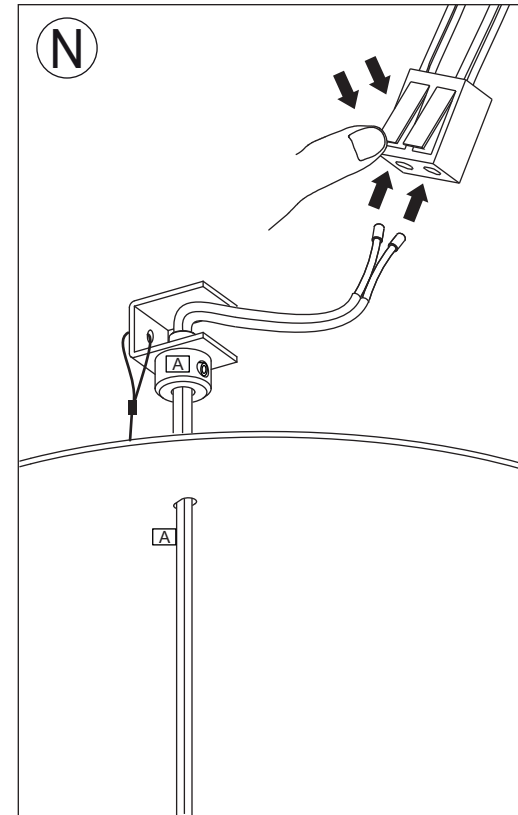
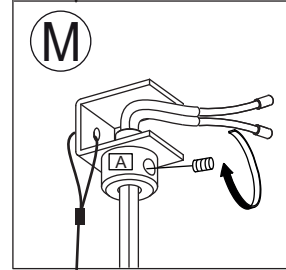
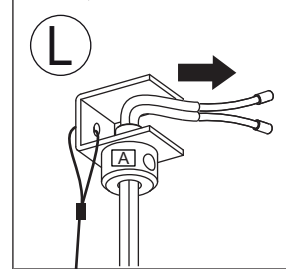
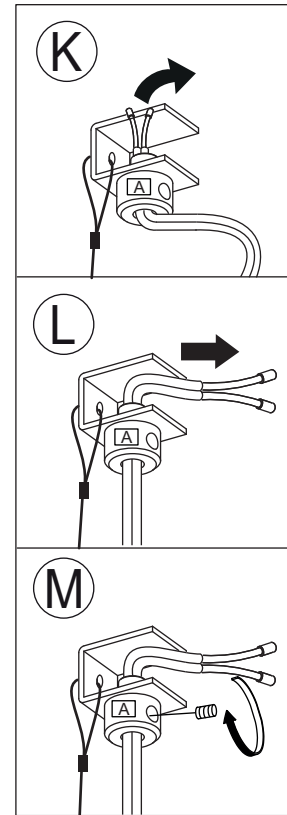
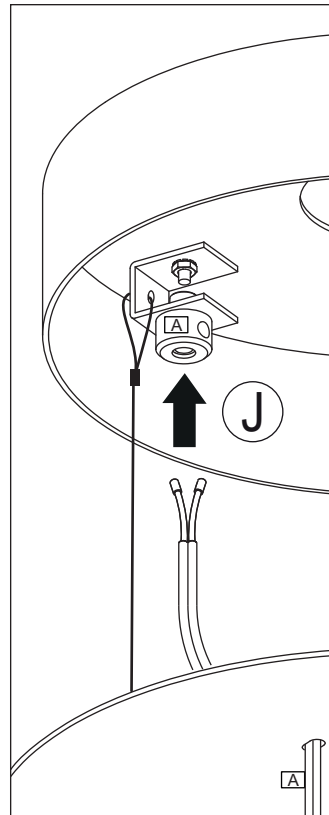
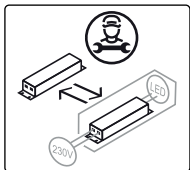

TERZANI
LA LUCE PENSATA

MIZU

CODE 0R07S -- -- FD

230-240V ~ 50/60Hz MAX 70W

7xMAX 10W G4 12V 

Halogen

or

7xMAX 2W G4 12Vac 

LED

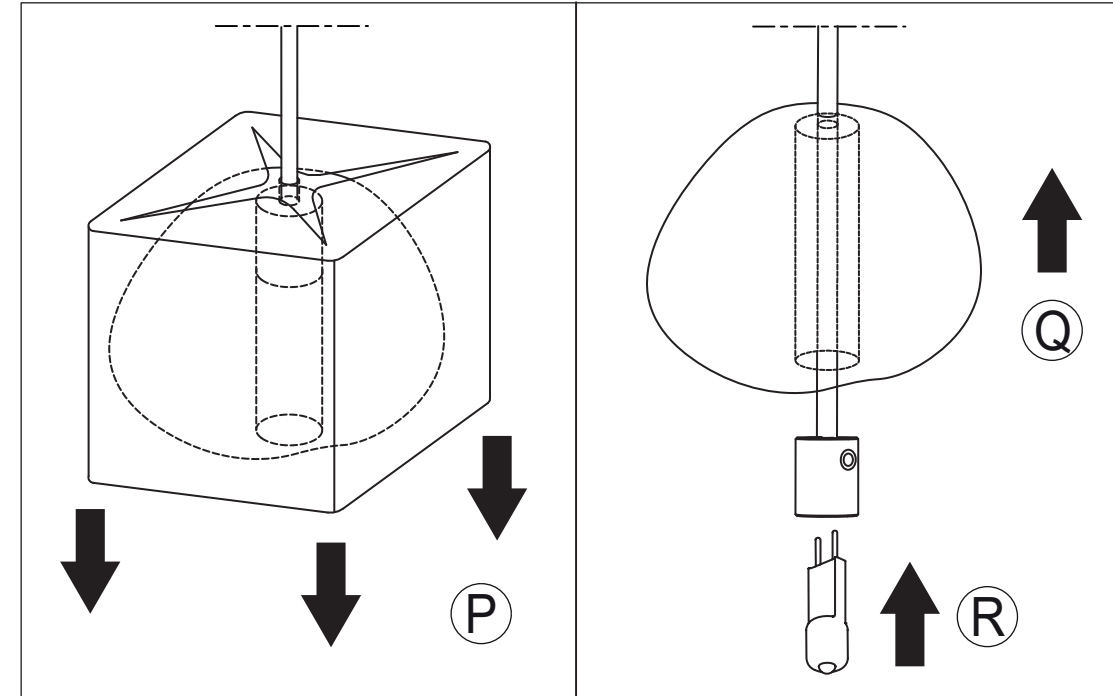
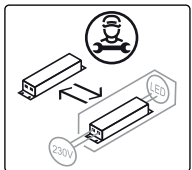

CAUTION!

IT

questo prodotto non è compatibile con le lampadine LED G4 12V a marchio Beghelli

UK

this product is not compatible with Beghelli branded G4 12V LED bulbs

FR

cet produit n'est pas compatible avec les ampoules LED G4 12V marquée Beghelli

DE

Das Produkt ist nicht kompatibel mit LED G4 12V Leuchtmittel Beghelli

RU

Это изделие не совместимо со светодиодными лампами LED Beghelli G4 12V

عربي

هذا المنتج لا يتوافق مع مصابيح LED G4 12V من نوع بيغيلي Beghelli

CLEANING INSTRUCTIONS

YES

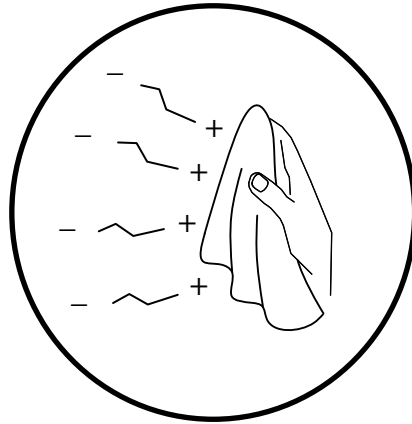

- IT** Usare panno elettrostatico asciutto
UK Use dry electrostatic cloth
FR Utiliser un chiffon électrostatique sec
DE Verwenden sie ein trockenes elektrostattuch
PY Использовать сухую электростатическую ткань
عربي استخدم قطعة قماش جافة كهرباء

NO

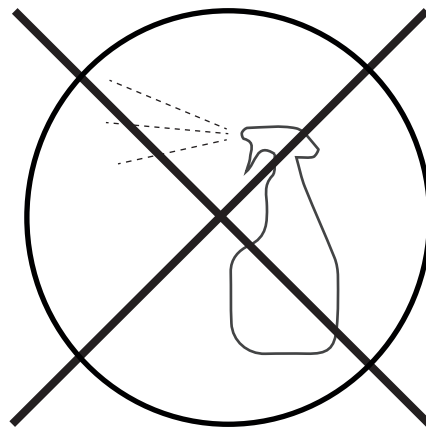

- IT** Non usare prodotti chimici | Usare prodotti specifici solo per cristalli e vetri
UK Do not use chemical products | Use specific products only for crystals and glass
FR Ne pas utiliser des produits chimiques | N'utiliser des produits spécifiques que pur les cristaux et le verre
DE Verwenden Sie keine Chemikalien | Verwenden Sie bitte nur Glas-bzw Kristallreiniger
PY Нельзя использовать химикаты | Использовать только специальные средства для хрусталя и стекла
عربي لا تستخدم المنتجات الكيماوية | استعمل مواد مخصصة للكريستال والزجاج فقط



IT Conservare questa istruzione per la manutenzione | **UK** Keep these instructions for maintenance
FR Garder ces instructions pour l'entretien | **DE** Dies Wartungsanleitung ist aufzubewahren
PY Сохраните эту инструкцию по эксплуатации | عربي احتفظ بهذه الإرشادات للصيانة

TERZANI
LA LUCE PENSATA

Mizu 7 light pendant

0R07S-FE

0R07S-FEW

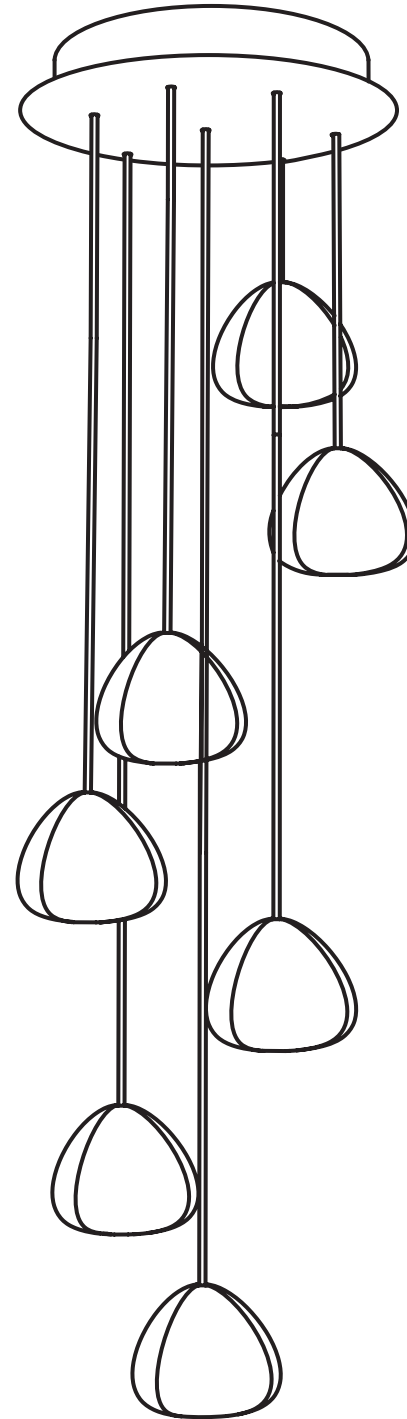

Design Nicolas Terzani



MIZU

CODE 0R07S -- -- FE
3000K

CODE 0R07S -- -- FEW
2700K

220-240V ~ 50/60Hz MAX 10,5W

500mA 7xMAX 1,5W

integrated LED

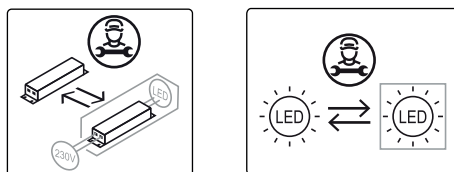
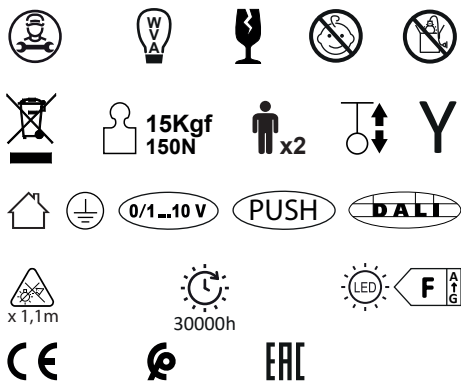

FOLLOW THE LETTERS TO PLACE THE PENDANTS IN THE CORRECT POSITION

TOP VIEW:

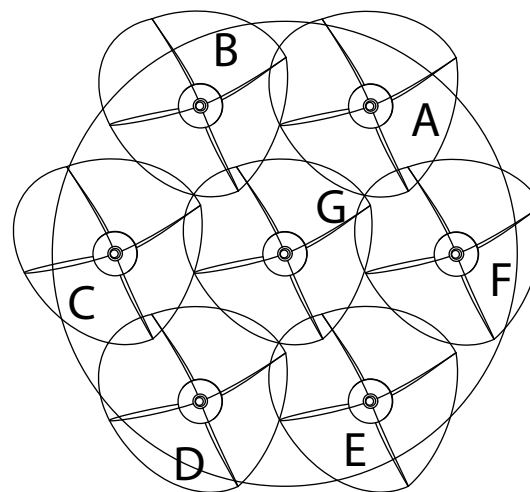
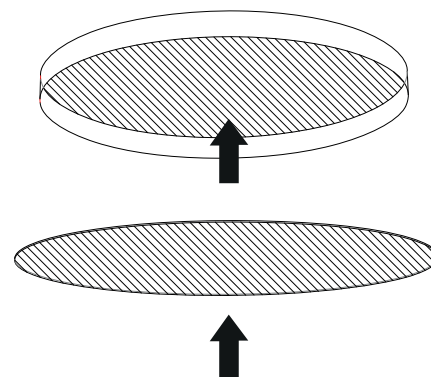

FRONT VIEW





MIZU

CODE 0R07S -- -- FE
3000K

CODE 0R07S -- -- FEW
2700K

220-240V ~ 50/60Hz MAX 10,5W

500mA 7xMAX 1,5W

integrated LED

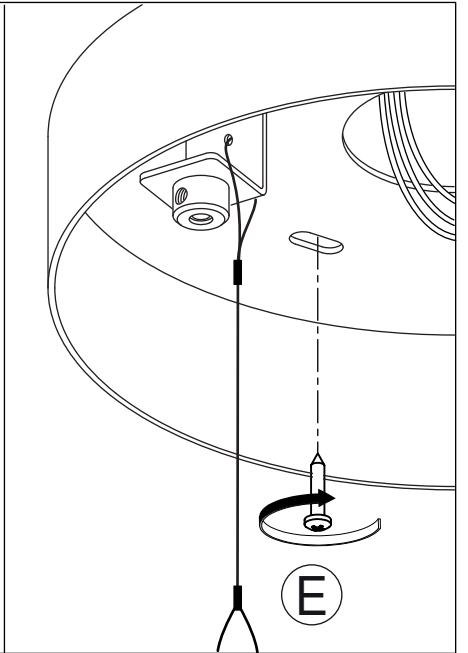
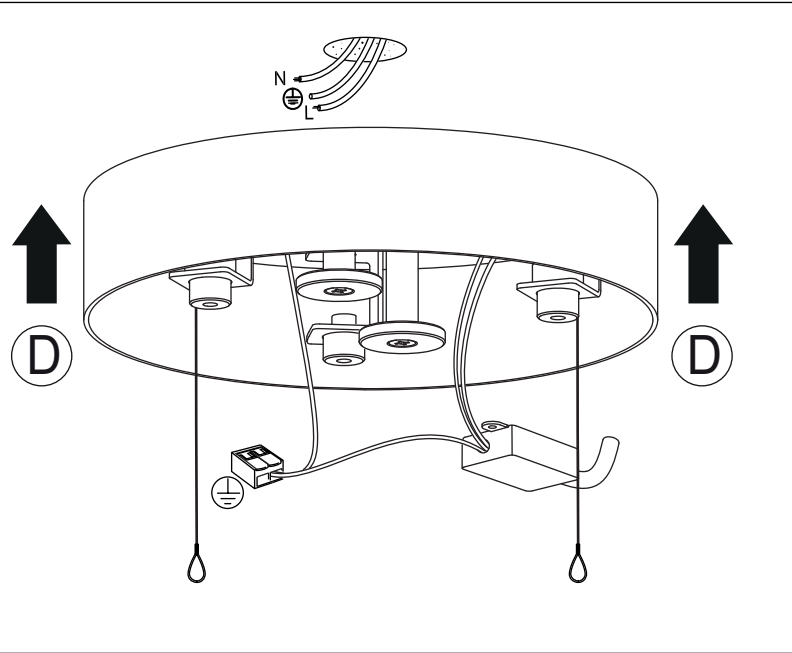
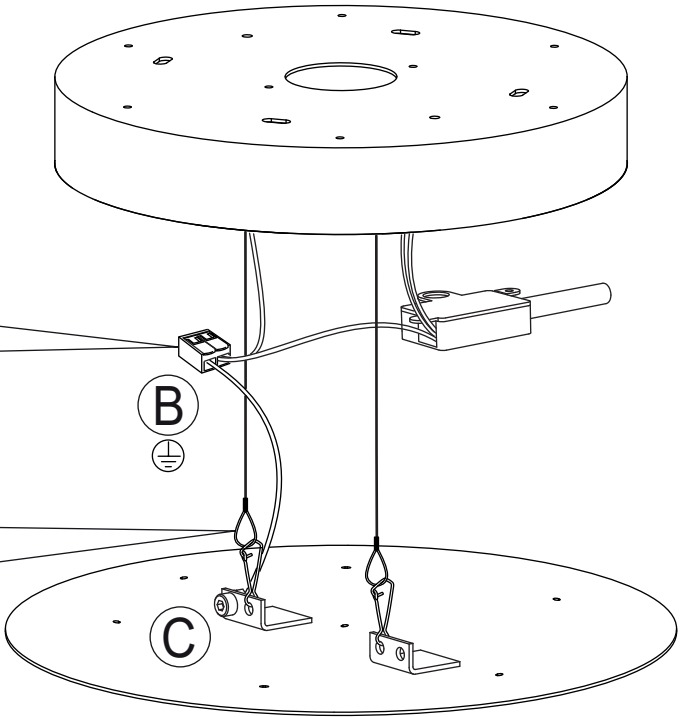
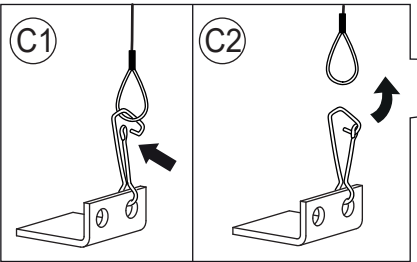
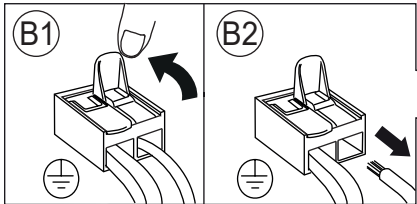
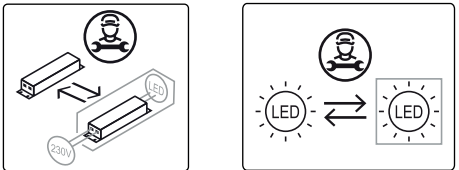

TERZANI

LA LUCE PENSATA

MIZU

CODE 0R07S -- -- FE
3000K

CODE 0R07S -- -- FEW
2700K

220-240V ~ 50/60Hz MAX 10,5W

500mA 7xMAX 1,5W

integrated LED

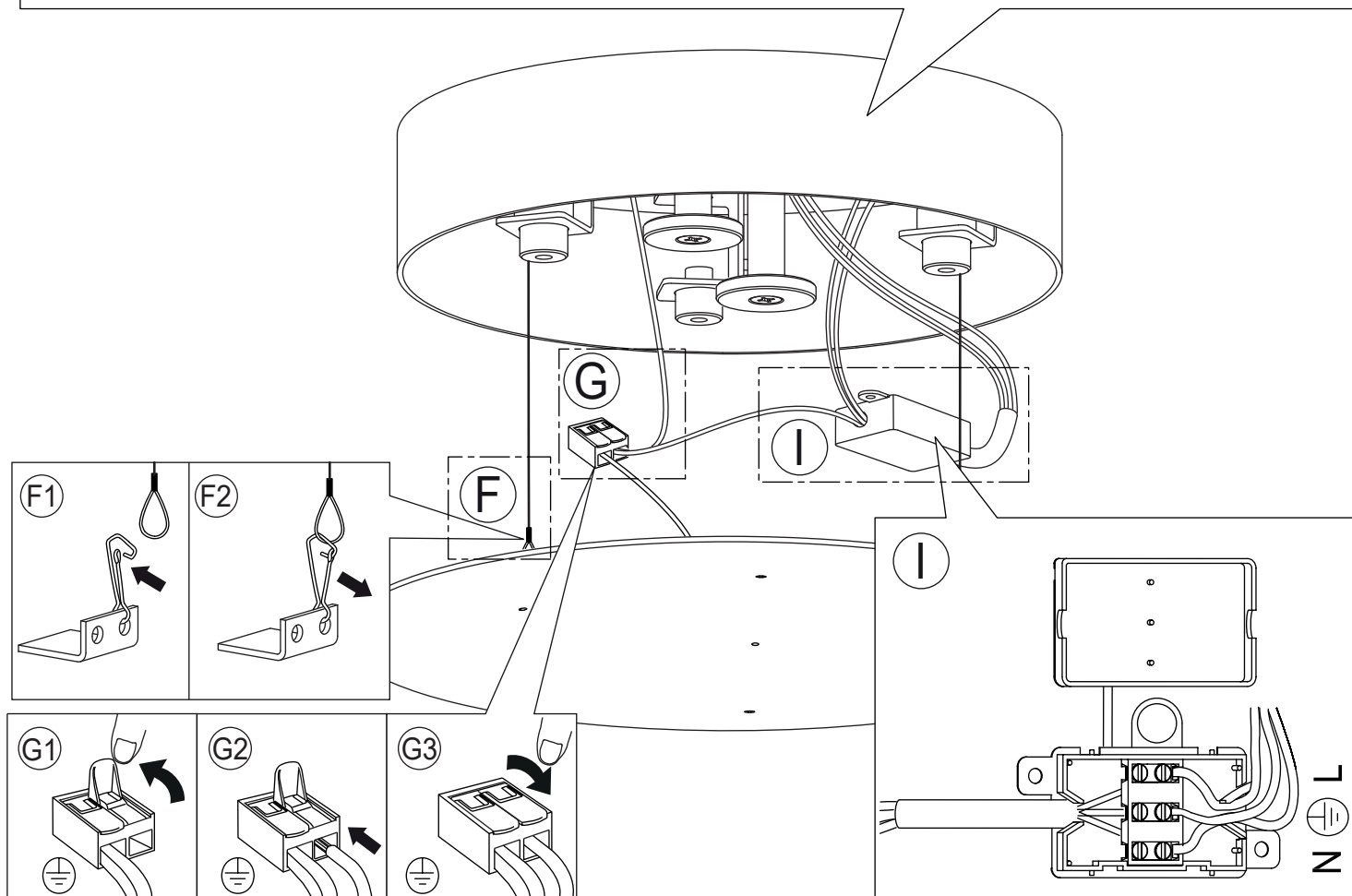
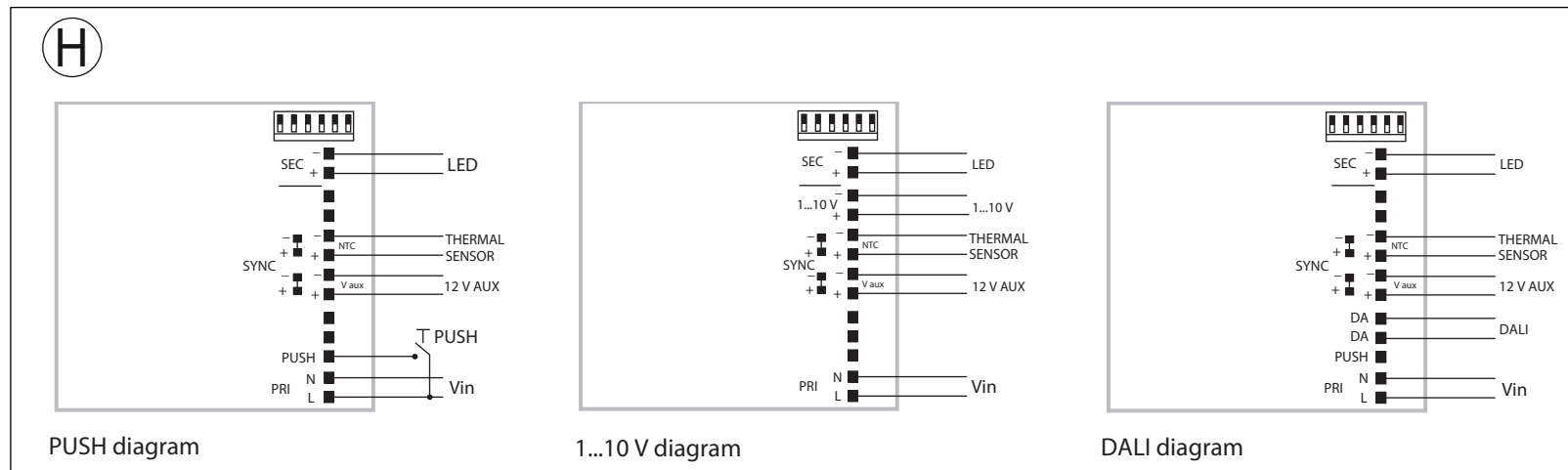
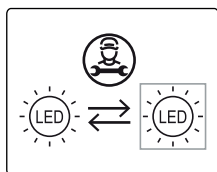
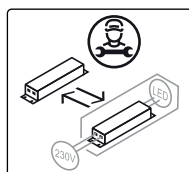
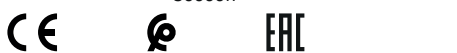

MIZU

CODE 0R07S -- -- FE
3000K

CODE 0R07S -- -- FEW
2700K

220-240V ~ 50/60Hz MAX 10,5W

500mA 7xMAX 1,5W

integrated LED

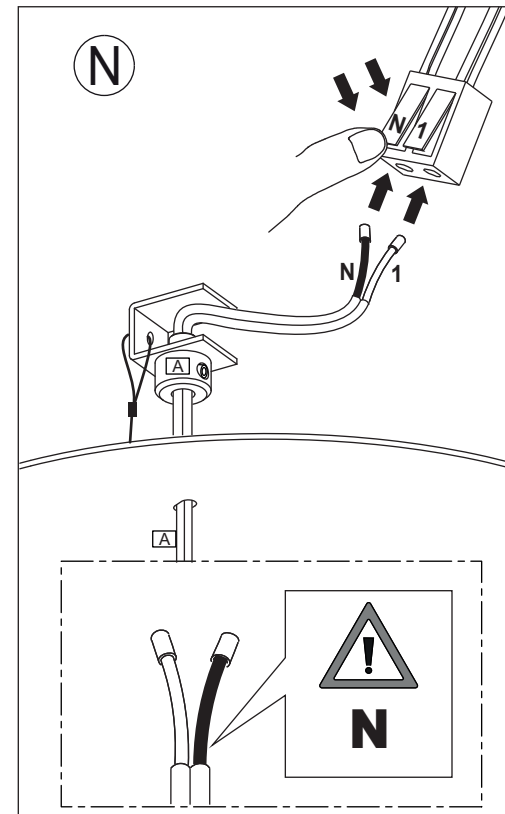
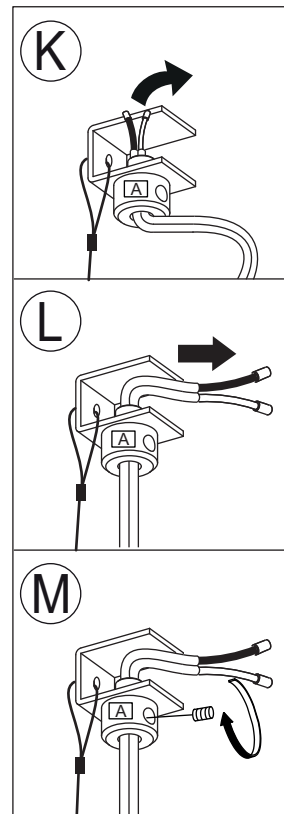
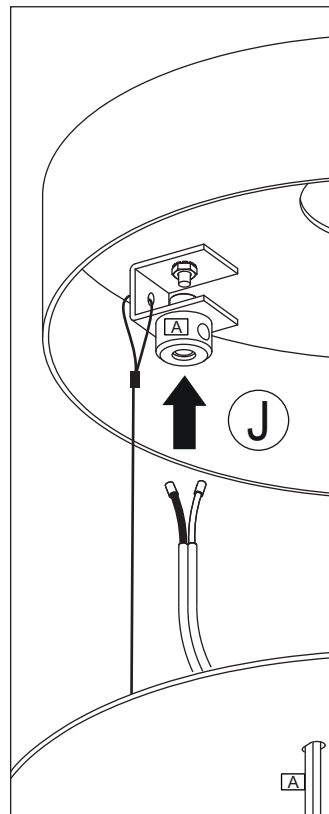
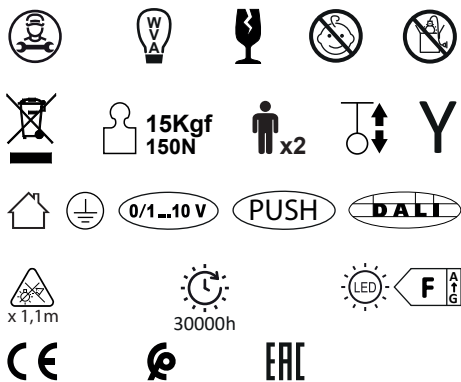

TERZANI
LA LUCE PENSATA

MIZU

CODE 0R07S -- -- FE
3000K

CODE 0R07S -- -- FEW
2700K

220-240V ~ 50/60Hz MAX 10,5W

500mA 7xMAX 1,5W

integrated LED

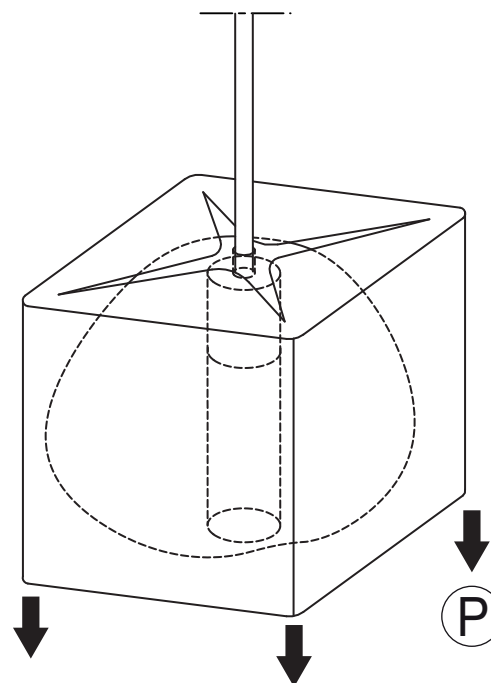
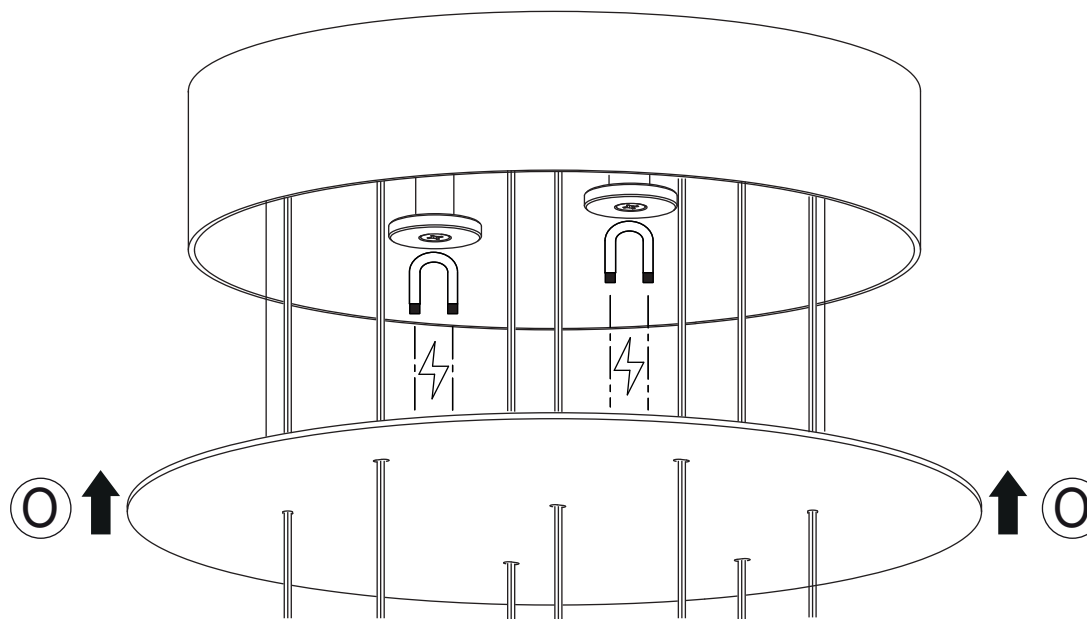
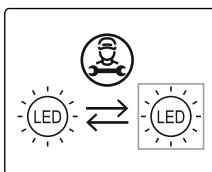
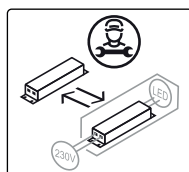

CLEANING INSTRUCTIONS

YES

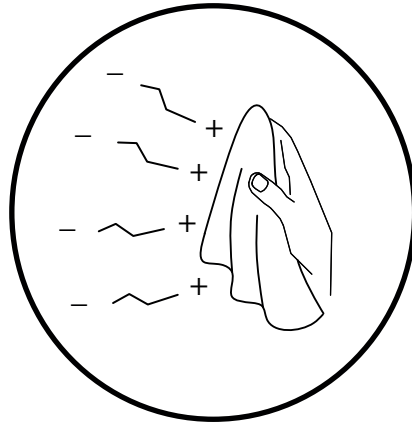

- IT** Usare panno elettrostatico asciutto
UK Use dry electrostatic cloth
FR Utiliser un chiffon électrostatique sec
DE Verwenden sie ein trockenes elektrostattuch
PY Использовать сухую электростатическую ткань
عربي استخدم قطعة قماش جافة كهرباء

NO

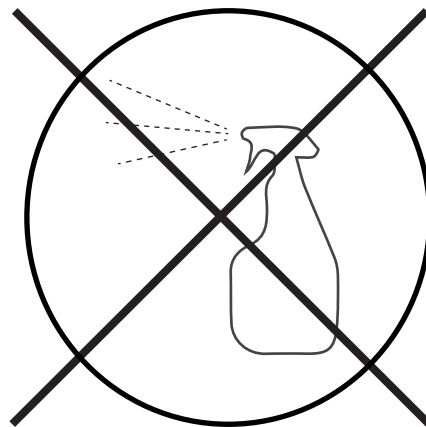

- IT** Non usare prodotti chimici | Usare prodotti specifici solo per cristalli e vetri
UK Do not use chemical products | Use specific products only for crystals and glass
FR Ne pas utiliser des produits chimiques | N'utiliser des produits spécifiques que pur les cristaux et le verre
DE Verwenden Sie keine Chemikalien | Verwenden Sie bitte nur Glas-bzw Kristallreiniger
PY Нельзя использовать химикаты | Использовать только специальные средства для хрусталя и стекла
عربي لا تستخدم المنتجات الكيماوية | استعمل مواد مخصصة للكريستال والزجاج فقط



IT Conservare questa istruzione per la manutenzione | **UK** Keep these instructions for maintenance
FR Garder ces instructions pour l'entretien | **DE** Dies Wartungsanleitung ist aufzubewahren
PY Сохраните эту инструкцию по эксплуатации | عربي احتفظ بهذه الإرشادات للصيانة