

TERZANI
LA LUCE PENSATA

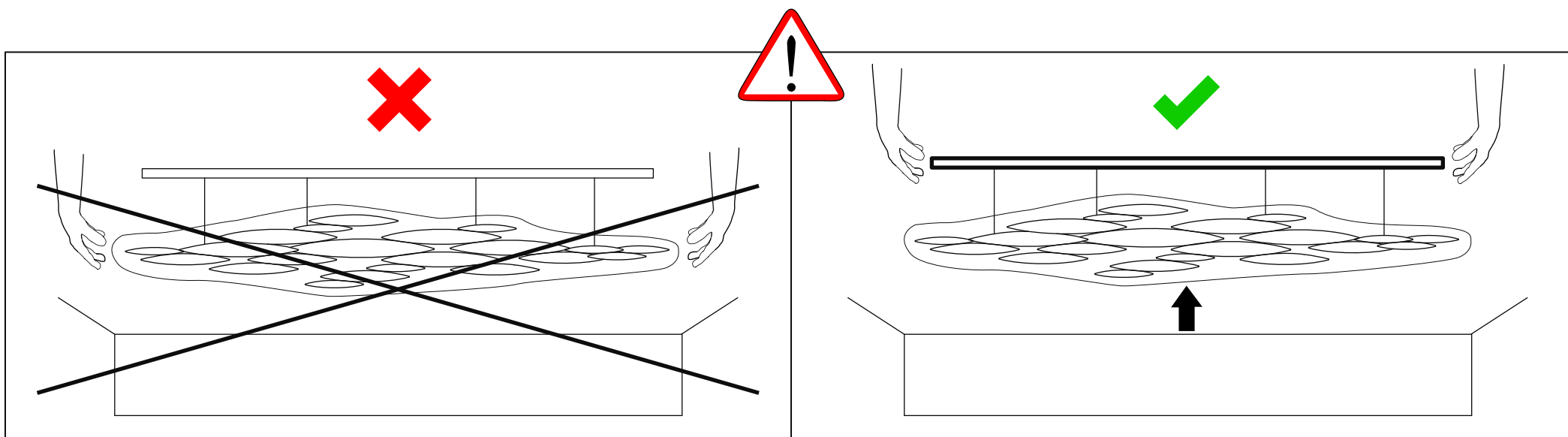

TERZANI
LA LUCE PENSATA

I Lucci Argentati large linear chandelier

0N81S-FL

0N81S-FLW

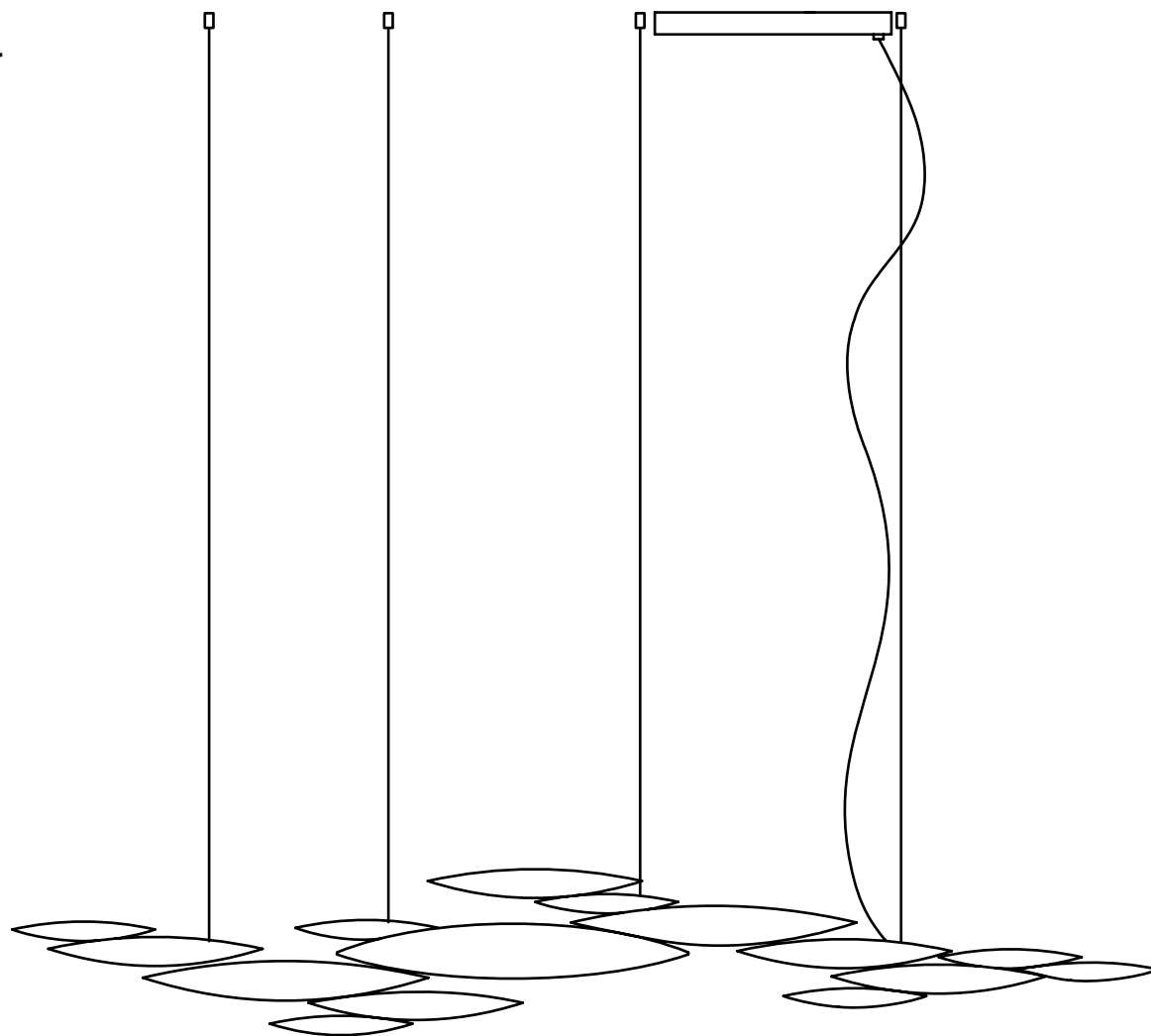

Design Dodo Arslan

TERZANI
LA LUCE PENSATA

I LUCCI ARGENTATI

CODE 0N81S -- FL
3000K

CODE 0N81S -- FLW
2700K

220-240V ~ 50/60Hz MAX 45W

700mA 10xMAX 4,5W

integrated LED

Power Factor = 0.99
Supply current = 0.192 A @ 230V



9Kgf
90N

x3



0...10 V

PWM

30000h



EAC

CB

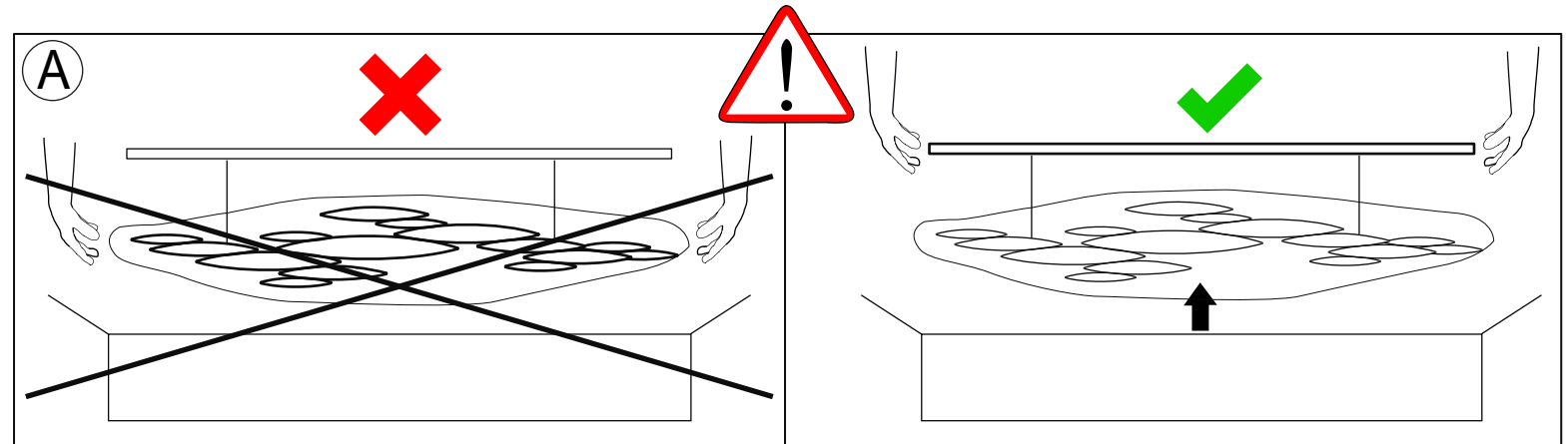
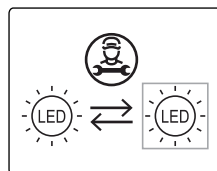
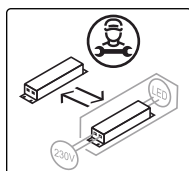

B TEMPLATE

To place the lighting fixture on the ceiling, use the template found in the packing

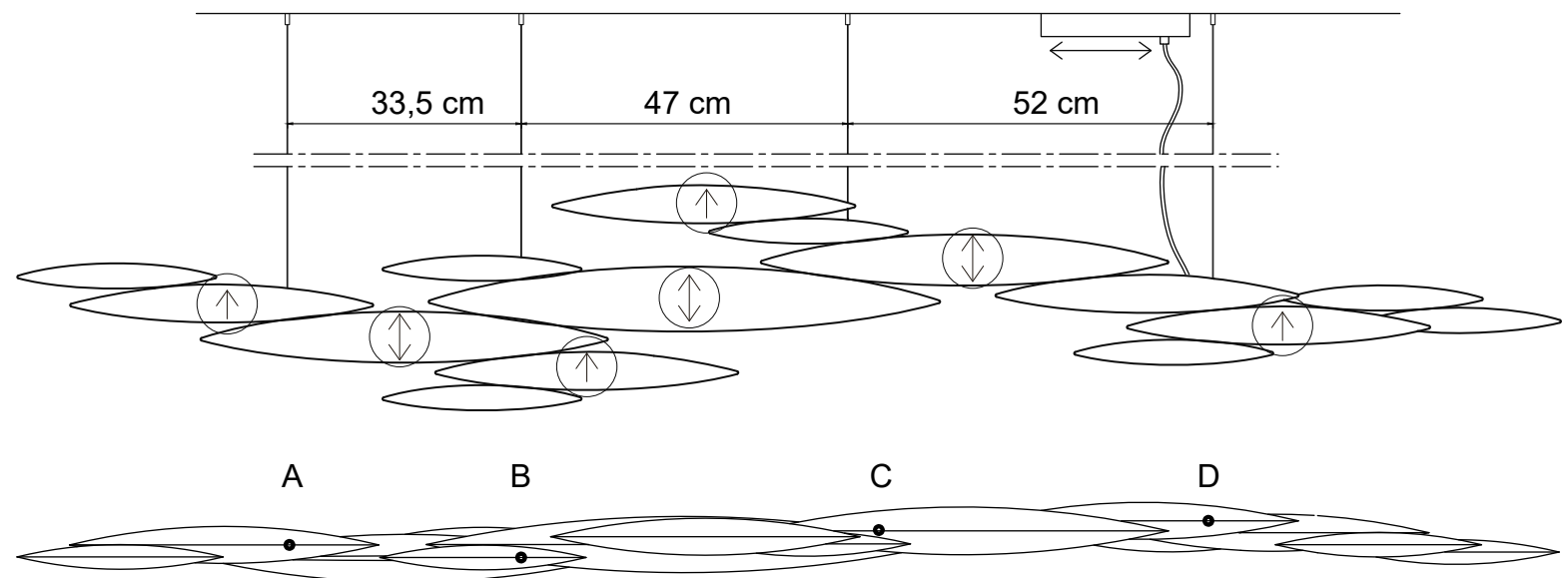
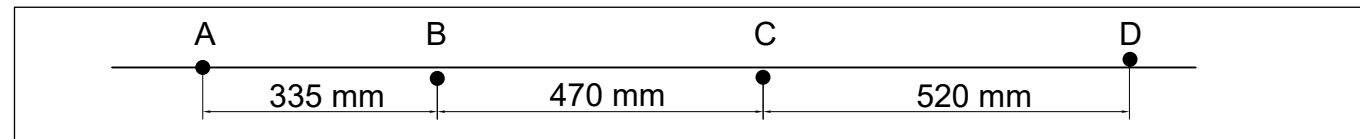

TERZANI
LA LUCE PENSATA

I LUCCI ARGENTATI

CODE 0N81S -- FL
3000K

CODE 0N81S -- FLW
2700K

220-240V ~ 50/60Hz MAX 45W

700mA 10xMAX 4,5W

integrated LED

Power Factor = 0.99
Supply current = 0.192 A @ 230V

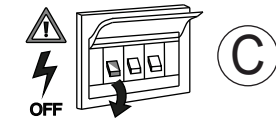
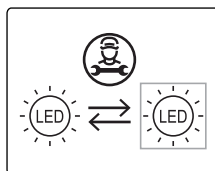
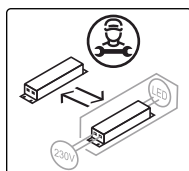

x3

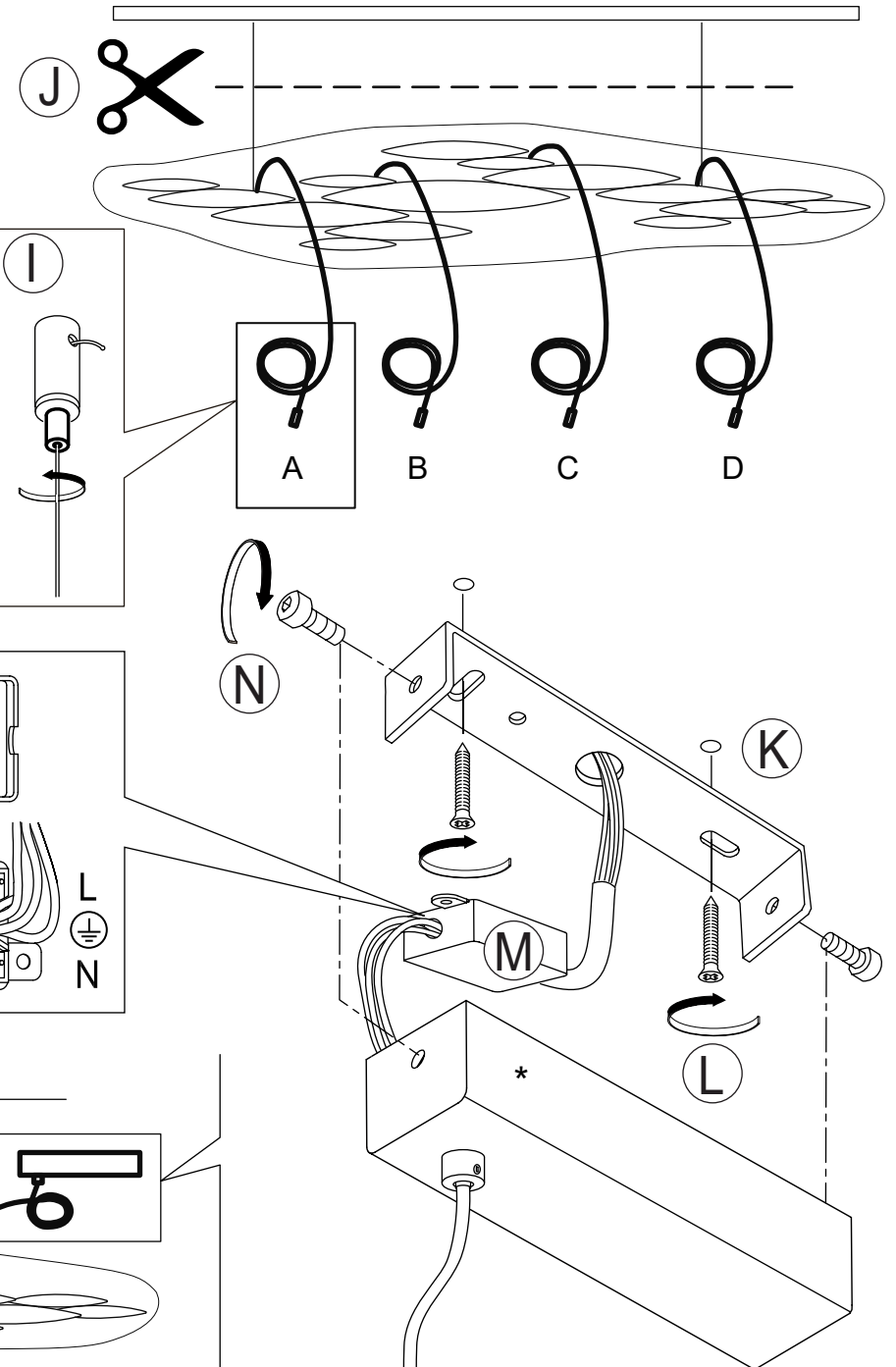
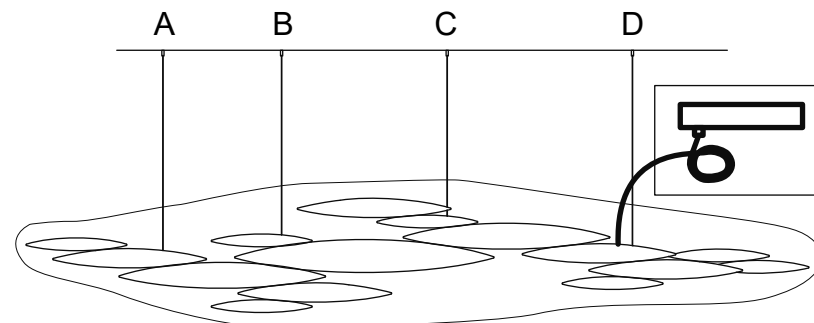
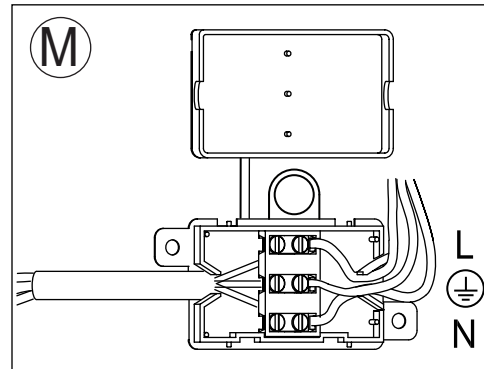
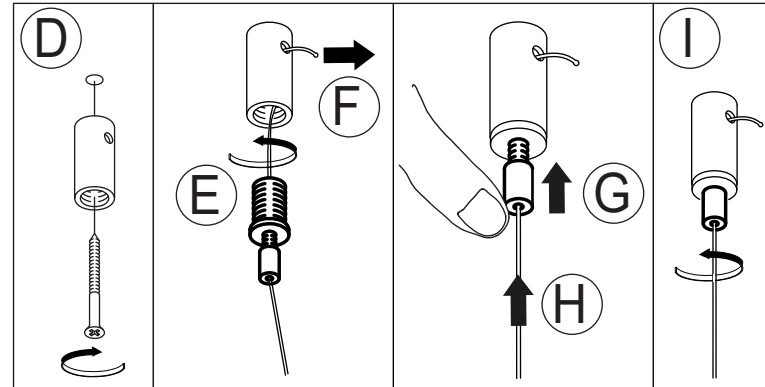

TERZANI
LA LUCE PENSATA

I LUCCI ARGENTATI

CODE 0N81S -- FL
3000K

CODE 0N81S -- FLW
2700K

220-240V ~ 50/60Hz MAX 45W

700mA 10xMAX 4,5W

integrated LED

Power Factor = 0.99
Supply current = 0.192 A @ 230V

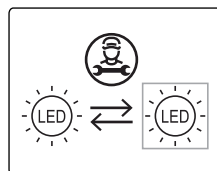
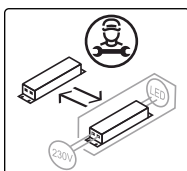

*

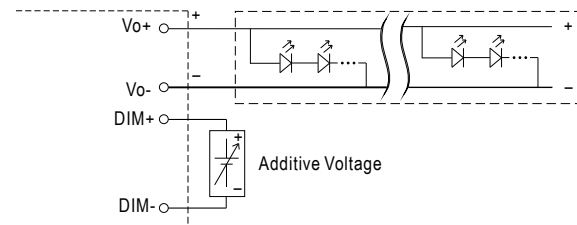

0...10 V diagram

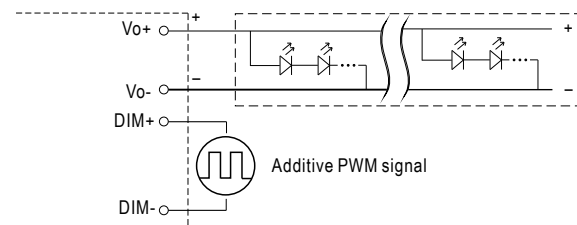

PWM diagram

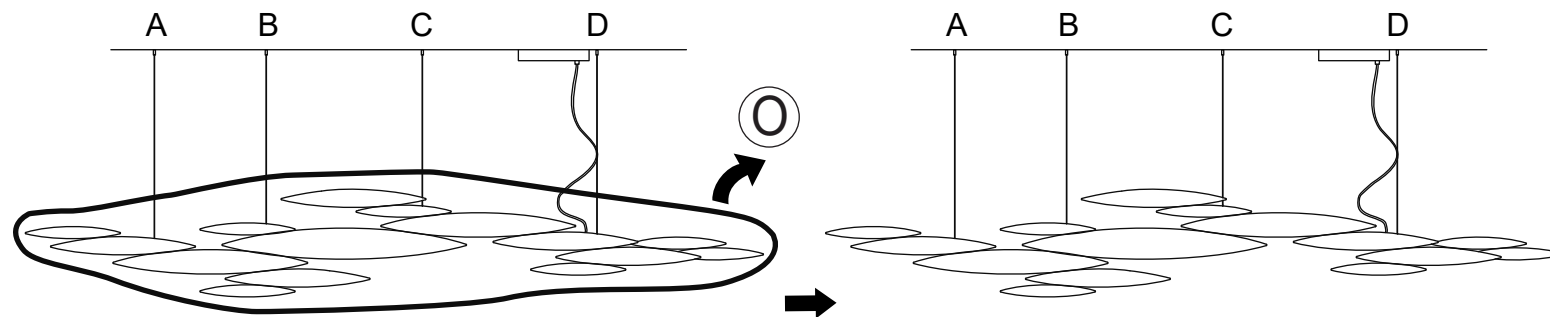
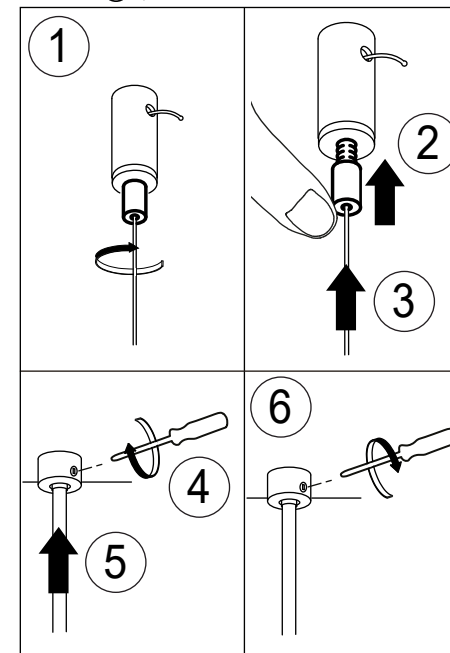
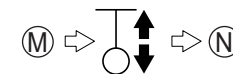

CLEANING INSTRUCTIONS

YES

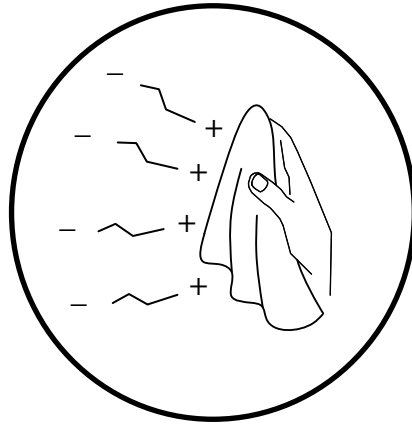

IT Usare panno elettrostatico asciutto

UK Use dry electrostatic cloth

FR Utiliser un chiffon électrostatique sec

DE Verwenden sie ein trockenes elektrostattuch

PY Использовать сухую электростатическую ткань

عربي استخدم قطعة قماش جافة كهرباء

NO

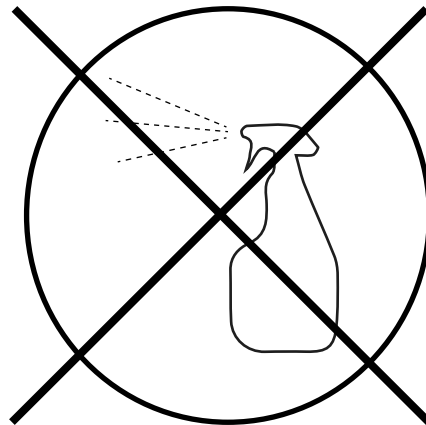

IT Non usare prodotti chimici

UK Do not use chemical products

FR Ne pas utiliser des produits chimiques

DE Verwenden Sie keine Chemikalien

PY Нельзя использовать химикаты

عربي لا تستخدم المنتجات الكيماوية



IT Conservare questa istruzione per la manutenzione | **UK** Keep these instructions for maintenance

FR Garder ces instructions pour l'entretien | **DE** Dies Wartungsanleitung ist aufzubewahren

PY Сохраните эту инструкцию по эксплуатации | عربي احتفظ بهذه الإرشادات للصيانة

TERZANI
LA LUCE PENSATA

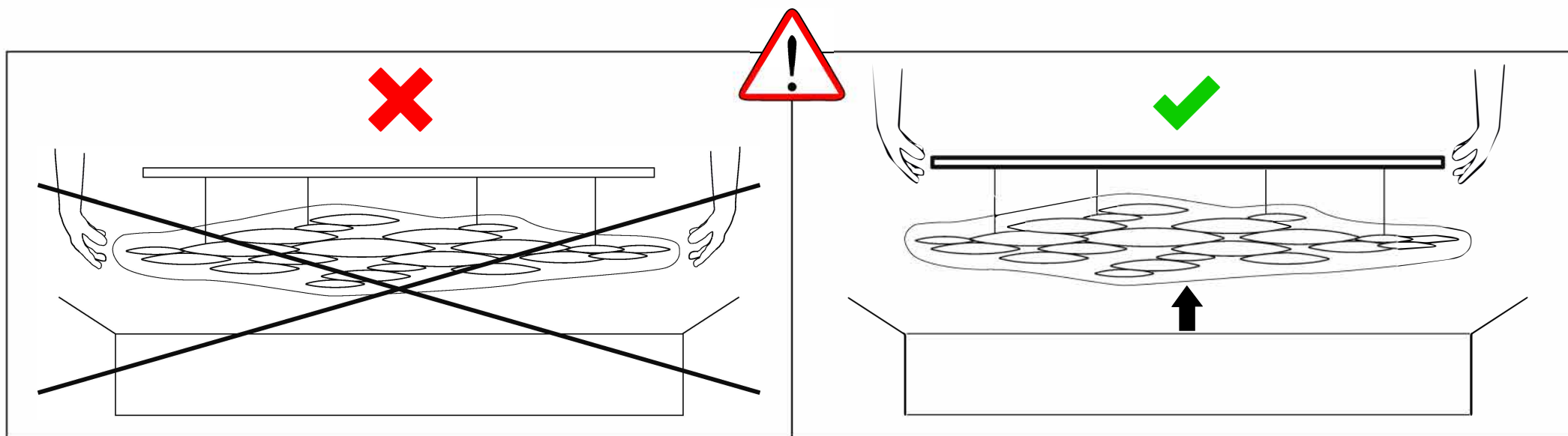

TERZANI
LA LUCE PENSATA

I Lucci Argentati large linear chandelier

0N81S-FLD

0N81S-FLWD

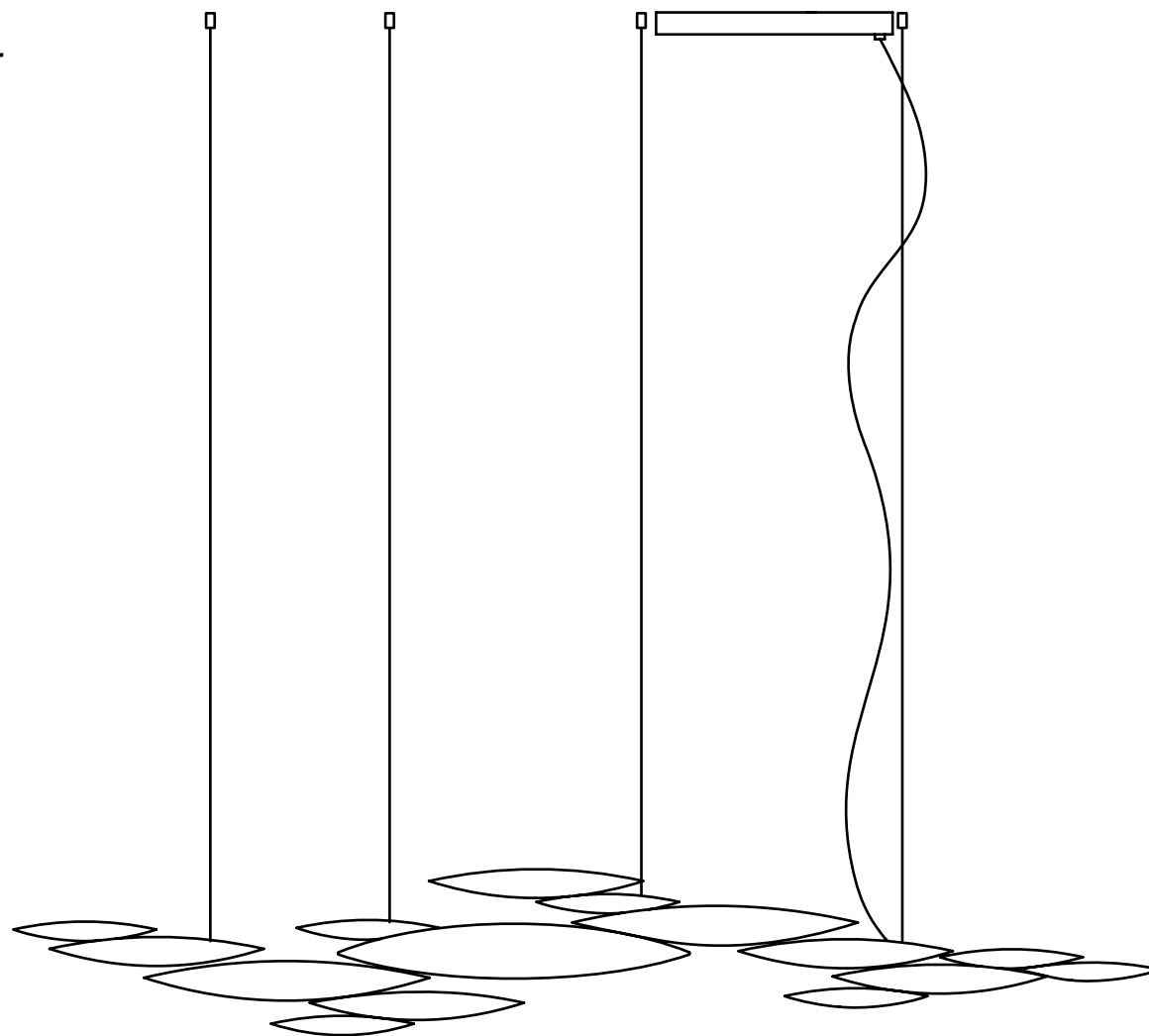

Design Dodo Arslan

TERZANI
LA LUCE PENSATA

I LUCCI ARGENTATI

CODE 0N81S -- FLD
3000K

CODE 0N81S -- FLWD
2700K

220-240V ~ 50/60Hz MAX 45W

700mA 10xMAX 4,5W

integrated LED

Power Factor = 0.99
Supply current = 0.192 A @ 230V



30000h

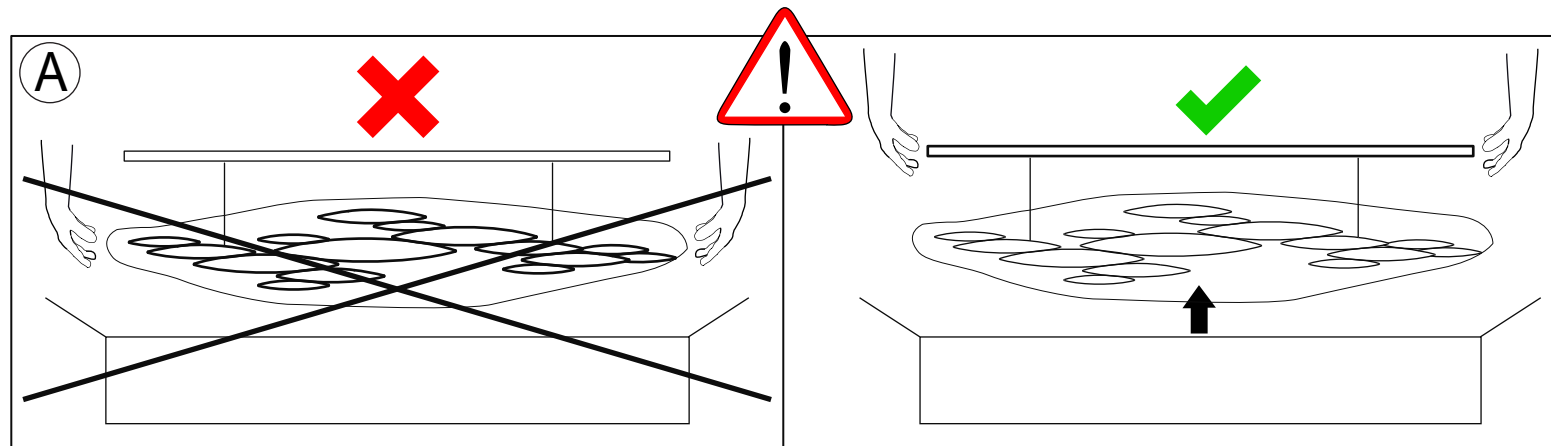
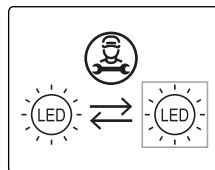
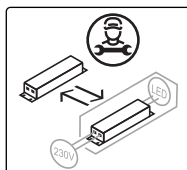

B TEMPLATE

To place the lighting fixture on the ceiling, use the template found in the packing

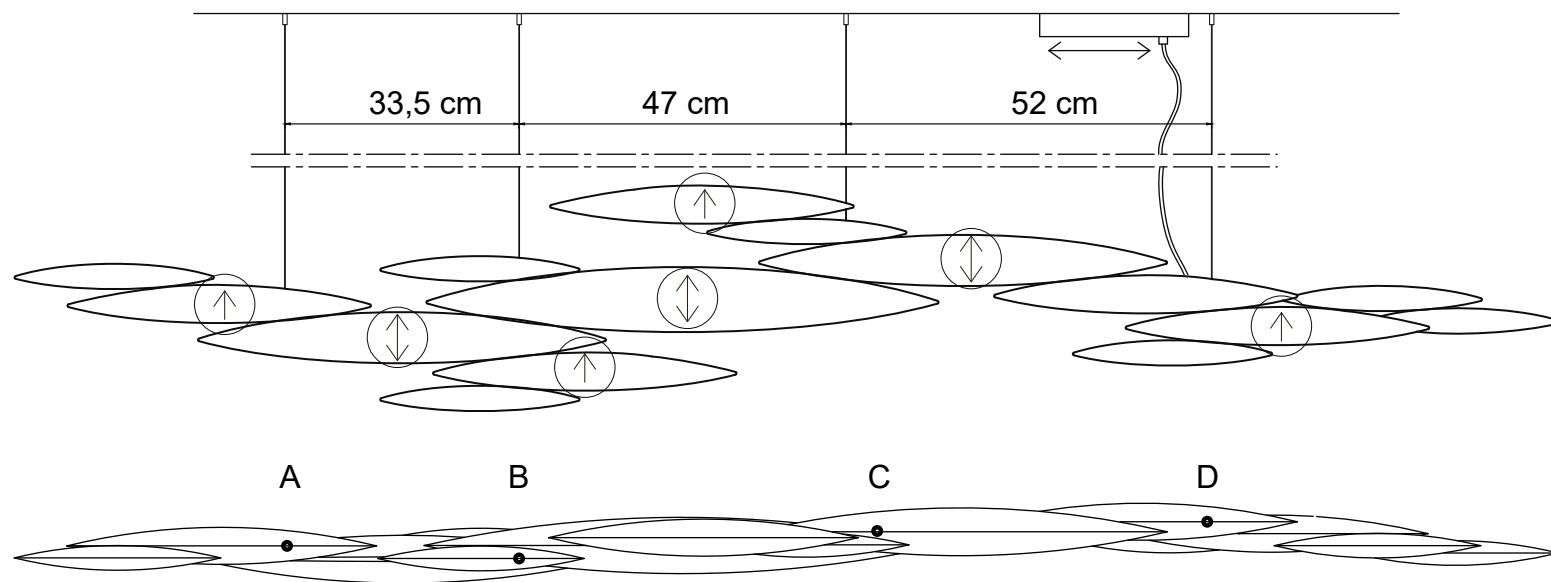
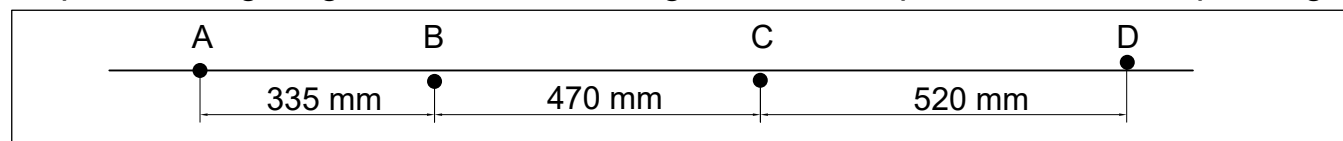

TERZANI
LA LUCE PENSATA

I LUCCI ARGENTATI

CODE 0N81S -- FLD
3000K

CODE 0N81S -- FLWD
2700K

220-240V ~ 50/60Hz MAX 45W

700mA 10xMAX 4,5W

integrated LED

Power Factor = 0.99
Supply current = 0.192 A @ 230V

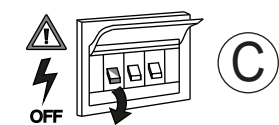
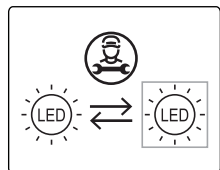
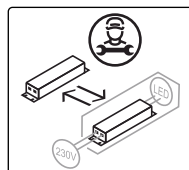

x3

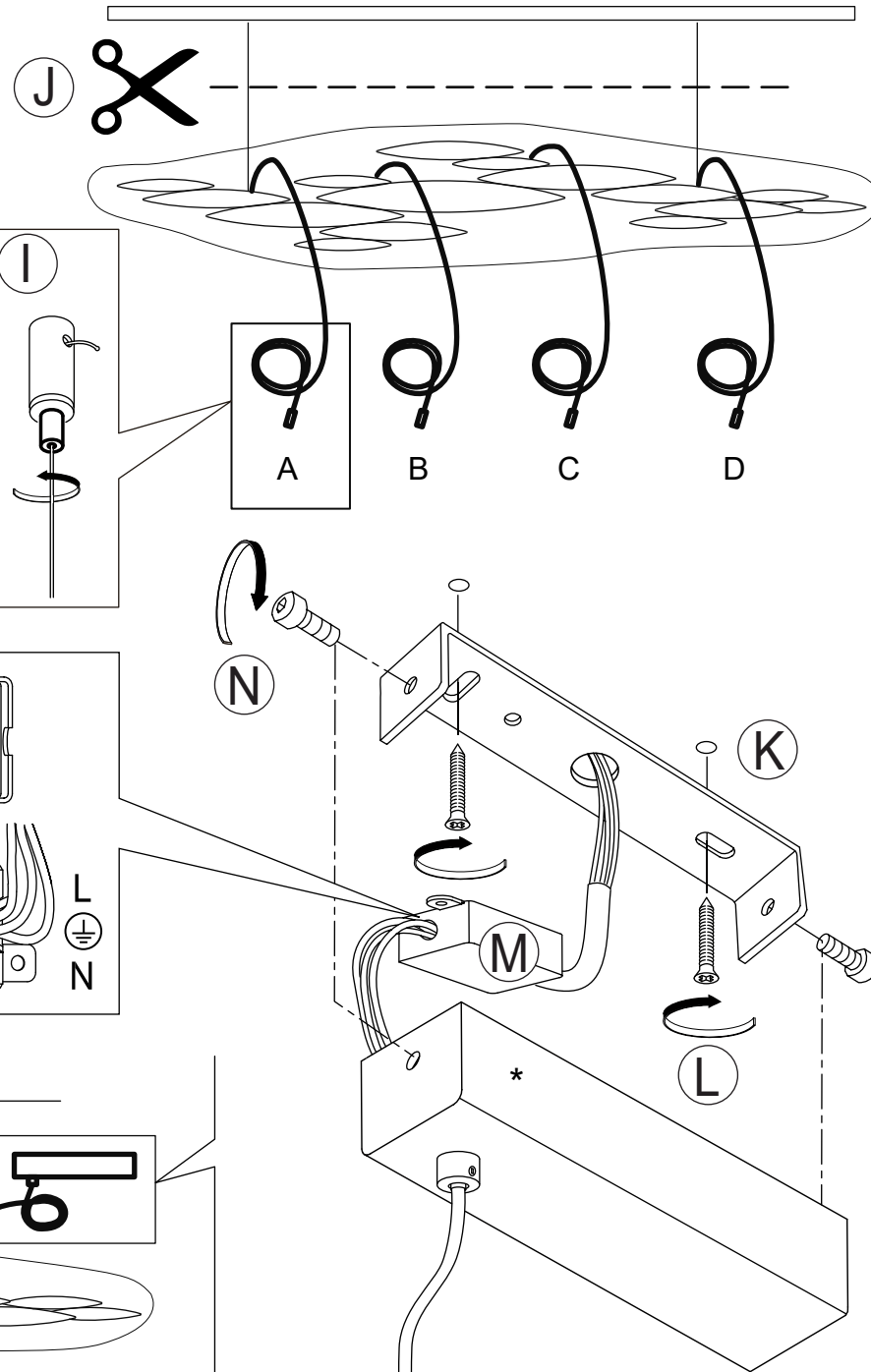
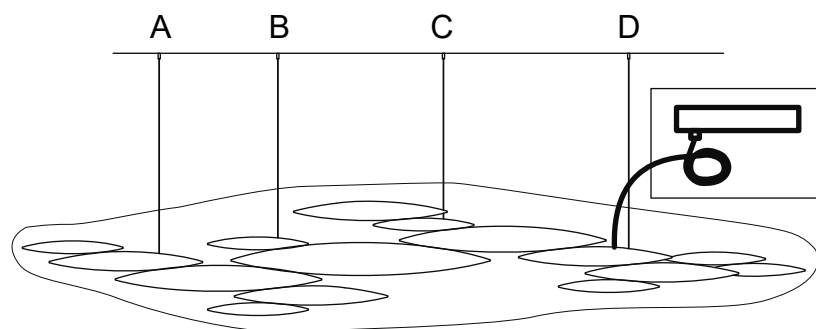
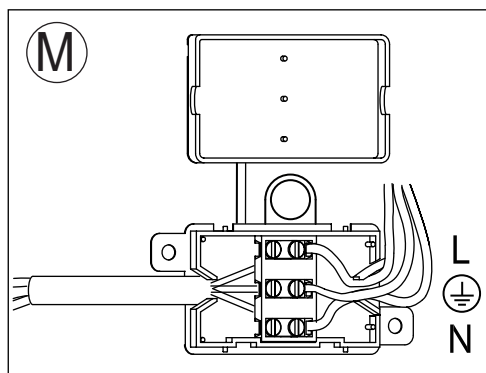
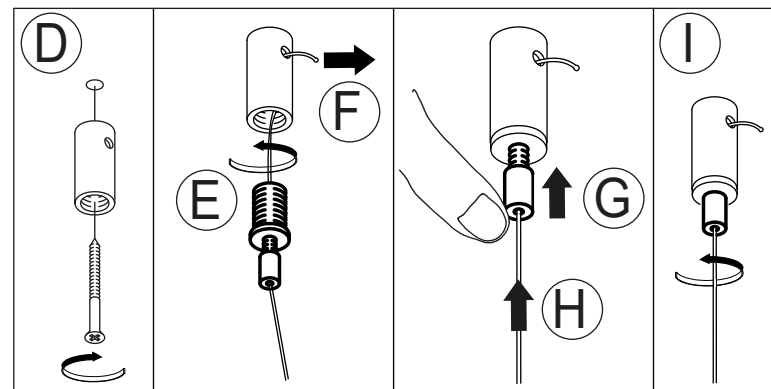

TERZANI
LA LUCE PENSATA

I LUCCI ARGENTATI

CODE 0N81S -- FLD
3000K

CODE 0N81S -- FLWD
2700K

220-240V ~ 50/60Hz MAX 45W

700mA 10xMAX 4,5W

integrated LED

Power Factor = 0.99
Supply current = 0.192 A @ 230V

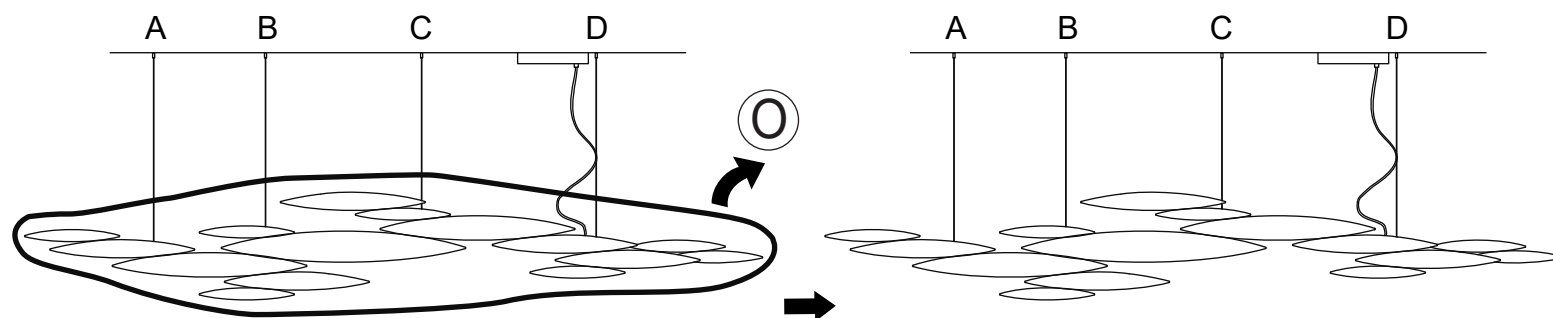
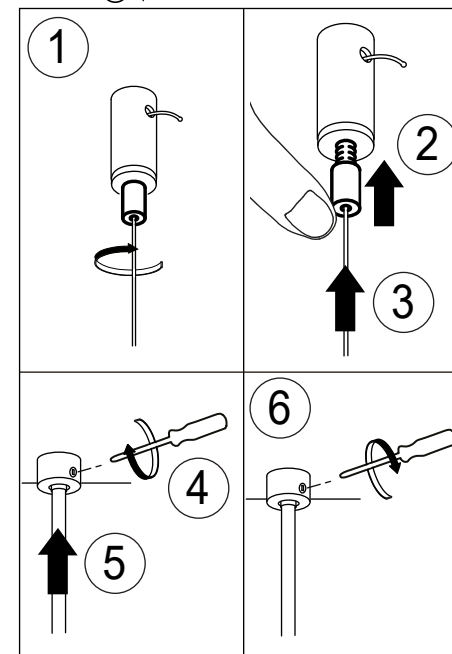
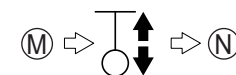
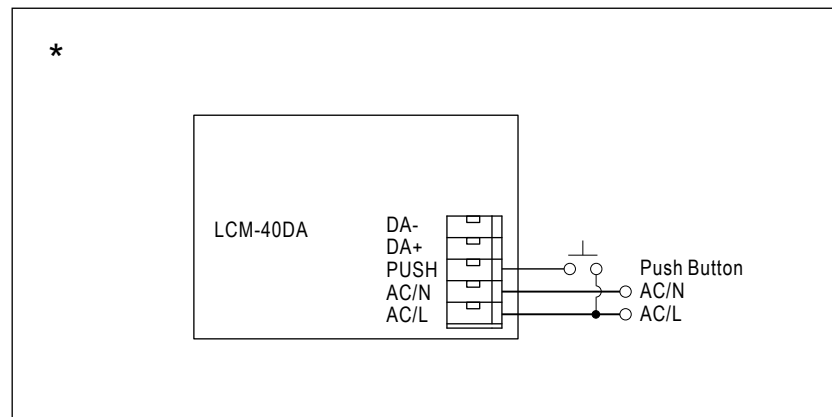
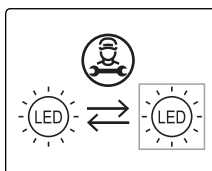
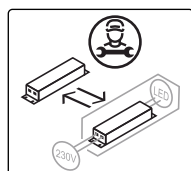

CLEANING INSTRUCTIONS

YES

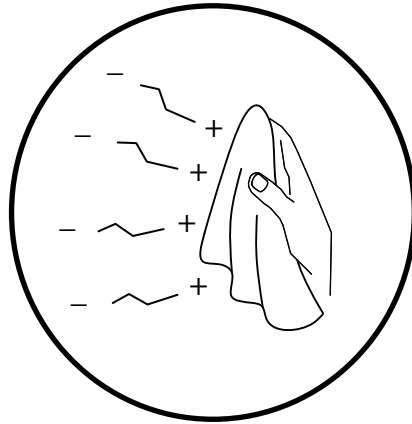

IT Usare panno elettrostatico asciutto

UK Use dry electrostatic cloth

FR Utiliser un chiffon électrostatique sec

DE Verwenden sie ein trockenes elektrostattuch

PY Использовать сухую электростатическую ткань

عربي استخدم قطعة قماش جافة كهرباء

NO

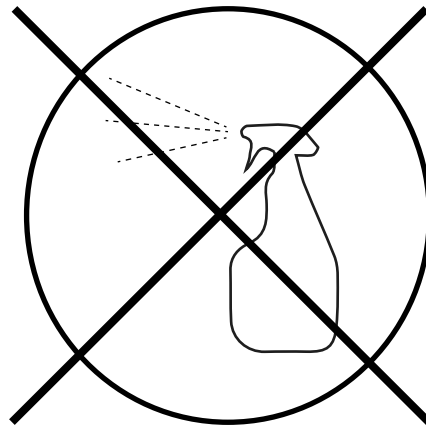

IT Non usare prodotti chimici

UK Do not use chemical products

FR Ne pas utiliser des produits chimiques

DE Verwenden Sie keine Chemikalien

PY Нельзя использовать химикаты

عربي لا تستخدم المنتجات الكيماوية



IT Conservare questa istruzione per la manutenzione | **UK** Keep these instructions for maintenance

FR Garder ces instructions pour l'entretien | **DE** Dies Wartungsanleitung ist aufzubewahren

PY Сохраните эту инструкцию по эксплуатации | عربي احتفظ بهذه الإرشادات للصيانة